

# Congratulations on buying the Mi3.5



This car is factory assembled to save you time, and ensure that all the parts fit together correctly. However please refer to the setup sheets at the back of the manual, as small adjustments may be required to setup the car for your individual driving style, and the type of track you race on.

This manual covers the Pro spec and the Race spec versions of the Mi3.5. The box end label will tell you which version you have.

Because this car is assembled, most of the manual will only be required for maintenance, Page 28 onwards deals with finishing the car assembly.

Additional items required.

2 Channel radio Control. Transmitter, Receiver and Steering servo.

Electronic Speed Controller.

Battery Pack. 7.2v NiMH, 6.0v NiMH or 7.4v Lipo.

Battery charger.

Motor and pinion.

Bodyshell and paint.

Wheels and tyres.

AA Batteries for transmitter.

Tools.

See back page of manual for some available option parts.

## Safety Notes

- This product is not suitable for children under 14 years of age unless supervised by an adult.
- Select an area for assembly that is away from the reach of small children. The parts are small and can be swallowed by children causing choking and possible internal injuries.
- Shock fluids, grease and adhesives should be kept out of childrens reach. They may be toxic and were not intended for human consumption.
- Exercise care when using hand tools, sharp instruments or power tools during assembly.
- Read the instructions fully and read all manufacturers warnings and cautions for any additional items that may be used for assembly purposes.
- Always drive your car safely and away from public roads, and be aware of any people or animals near you. **MODEL CARS CAN BE DANGEROUS.**
- Learn to use your power with respect, very few surfaces can cope with full power. If you use full power everywhere you **WILL** break things.
- Always ensure that the transmitter batteries are fully charged.
- Always ensure that all nuts and screws are tight and the gear mesh is correct.
- Superglue the tyres to the wheels as they may come off at high speeds.
- This product is not a toy, it is a hobby product capable of high performance, but it will require regular maintenance. Learn to drive the car slowly at first, away from solid objects.
- The carbon fibre chassis conducts electricity, beware of short circuiting the batteries.

# IMPORTANT

Please read the entire manual before starting the assembly of your new MI-3.5

Before you start Building your car checkout the setup Sheets at the end of the manual or online at [www.racing-cars.com](http://www.racing-cars.com) to ensure the car is built to suit your driving style and track conditions



## Rear Diff Assembly

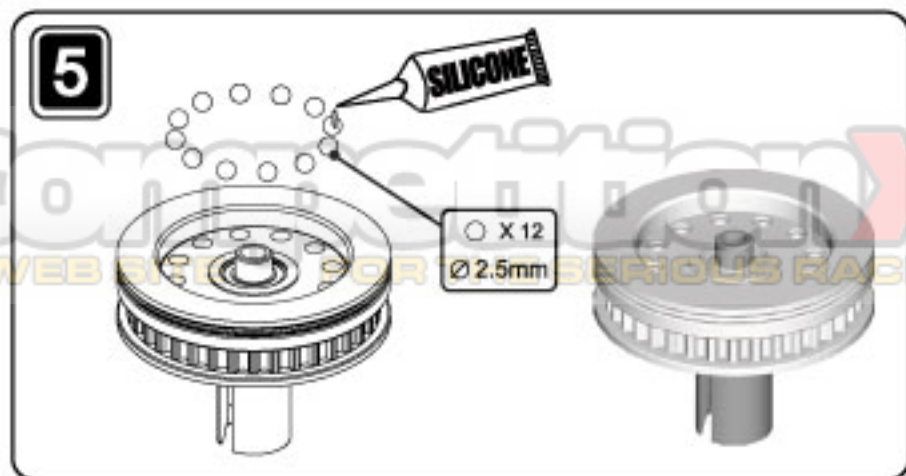
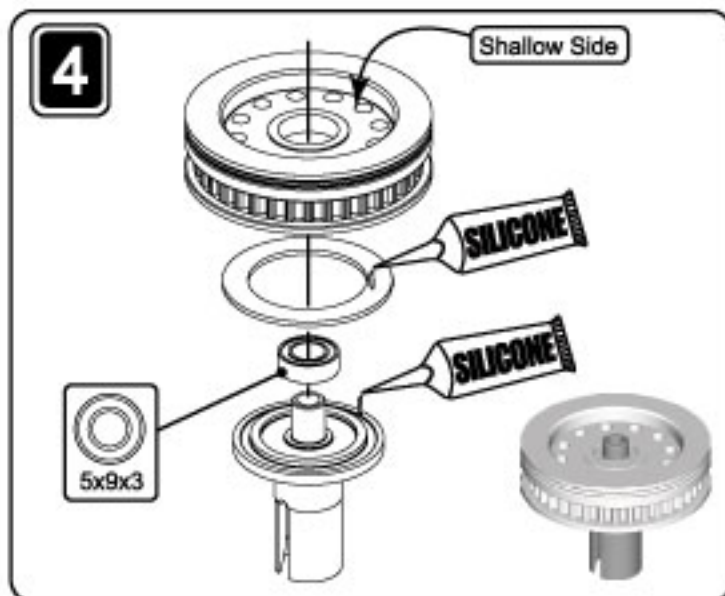
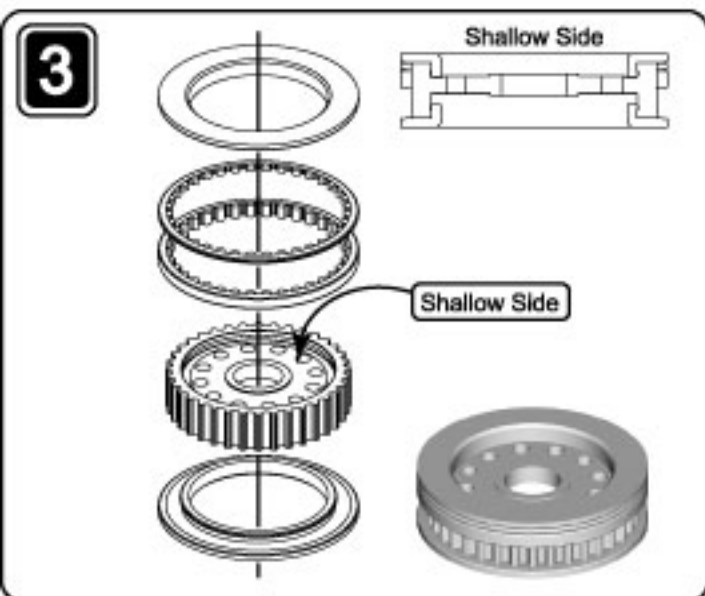
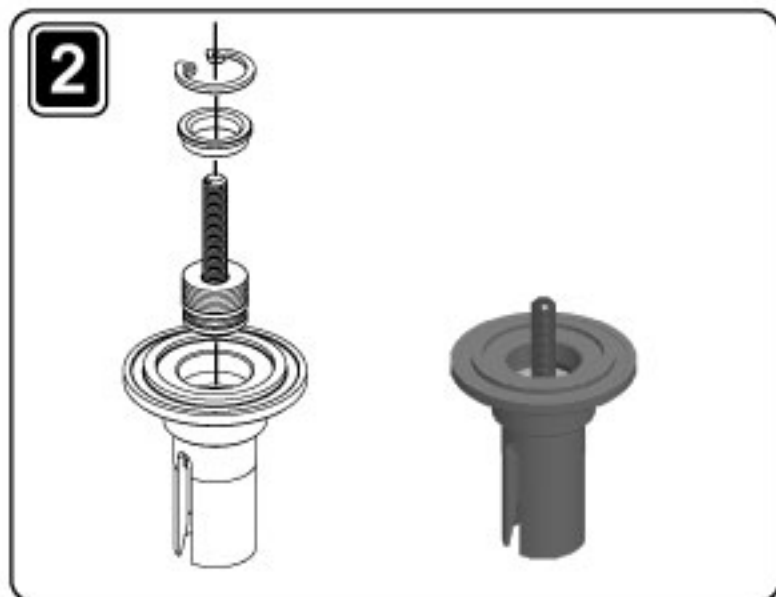
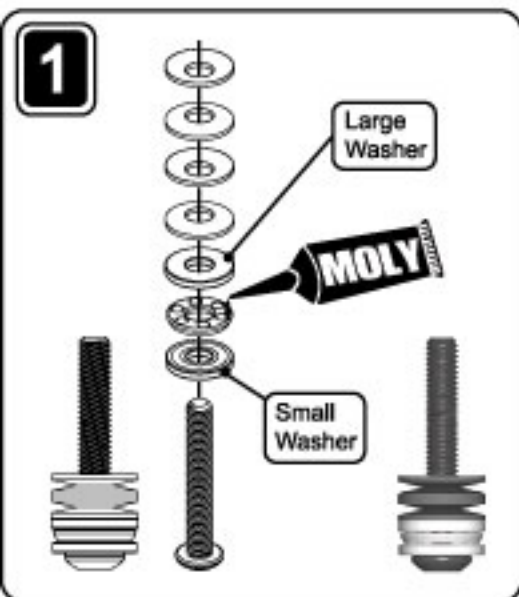

6

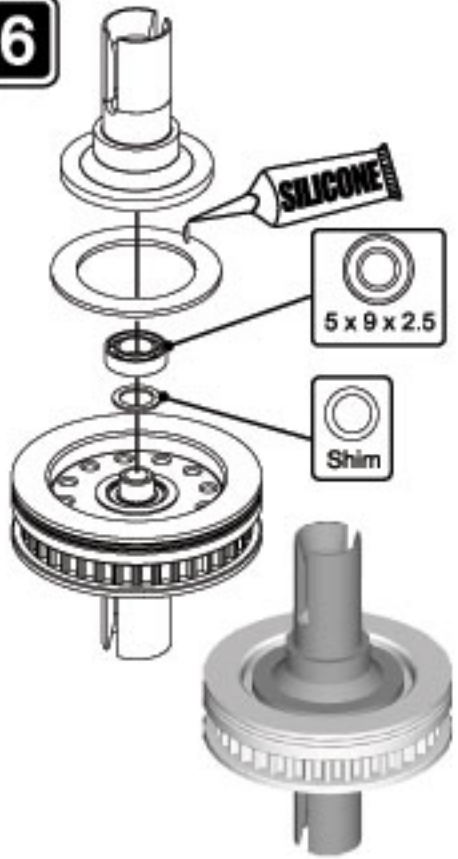

7



Diff Assembly cont..

8

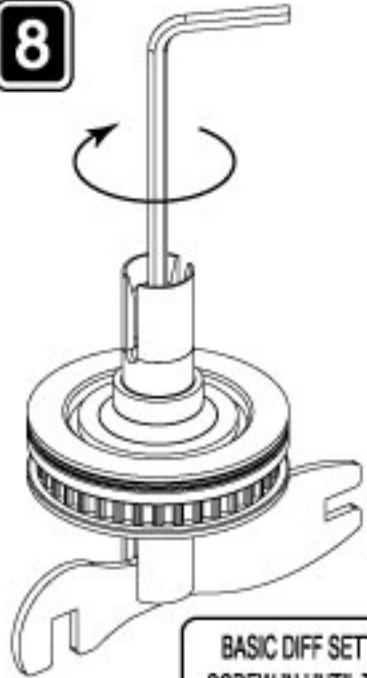

BASIC DIFF SETTING  
SCREW IN UNTIL TIGHT  
(ALL DISC SPRINGS FLAT)  
THEN UNDO 270°  
(3/4 TURN)

9

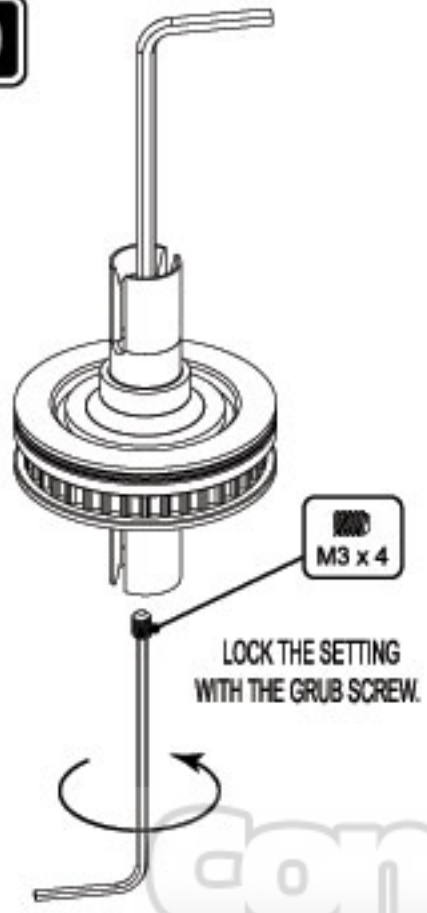

10



Final Assembly

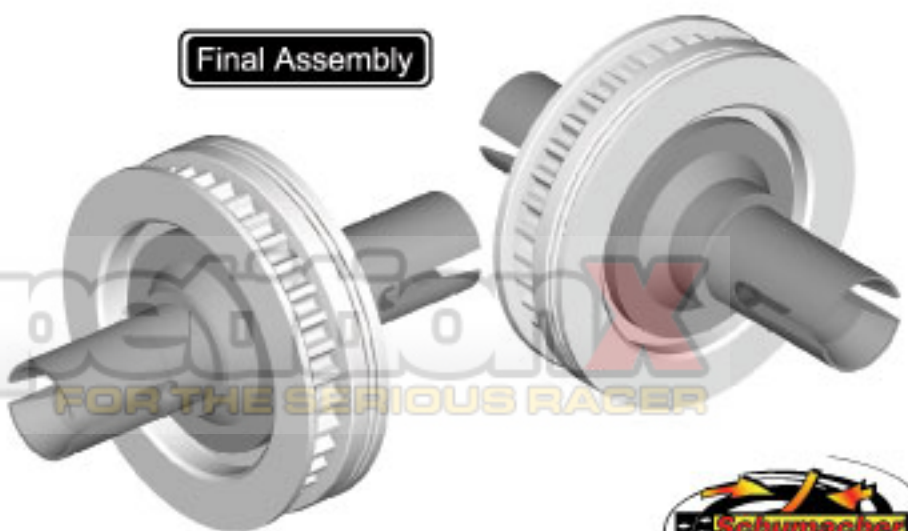



# Spool Assembly

1

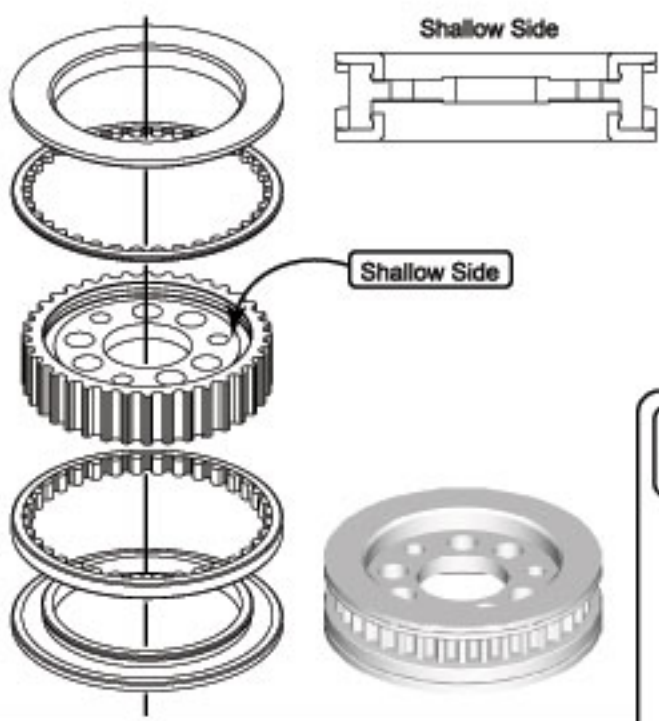

2

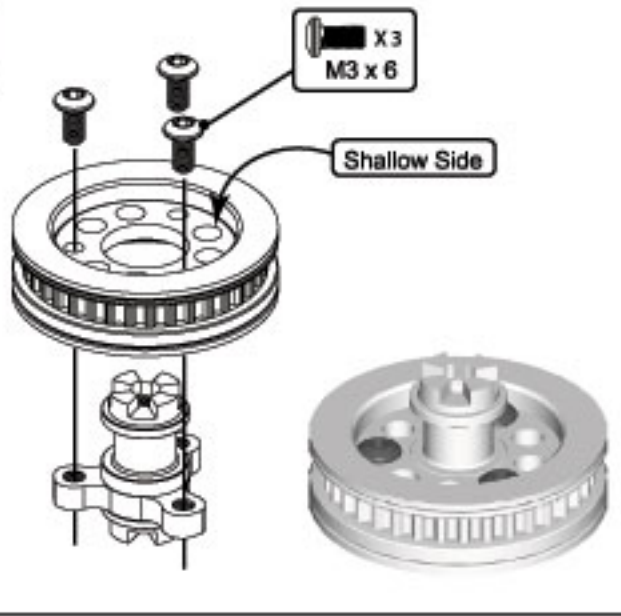

3

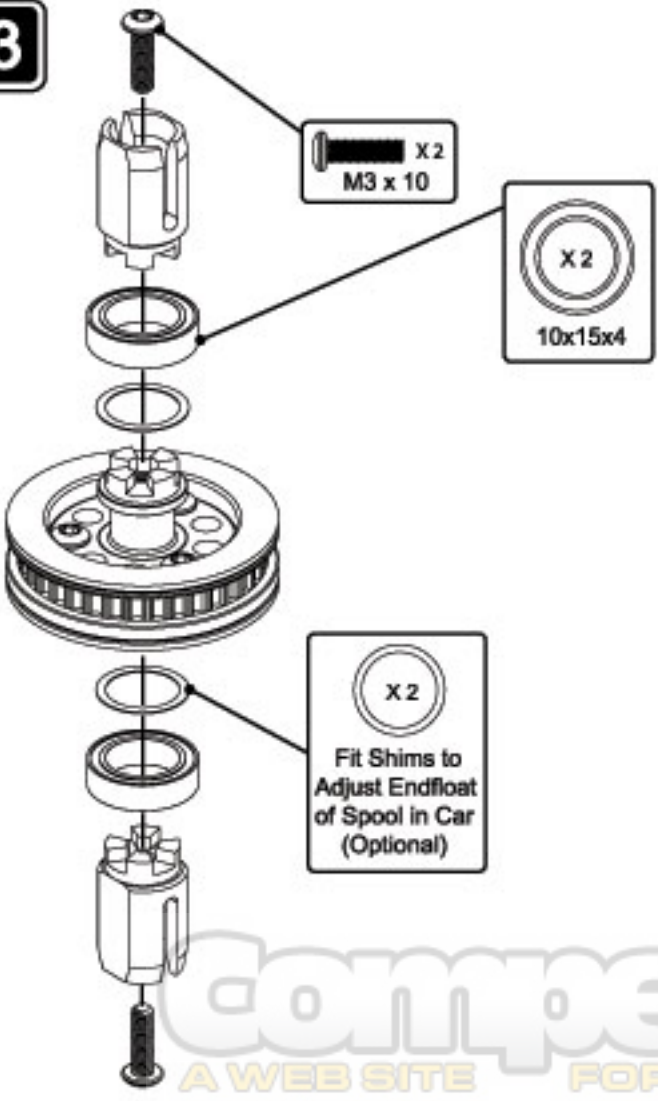

## Final Assembly

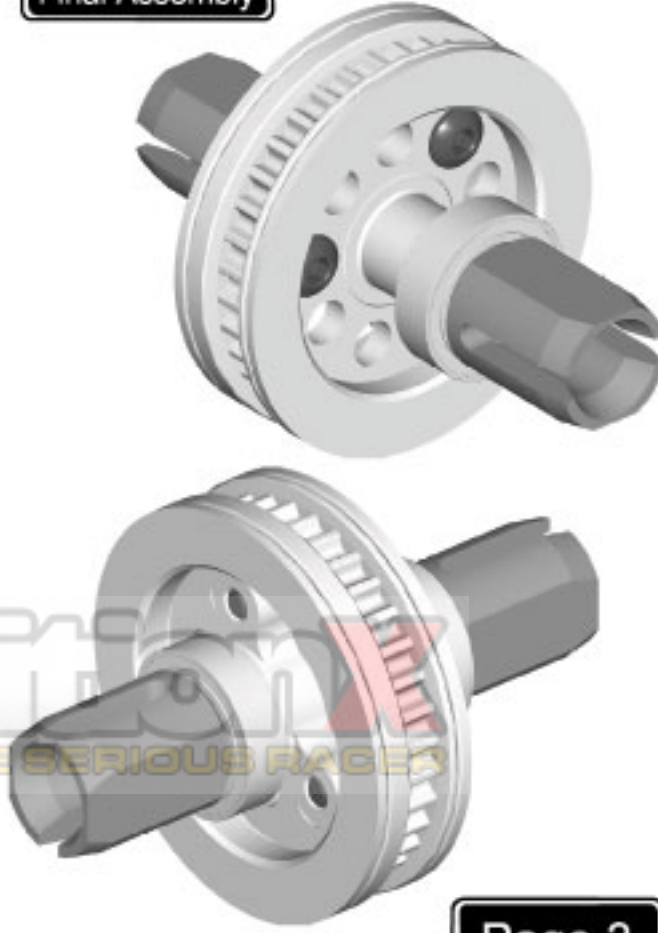

Competitive  
A WEB SITE FOR THE SERIOUS RACER





## Shock Assembly Pro-Spec

1

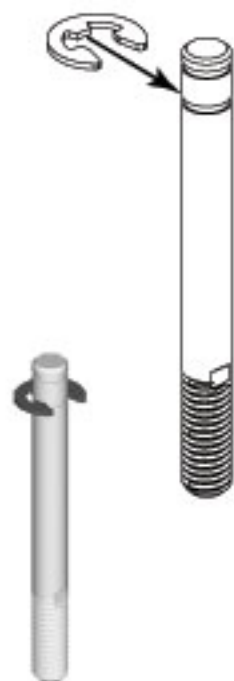

2



3



4

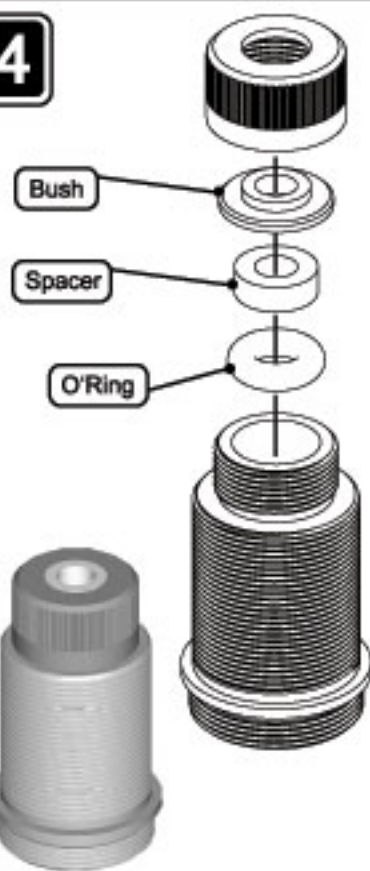

5



6

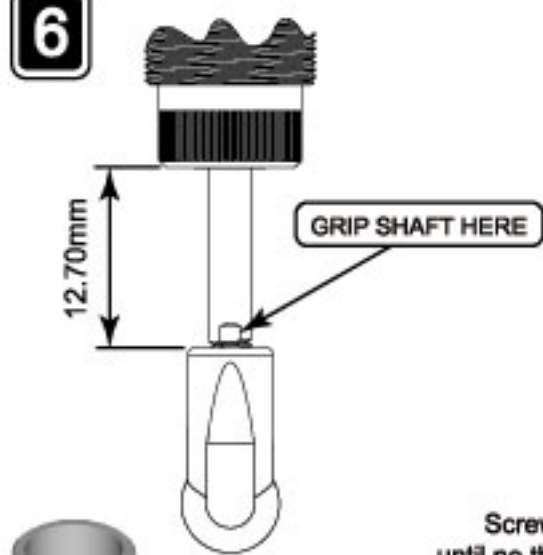

Screw on to shaft  
until no thread is showing



Grip the piston rod very close to the thread.  
BE CAREFUL NOT TO DAMAGE  
THE POLISHED SHOCK ROD.

COMPETITION X  
A WEB SITE FOR THE RACER



**6**

Fill Slowly With Shock Oil until Domed. Move Piston Up and Down Slowly and Allow all Air Bubbles to Rise and disappear.

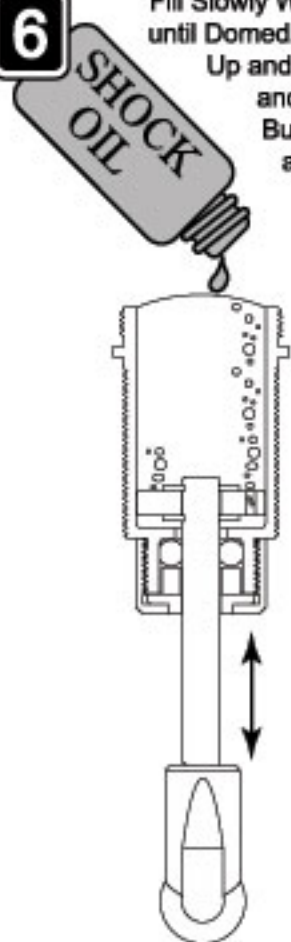
**7**

Shock Assembly cont..  
Pro-Spec

**9**

Lubricate the Threads with a SMALL amount of shock oil

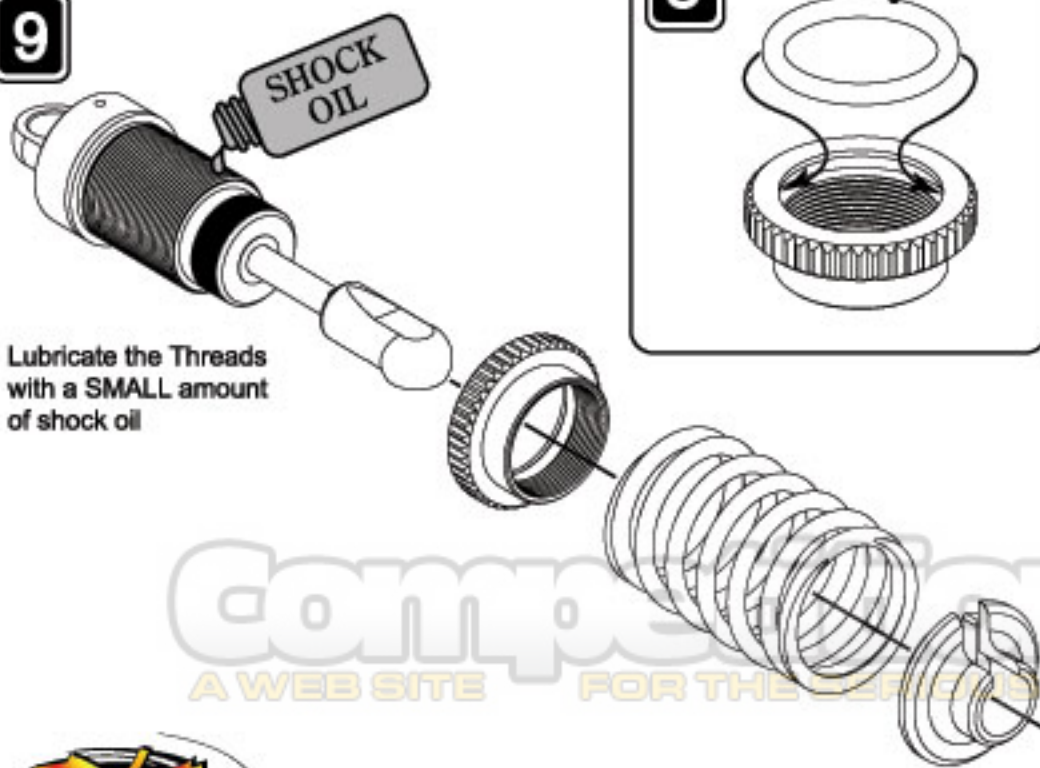
**8**

O'Ring



Final Assembly

61.30mm (All 4 Shocks the Same)



## Shock Assembly Race-Spec

1



2



3



4



5

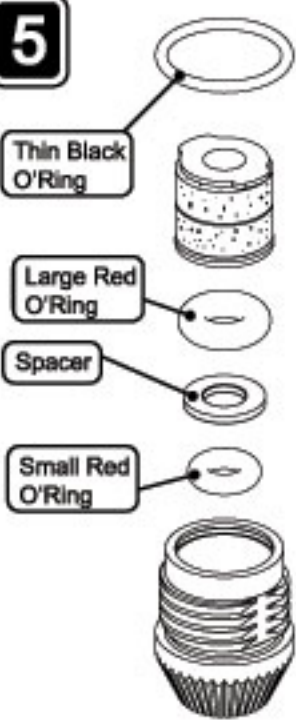

6

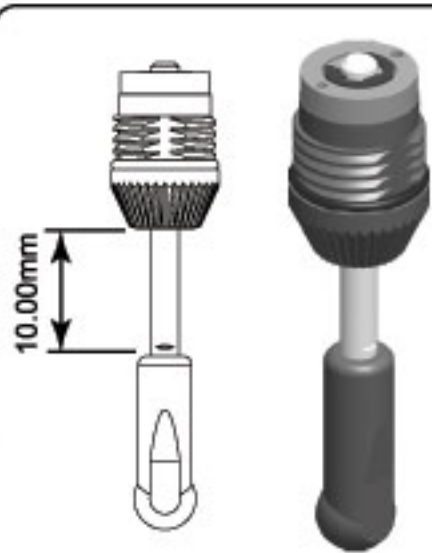

7

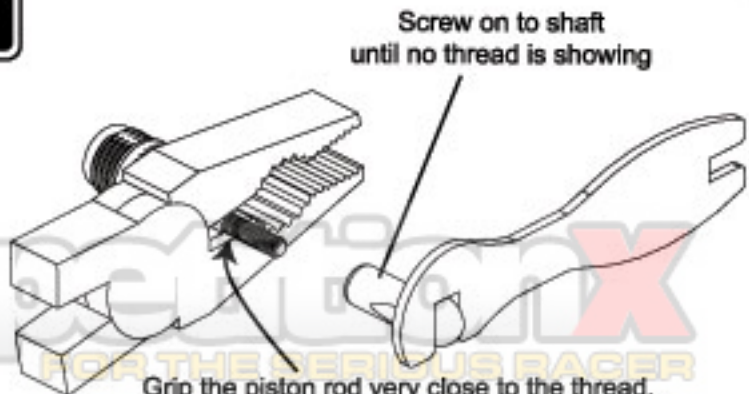

6 Fill Slowly With Shock Oil to the bottom of the thread.

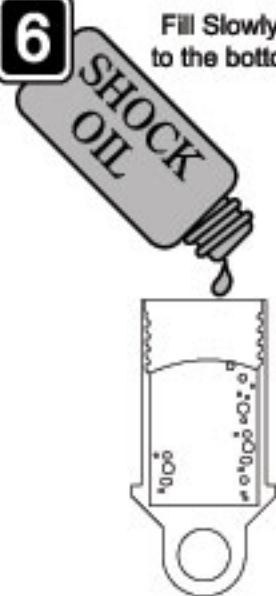

## Shock Assembly cont.. Race-Spec



Position assembly as shown and carefully screw into the shock body. (some oil will spill from the body, clean with tissue)

9

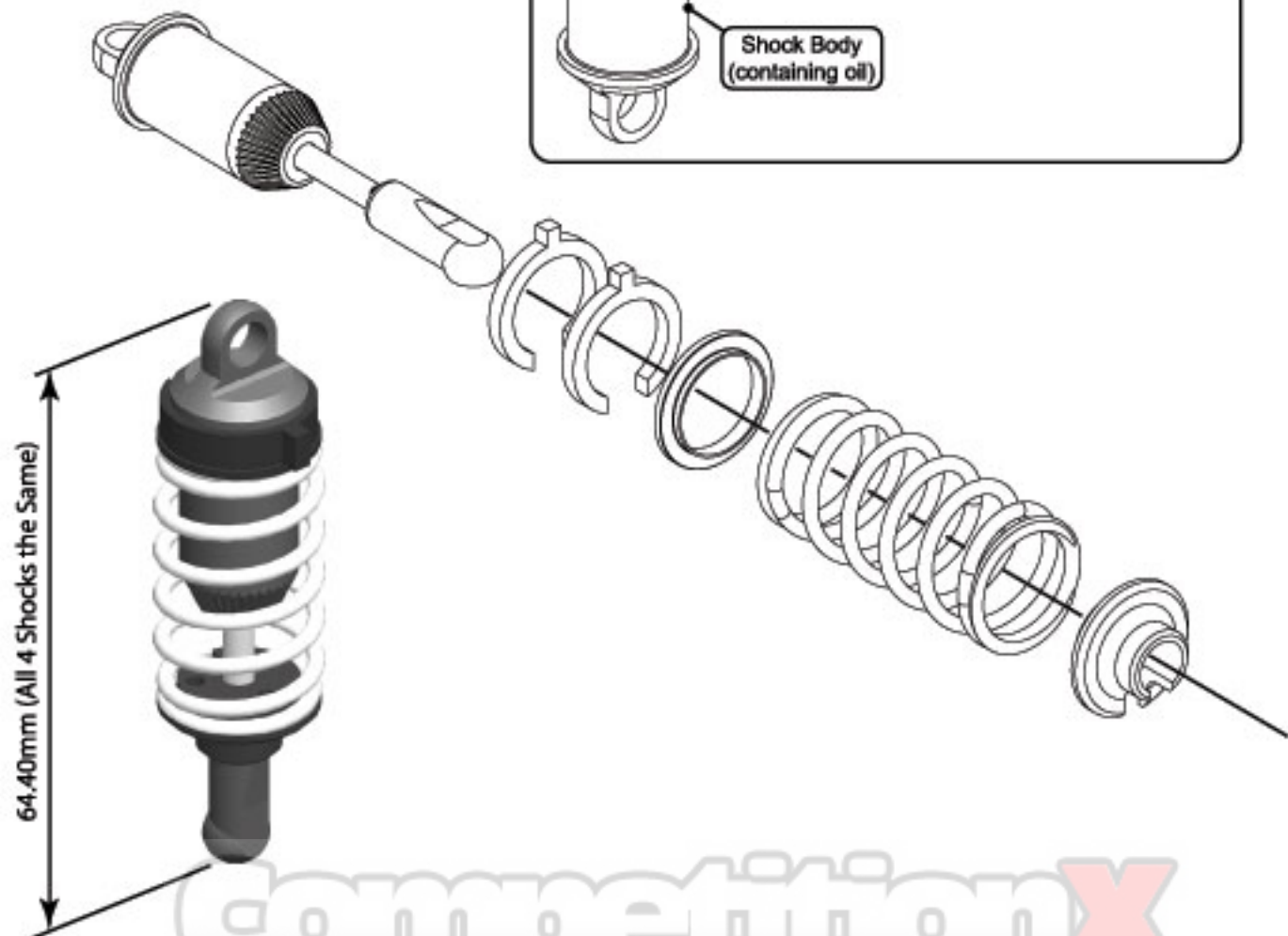

competitionX

A WEB SITE FOR THE SERIOUS RACER





1



Stage 1

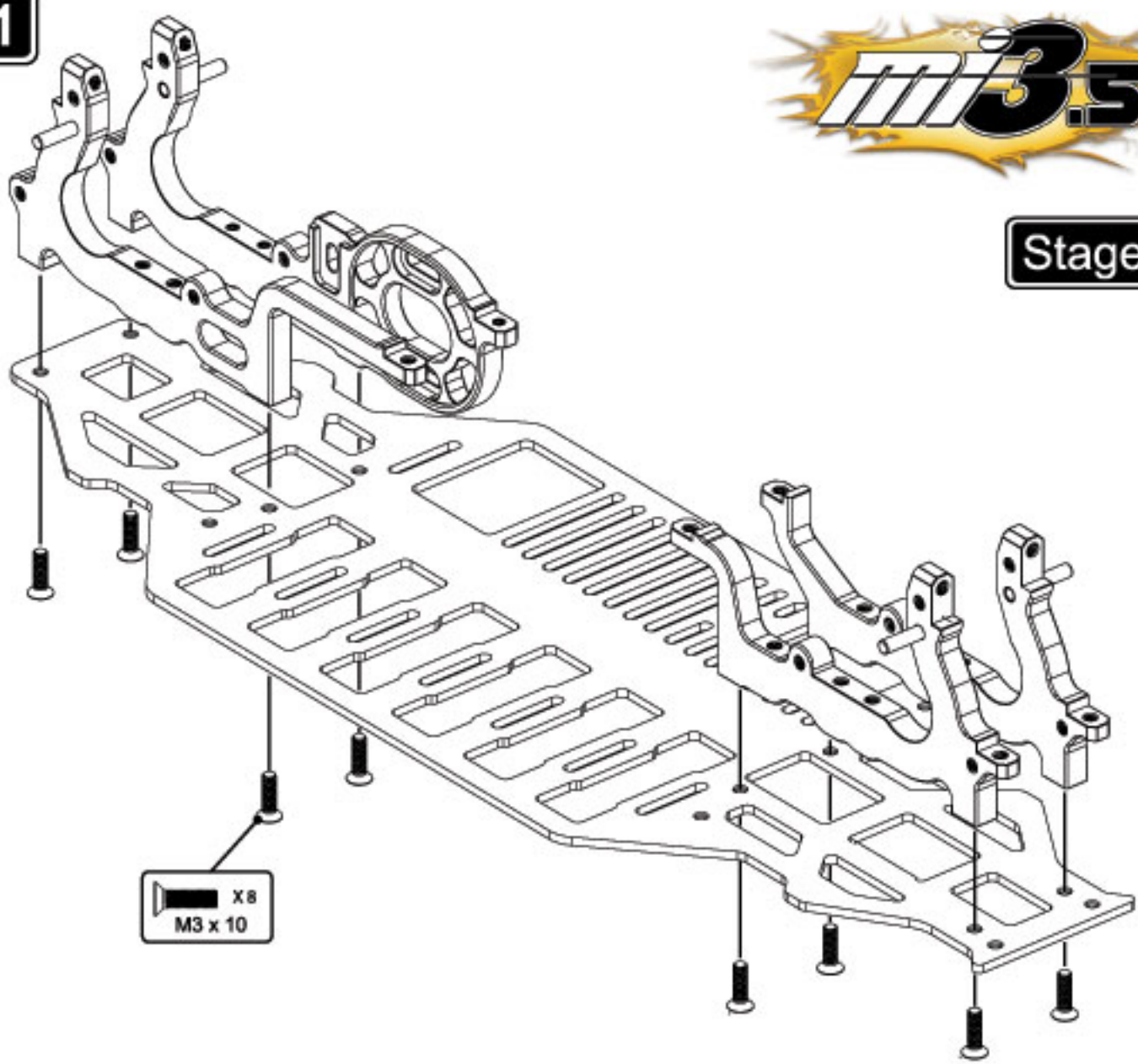

Final Assembly

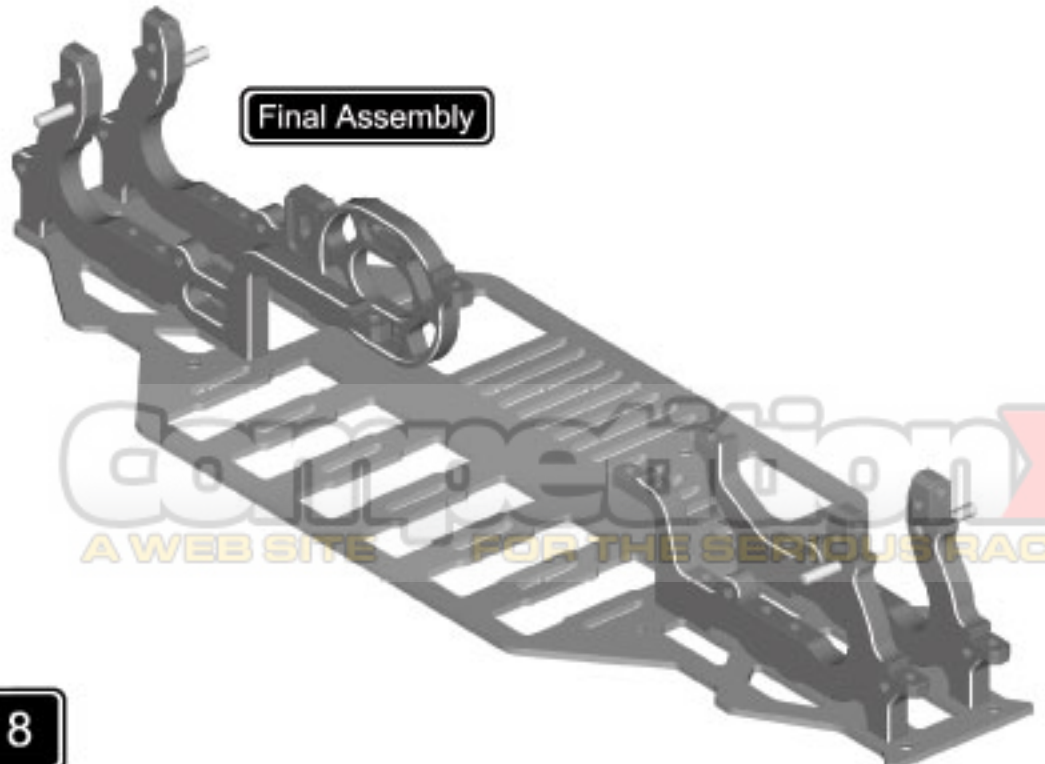

Carfection.com  
A WEB SITE FOR THE SERIOUS RACER



www.racing-cars.com

Page 8

1

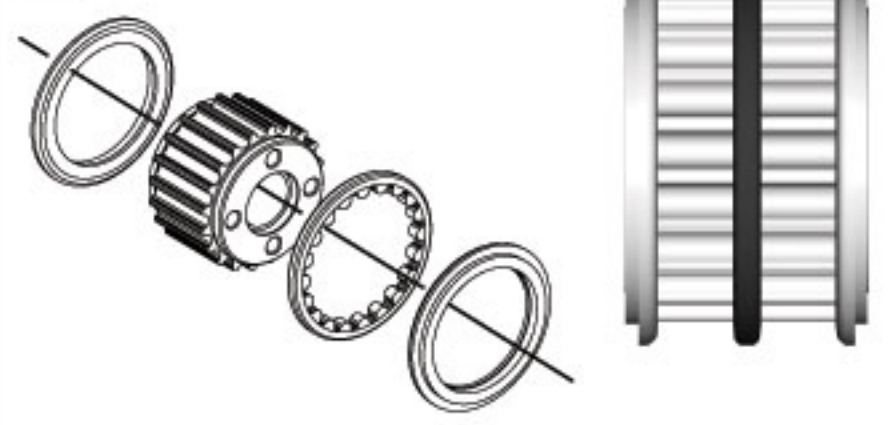

2

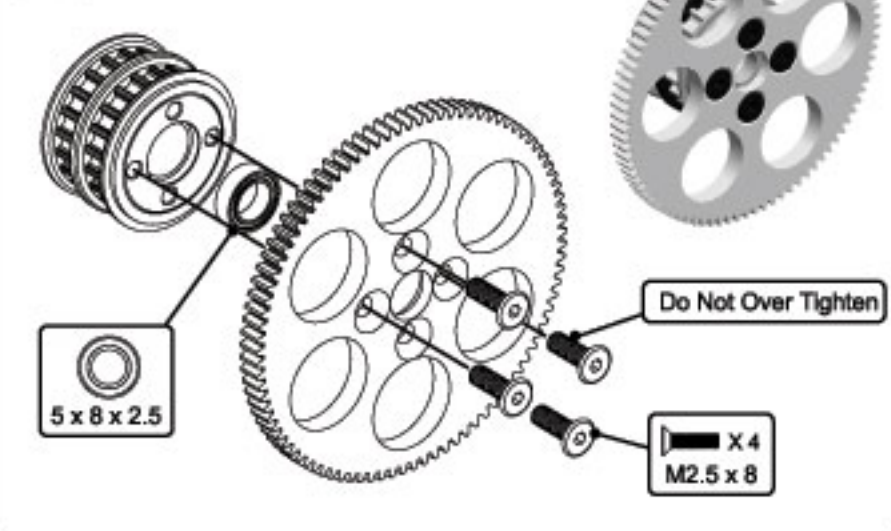

3

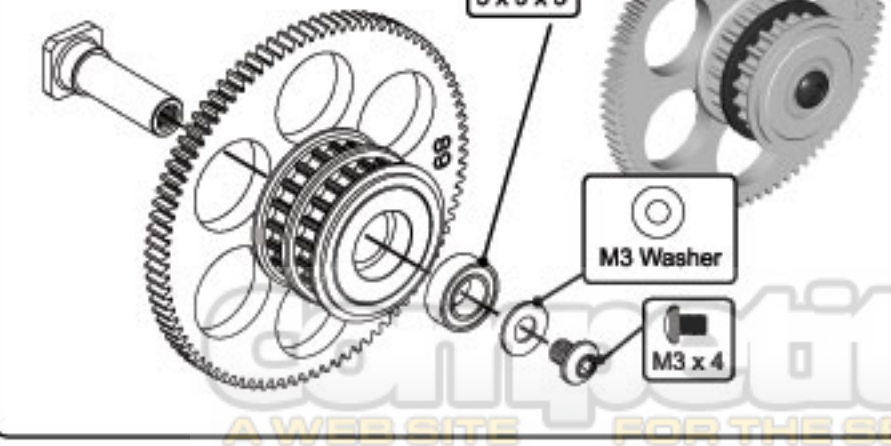

4



Stage 2 cont..

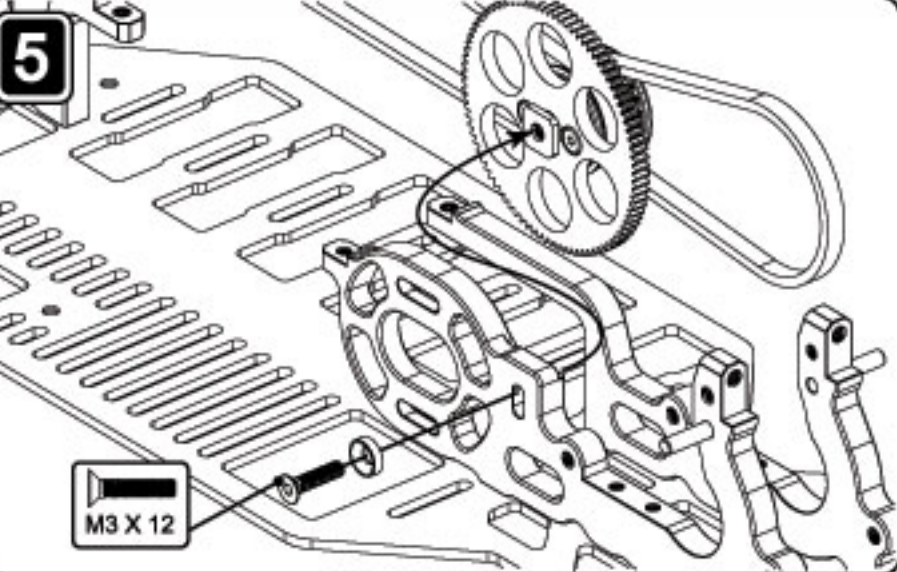
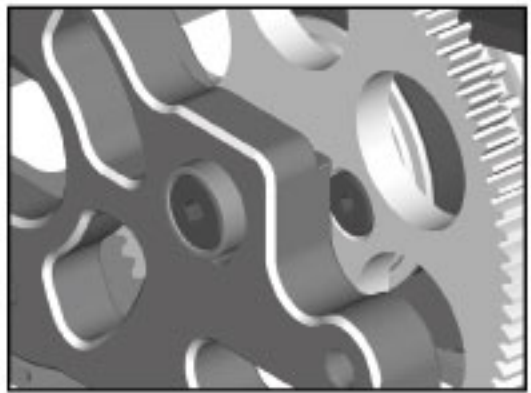

**SPUR GEAR HEIGHT**

The height of the spur gear may be adjusted depending on the size of gear you are using. It should be set so that the gear is just above the bottom of the chassis.

Final Assembly

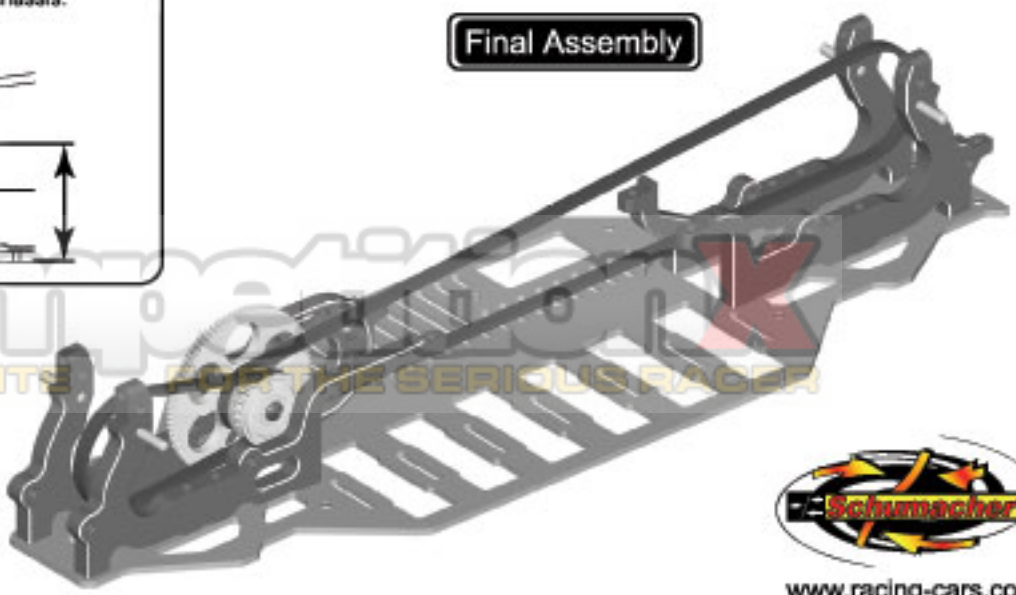

**1** Fit Shims to Adjust Endfloat of Diff in Car (Optional) **X 2**

**X 2**  
10 x 15 x 4

High Low

Set the Spool and Diff the Same

The Indents Must Face Outwards

**Stage 3**

**2**

5.50 mm

5.50mm

Nitrile X4 Damper

**3** Nitrile Damper

Optional

**4**

M3 x 20 X 2

REAR

MAKE SURE BOTH CAMS ARE SET THE SAME

**5**

The Indents Must Face Outwards

**6**

M3 x 20 X 2

FRONT

MAKE SURE BOTH CAMS ARE SET THE SAME

**Final Assembly**

A WEB SITE FOR THE SERIOUS RACER

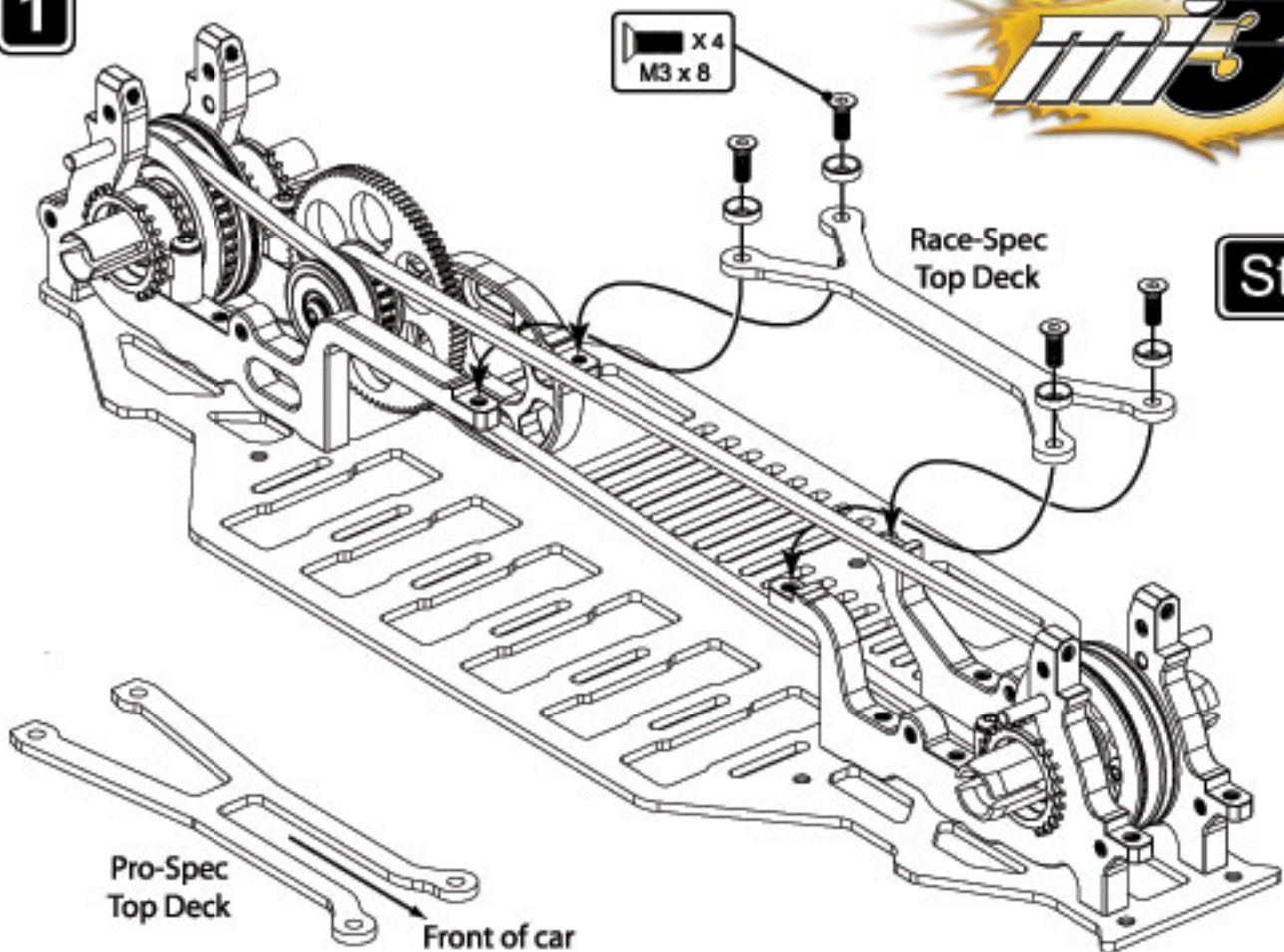
**1****Stage 4****BELT TENSION****BELT TENSION**

Rotating the Diff Cam towards the layshaft will decrease the belt tension, and rotating it away will increase the tension.

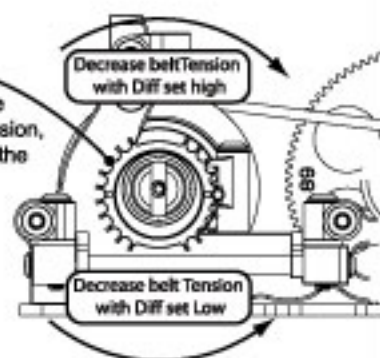
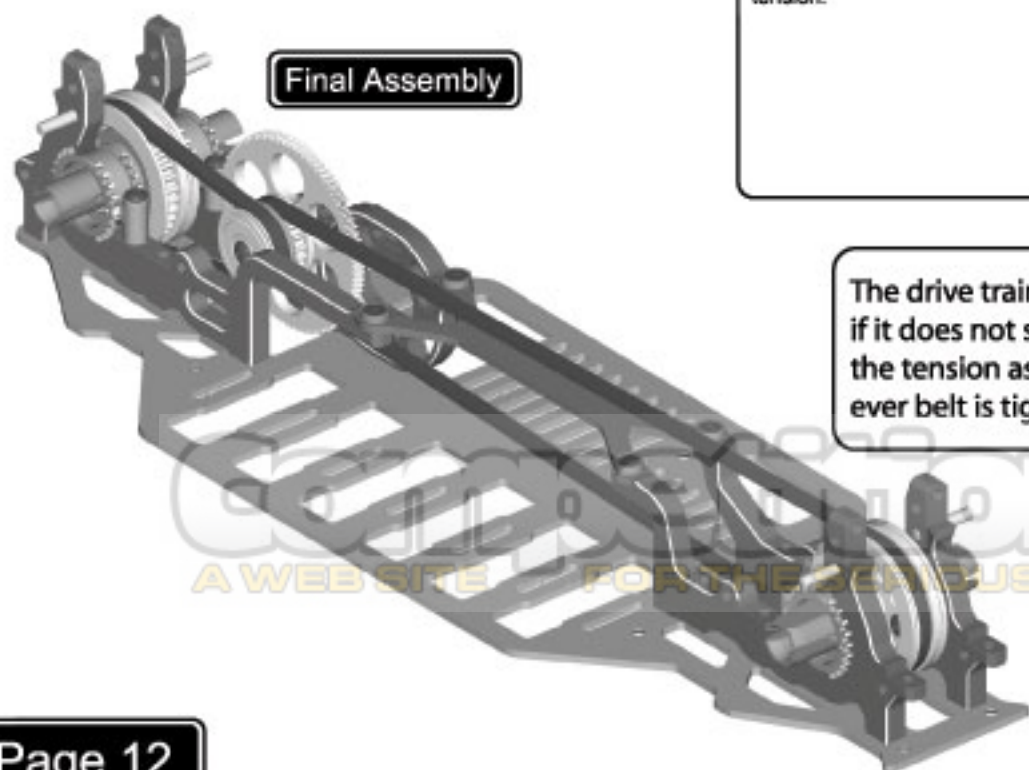
**Final Assembly**

The drive train should now spin freely, if it does not spin freely then decrease the tension as shown above on which ever belt is tight.

A WEB SITE FOR THE SERIOUS RACER



# Rear Suspension Right hand Side

## Stage 5

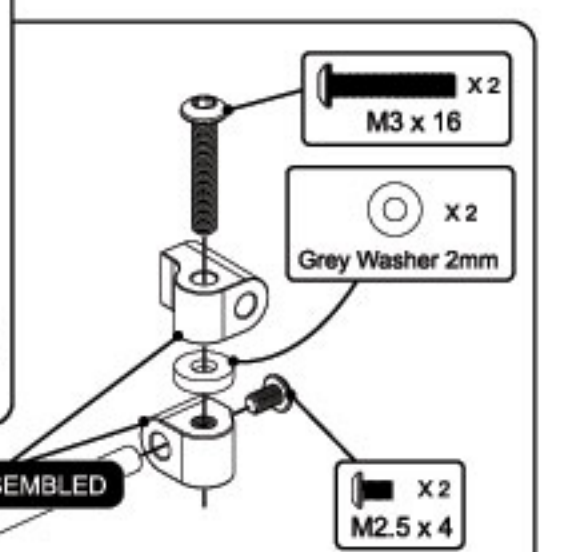
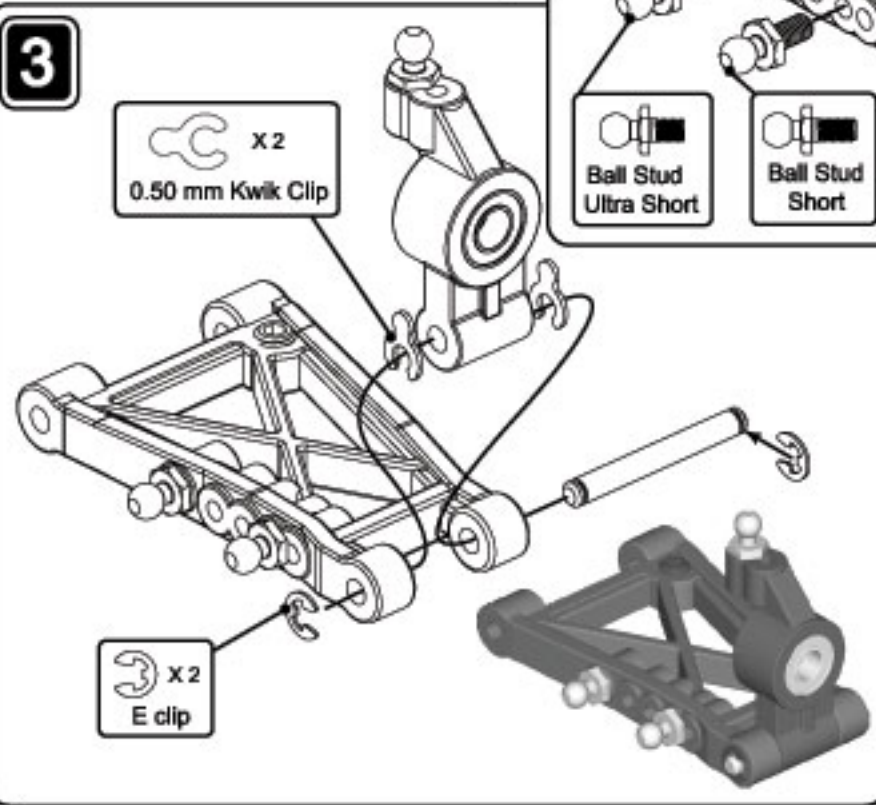
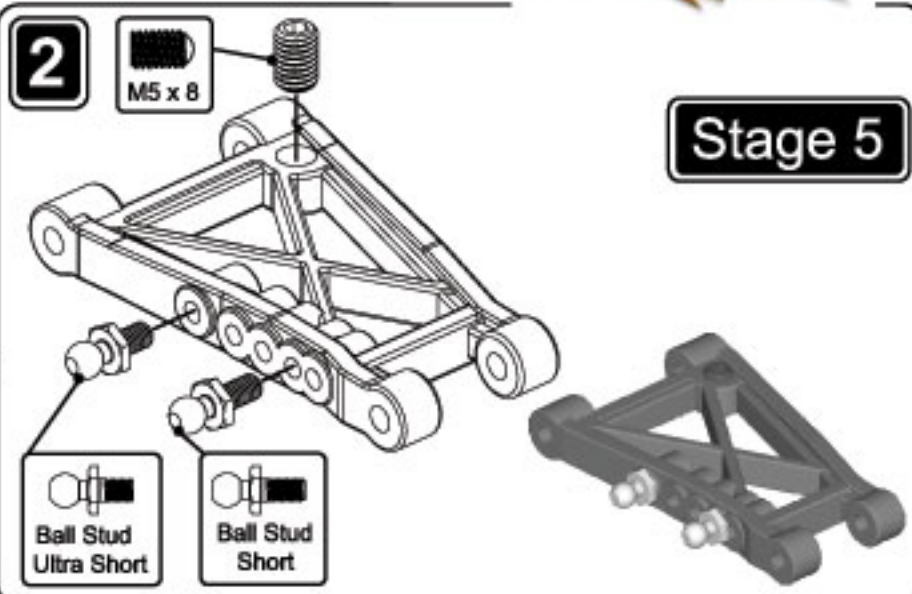
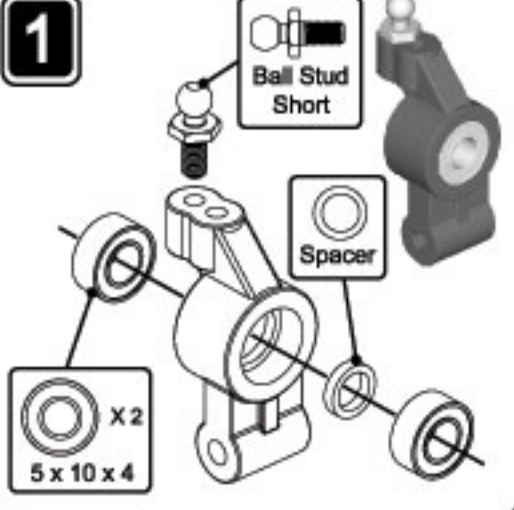

**4** ENSURE THAT THE BLOCKS ARE CORRECTLY ASSEMBLED

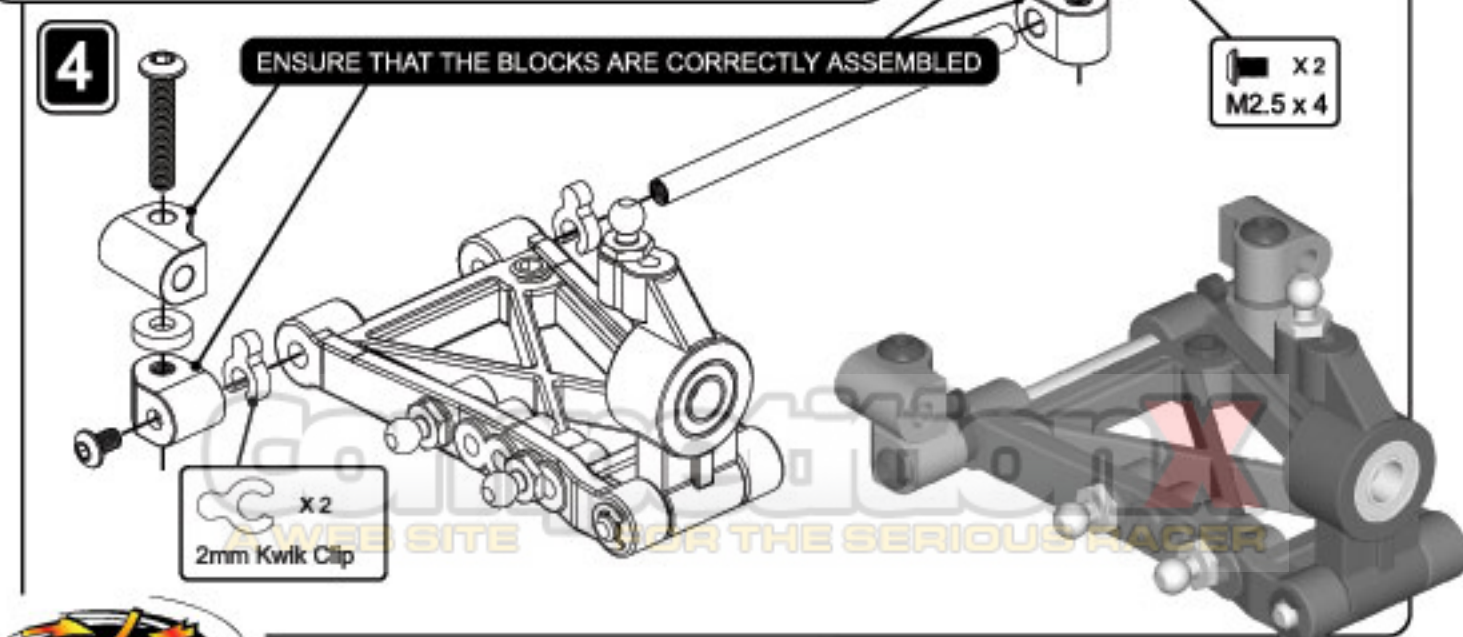



Stage 5 cont..

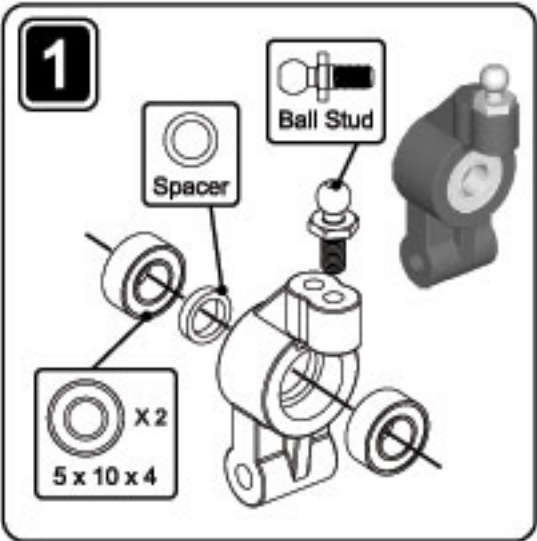
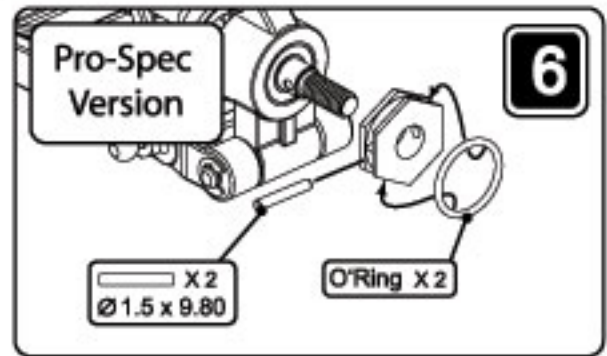
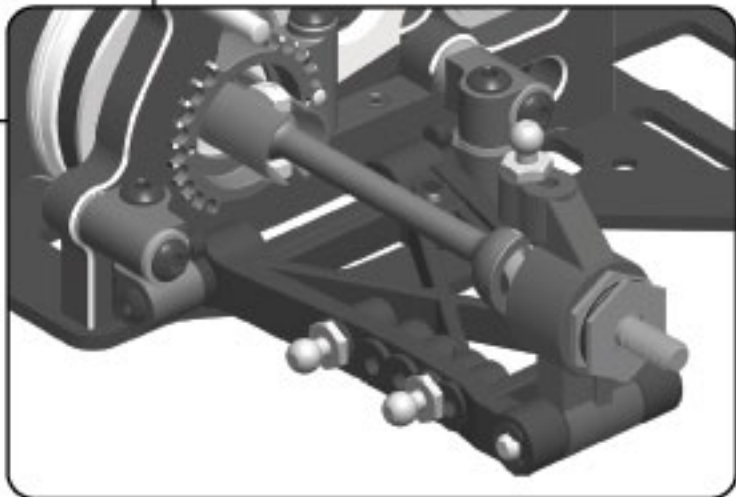
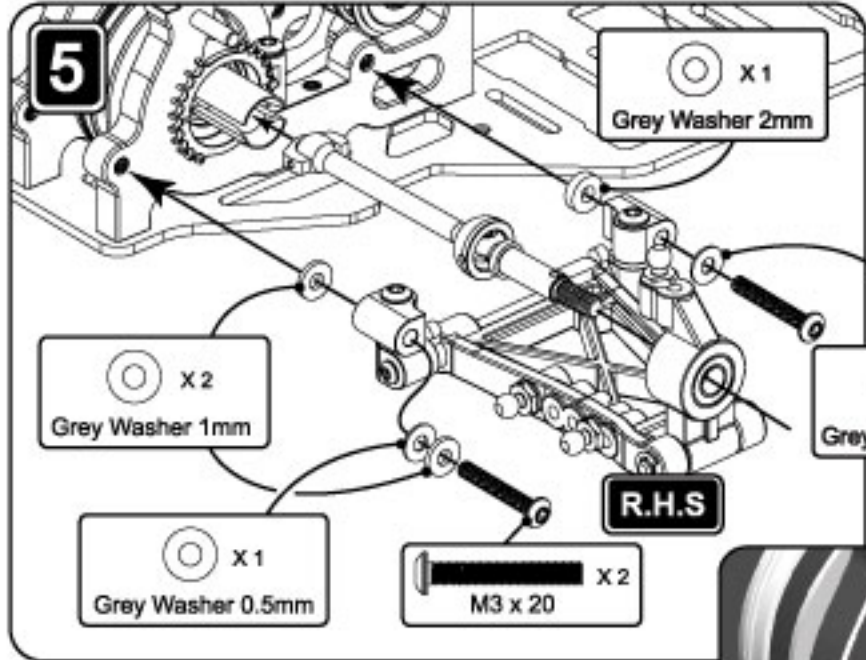

Rear Suspension Left hand Side

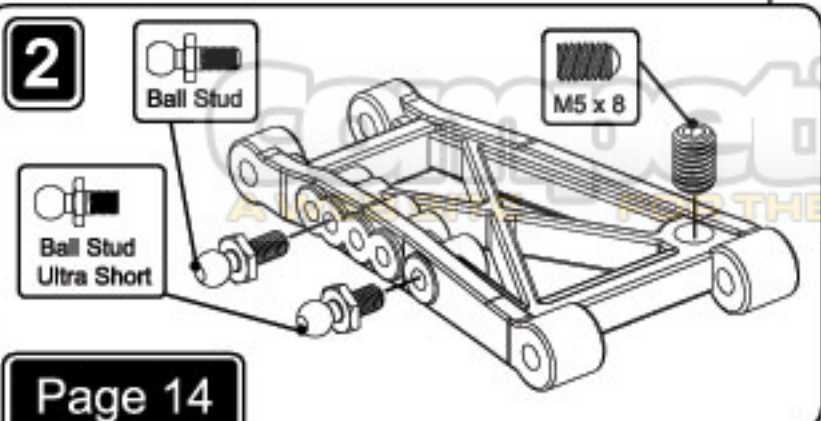
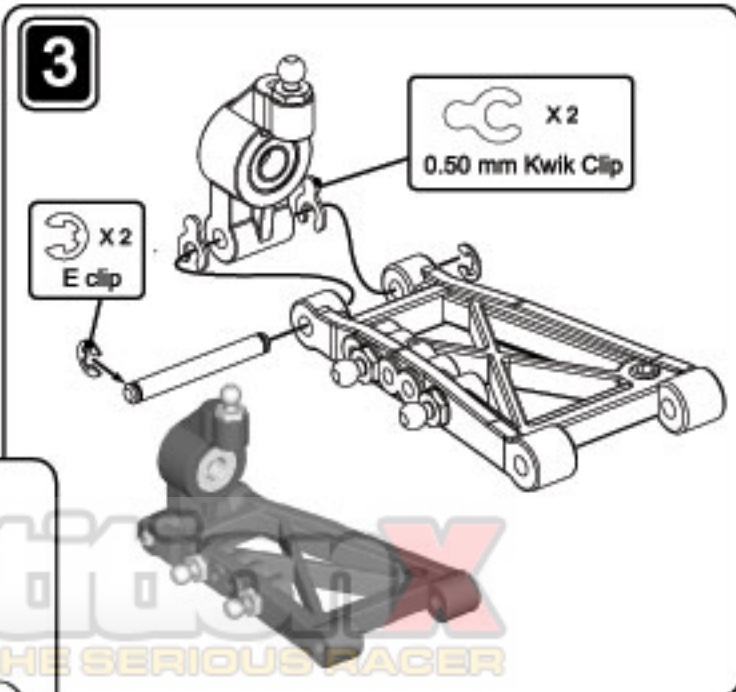

4

ENSURE THAT THE BLOCKS ARE CORRECTLY ASSEMBLED

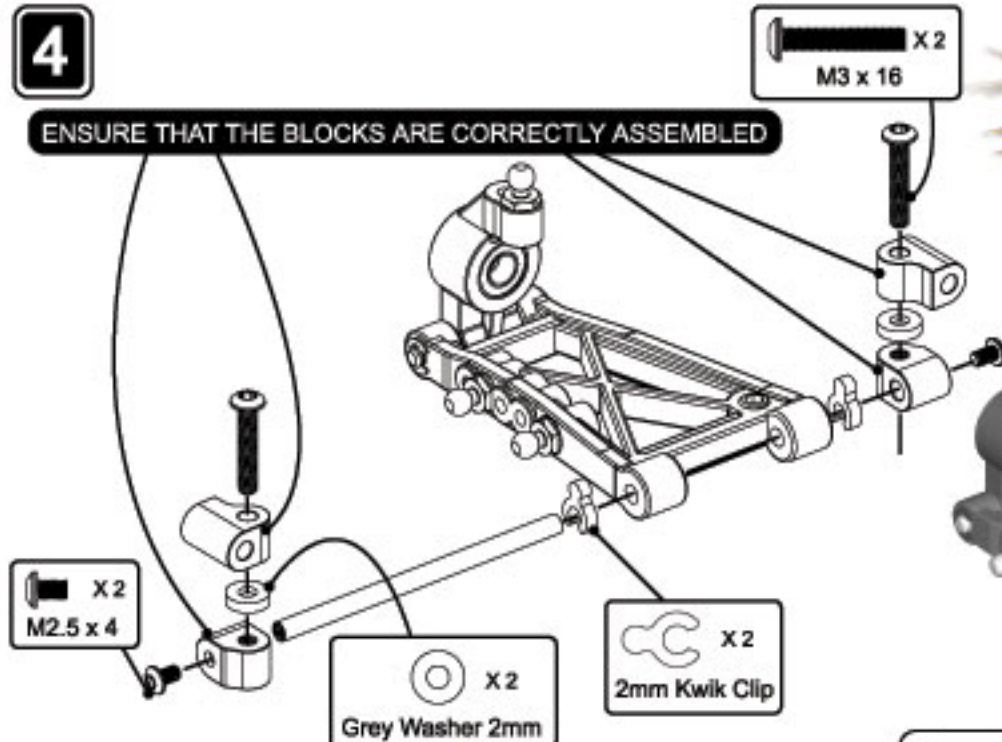

Stage 5 cont..

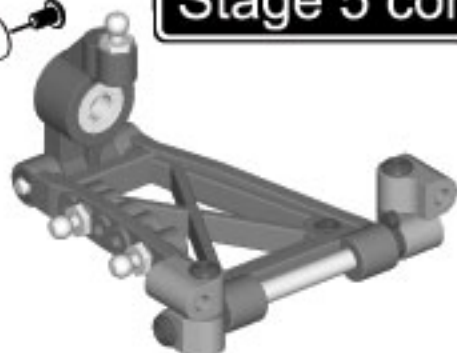

5

M3 x 20 X2

Grey Washer 0.5mm X1

Grey Washer 2mm X1

Grey Washer 1mm X2

Grey Washer 0.5mm X1

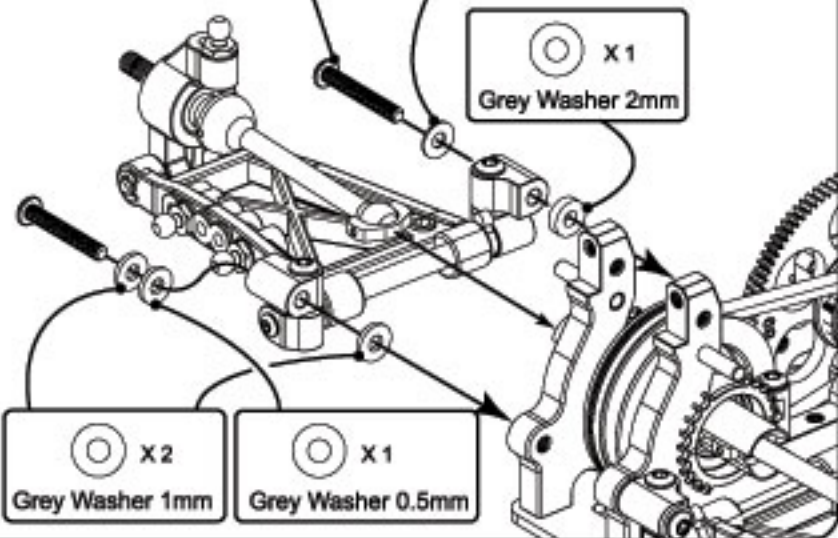

6

Pro-Spec Version

O'Ring X2

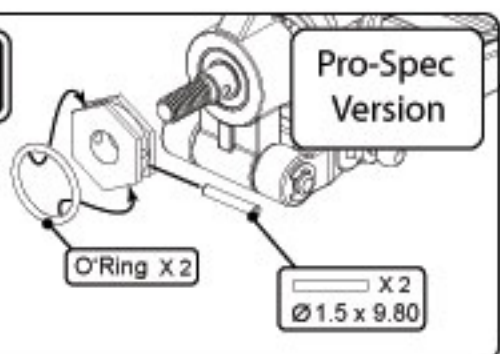
X2  
Ø 1.5 x 9.80

Shim X2

Spring Washer X2

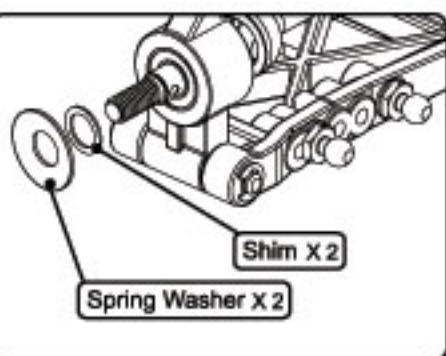

Race-Spec Version

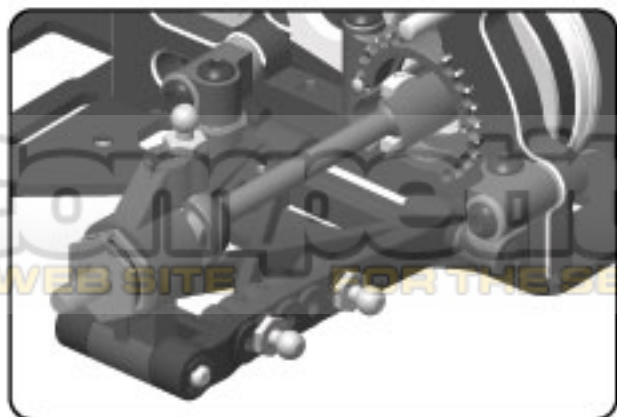
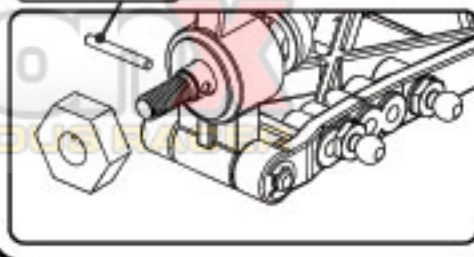
X2  
Ø 1.5 x 11.80



**1 Front Suspension Right hand Side**

**M4 Pivot Ball**

**Ball Stud**

Carefully Pre-tap the Hub Carrier using a Nut Runner and the M4 Pivot, this will ensure easier assembly with the yoke with better alignment.

**Spacer**

**M3 Nyloc**

**5 x 10 x 4**

**M4 Pivot**

**Stage 6**

Ensure Free Movement of the Hub in the Yoke

Left Right

Minimum Gap

Minimum Gap

Adjust the kingpins for minimum gap with free movement

**2**

**O'Ring**

$\varnothing 1.5 \times 9.80$

**Pro-Spec Version**

**Shim**

$\varnothing 1.5 \times 11.80$

**Spring Washer**

**Race-Spec Version**

**3**

**M5 x 8**

**Hub Must Lean Backwards**

**Ball Stud Ultra Short**

**Ball Stud**

**3 X 2 E clip**

4



Stage 6 cont..

M3 x 16 x 2

Grey Washer 1mm x 2

2mm Kwik Clip x 2

M2.5 x 4 x 2

ENSURE THAT THE BLOCKS ARE CORRECTLY ASSEMBLED

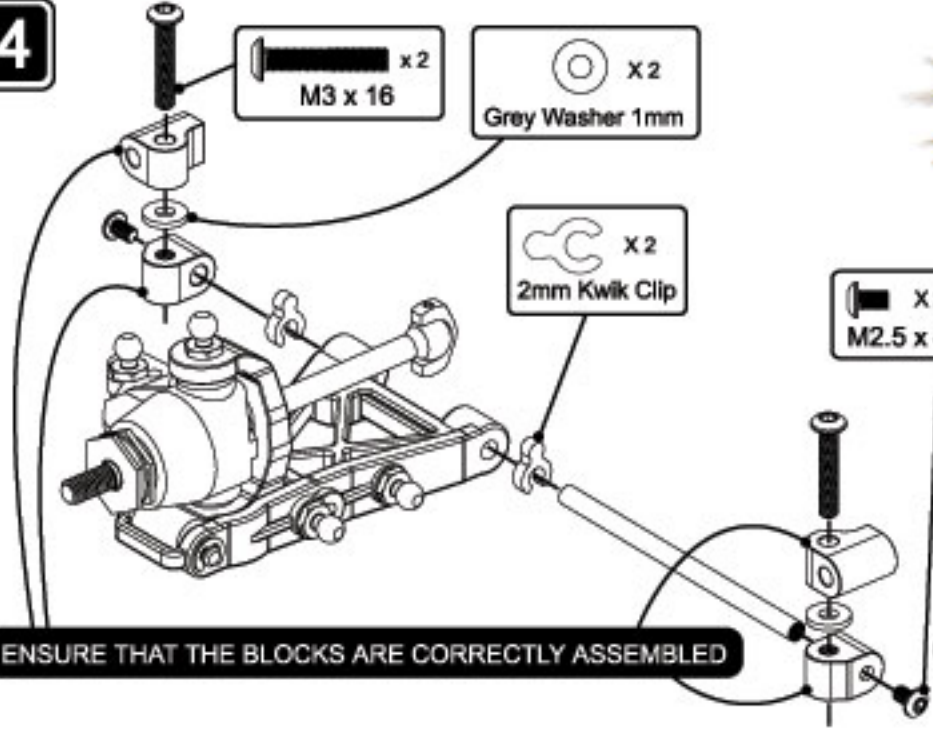

5

Grey Washer 1mm x 2

M3 x 20 x 2

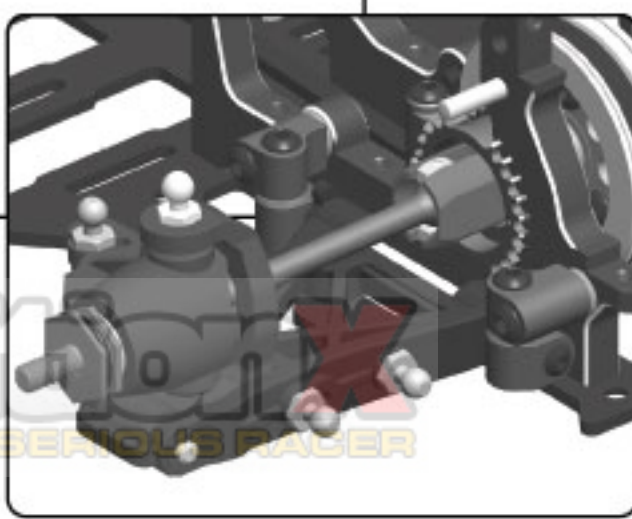
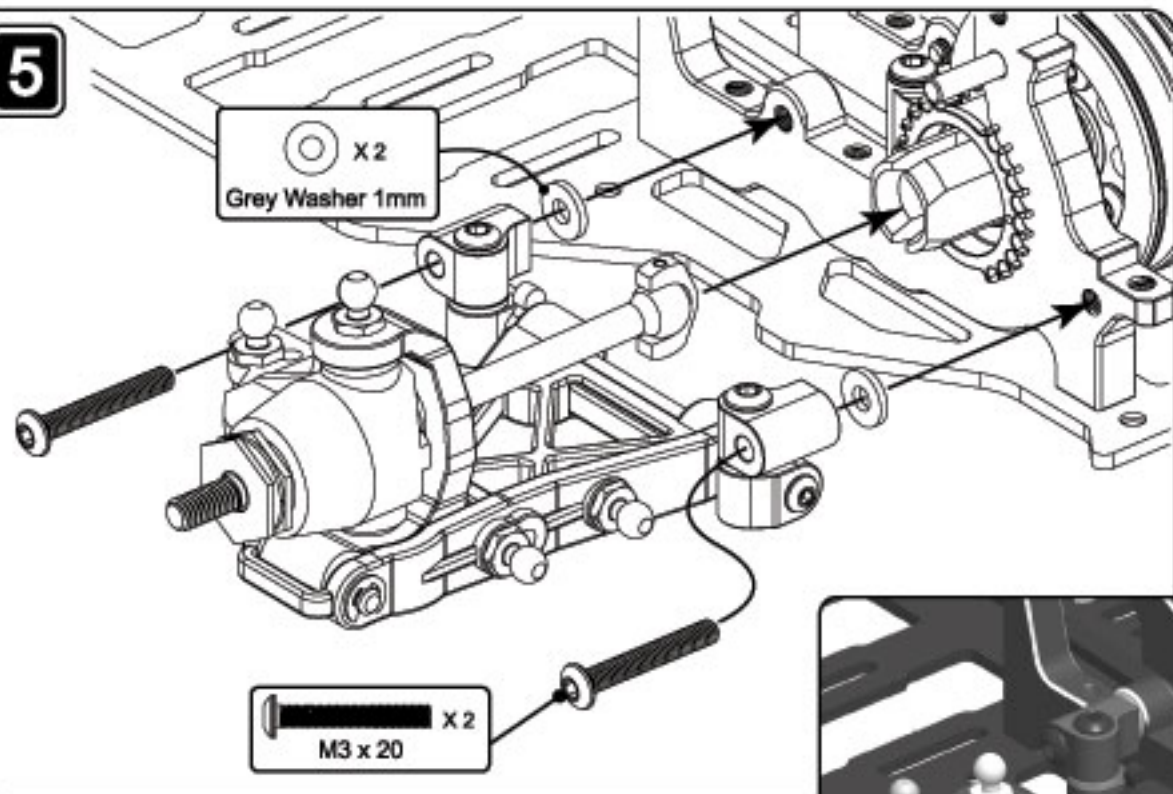

Use a washer to restrict steering lock and increase corner speed on outdoor tracks. very tight twisty tracks require more lock so the washer is not required.

A WEB SITE FOR THE SERIOUS RACER

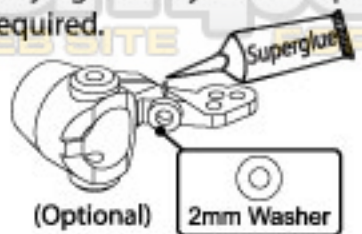

(Optional) 2mm Washer

**1****Front Suspension  
Left hand Side**

M4 Pivot Ball

Ensure Free Movement  
of the Hub in the Yoke

Carefully Pre-tap  
the Hub Carrier  
using a Nut Runner  
and the M4 Pivot,  
this will ensure  
easier assembly with  
the yoke with  
better alignment.

Ball Stud

Left Right

Spacer

**Stage 6 cont...**

M4 Pivot

5 x 10 x 4 X 2

M3 Nyloc

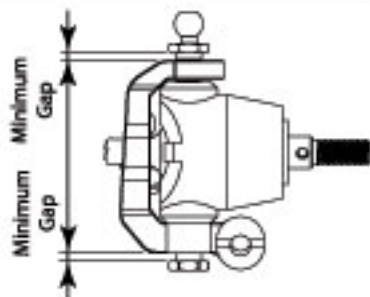

Adjust the kingpins for minimum gap with free movement

**2**Pro-Spec  
Version

Ø 1.5 x 9.80

O'Ring

Race-Spec  
Version

Shim

Spring Washer

Ø 1.5 x 11.80

**3**

M5 x 8

Ball Stud  
Ultra Short

Ball Stud

X 2  
E clip

Hub Must Lean Backwards



**4**

 X2  
Grey Washer 1mm

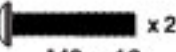
 X2  
M3 x 16

 X2  
2mm Kwik Clip

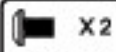
 X2  
M2.5 x 4



**Stage 6 cont...**

**ENSURE THAT THE BLOCKS ARE CORRECTLY ASSEMBLED**

**5**

 X2  
Grey Washer 1mm

**L.H.S**

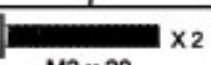
 X2  
M3 x 20

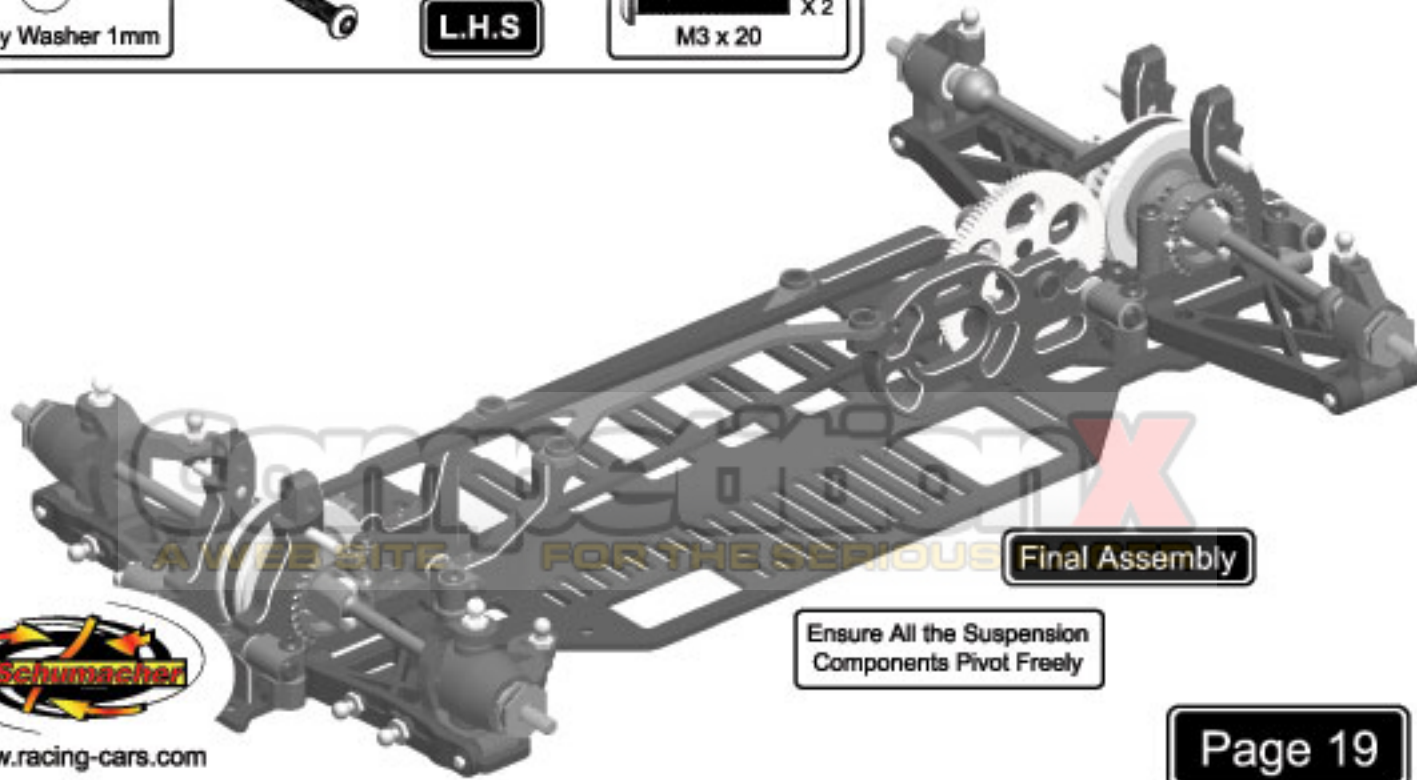
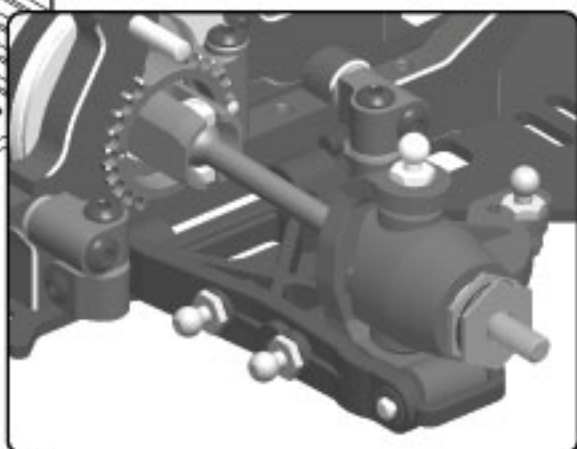

**Final Assembly**

**Ensure All the Suspension Components Pivot Freely**



1

X2  
M3 x 8

X2  
M3 x 3



Stage 7  
Pro-Spec

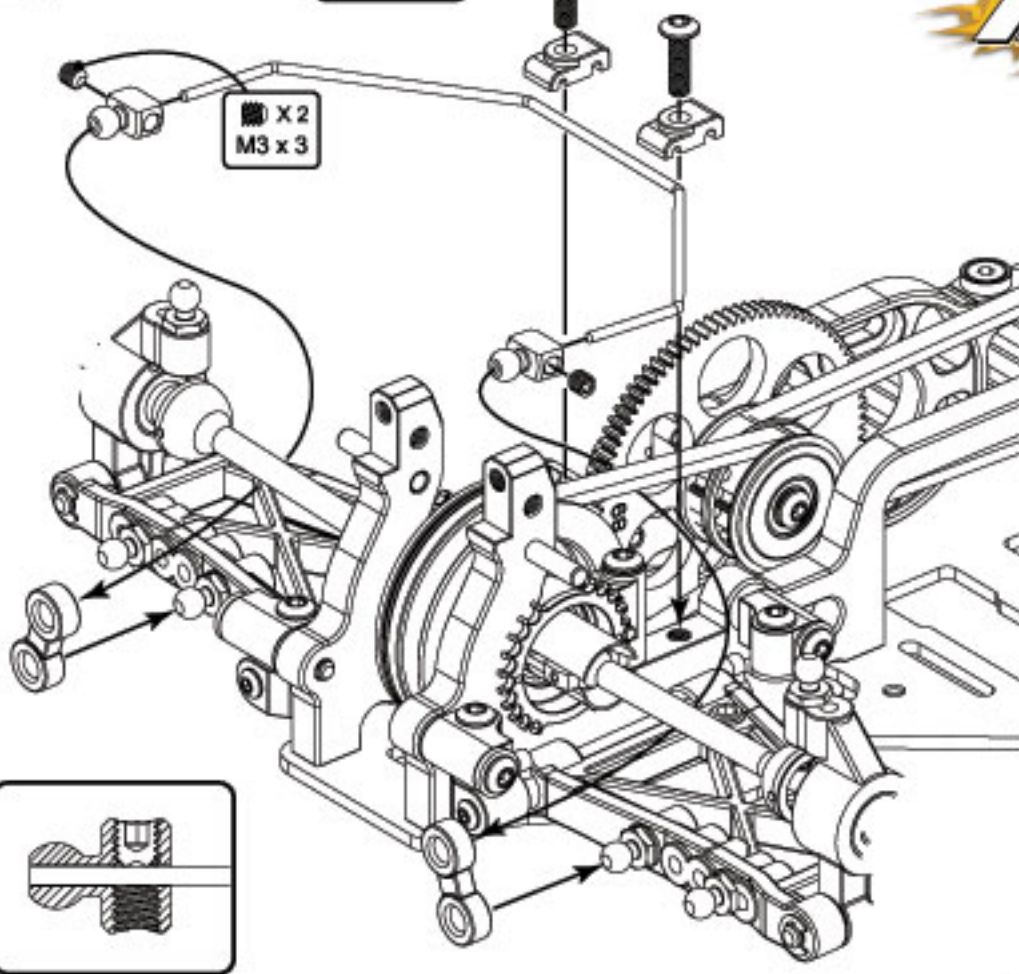
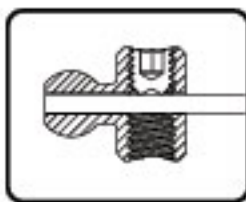

Final Assembly

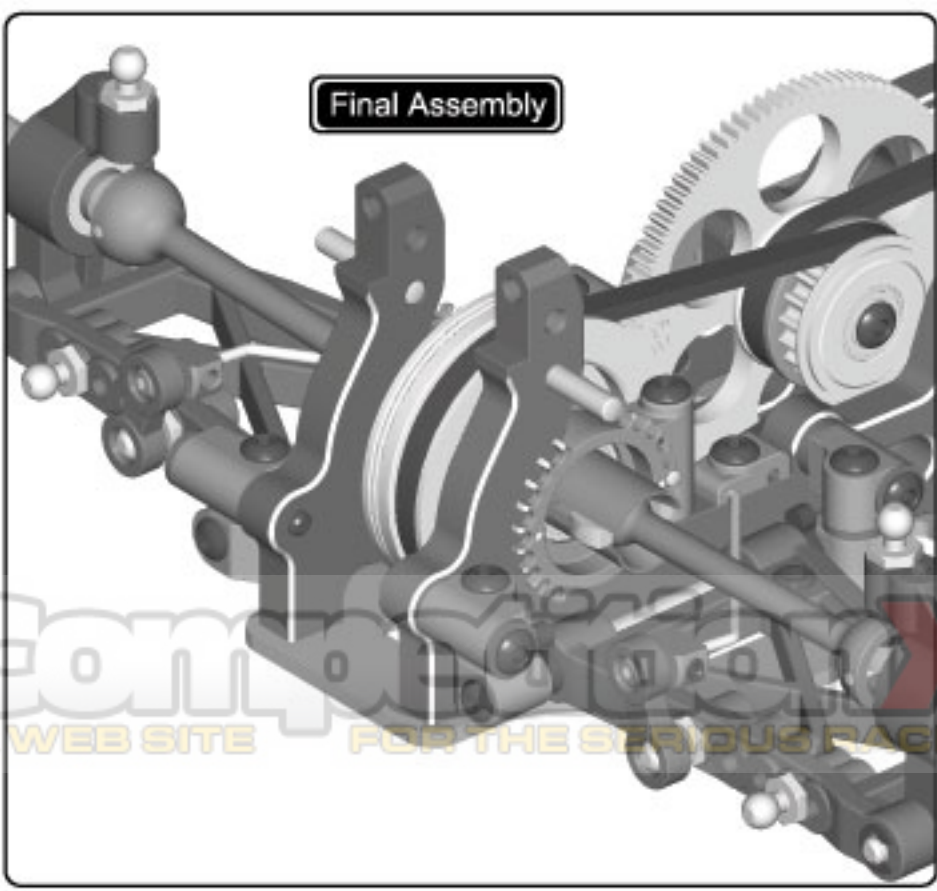

COMPARTS  
A WEB SITE FOR THE SERIOUS RACER





Stage 7 cont..  
Pro-Spec

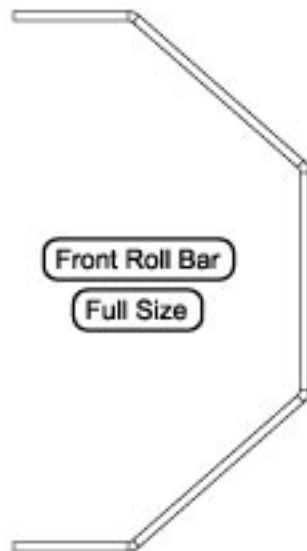

2

X2  
M3 x 8

X2  
M3 x 3

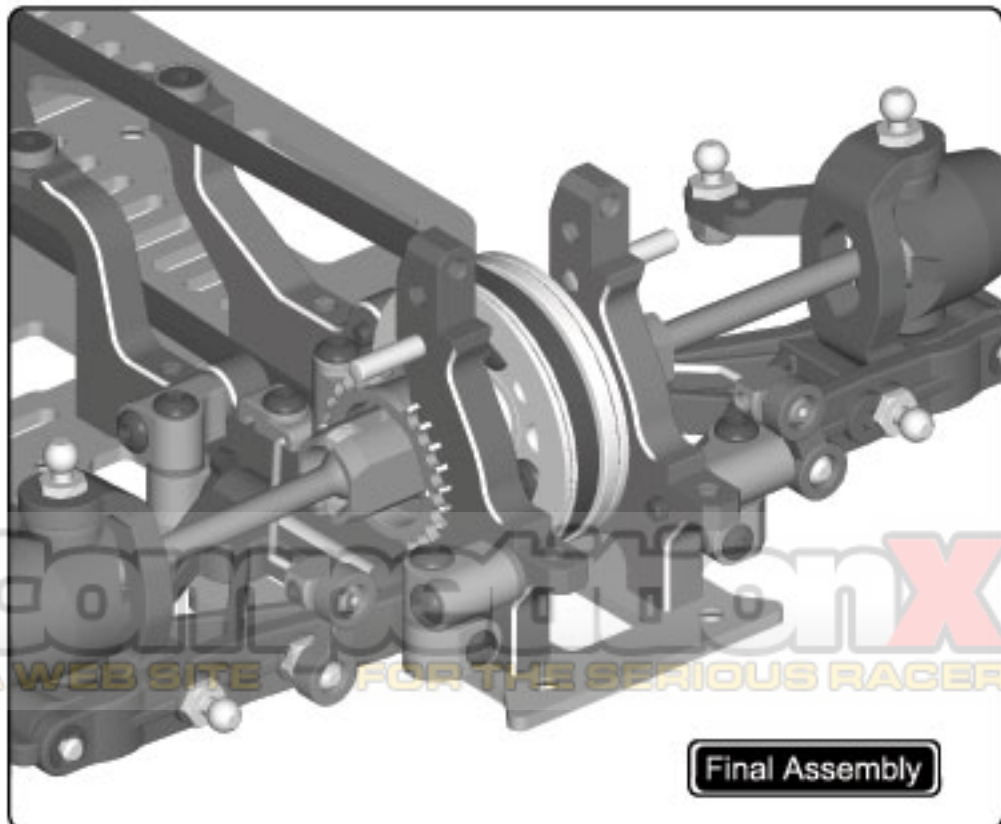
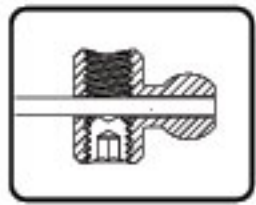
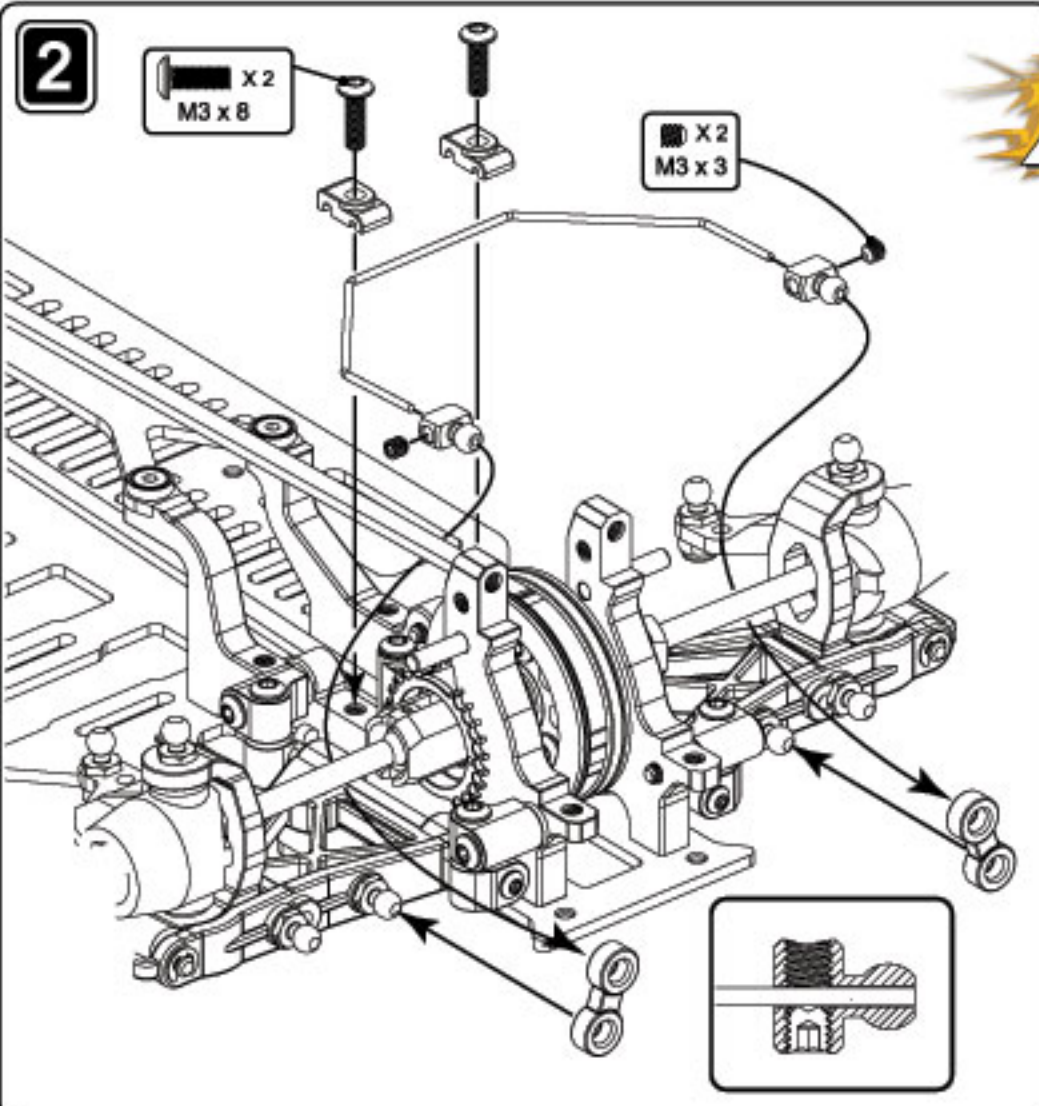

Final Assembly

Golden Edition X  
A WEB SITE FOR THE SERIOUS RACER



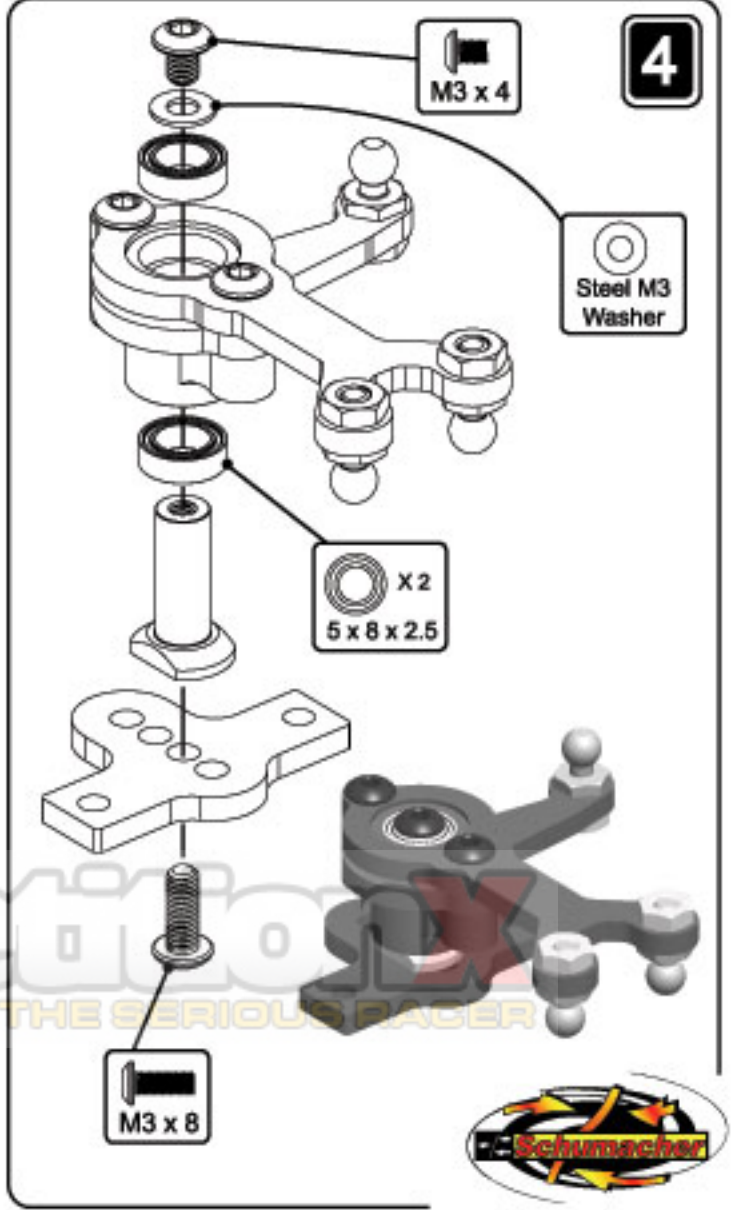
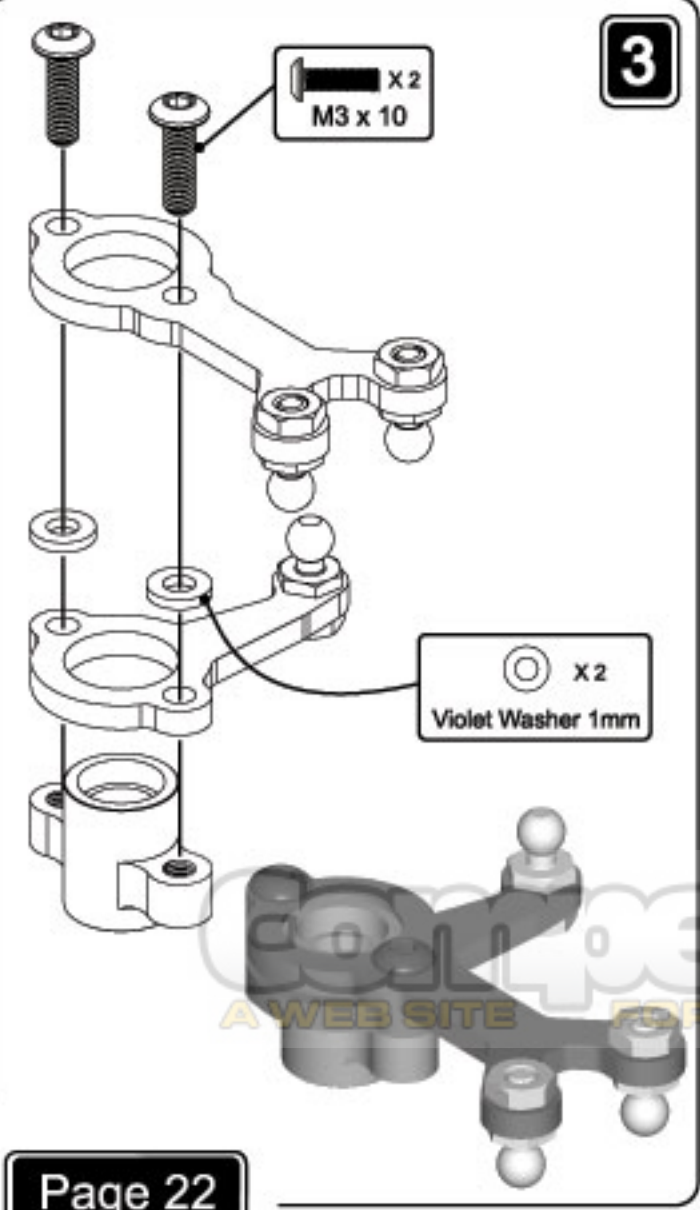
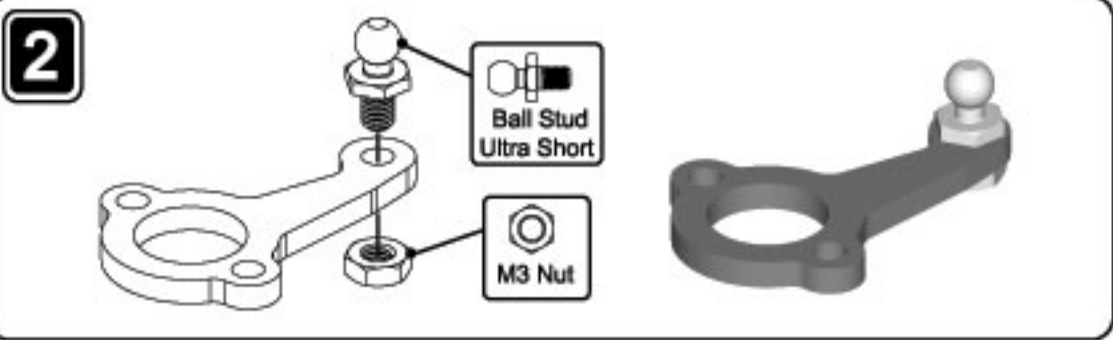
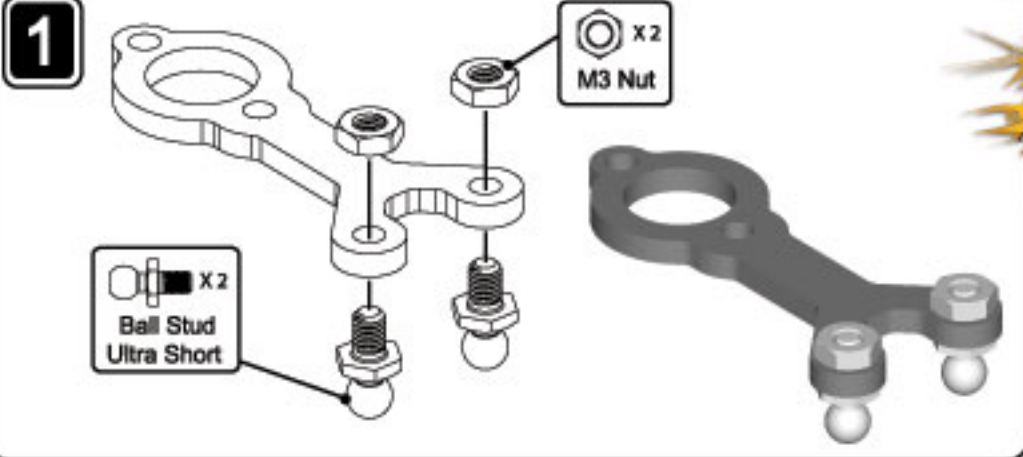

5

X2  
M3 x 8



Stage 8 cont...

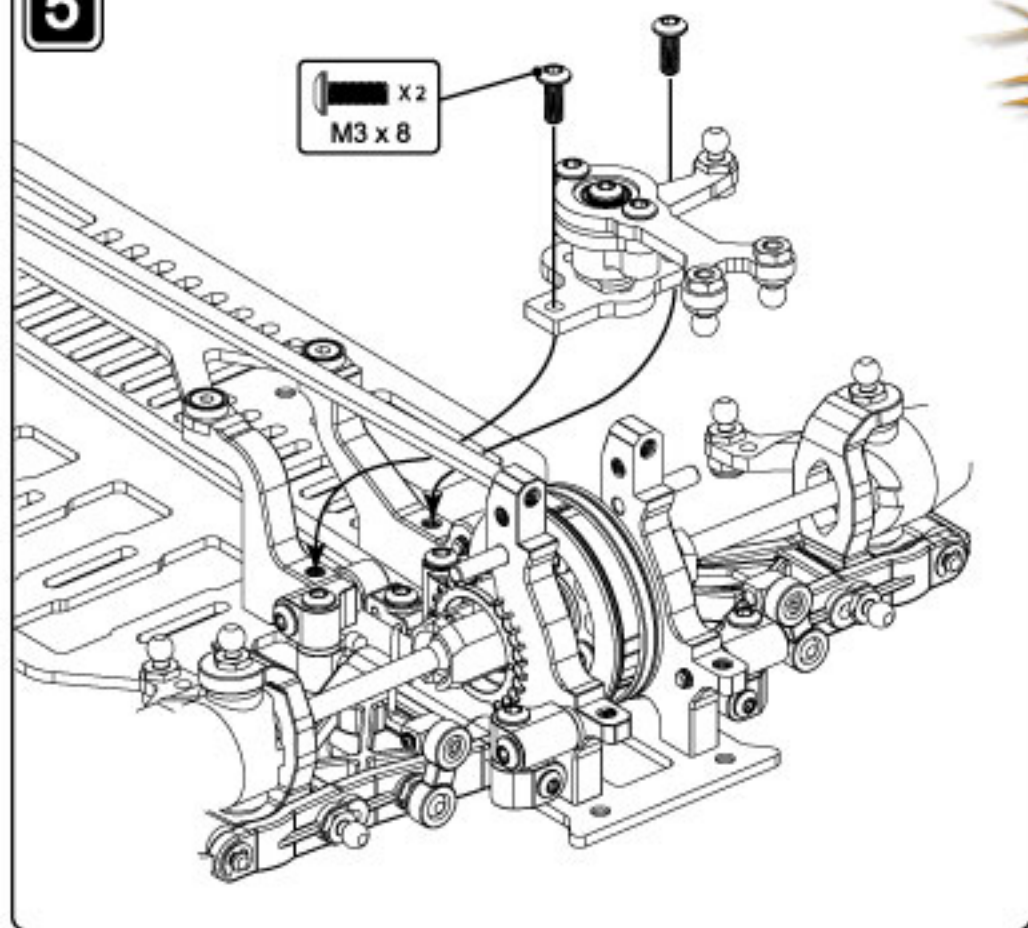

Final Assembly

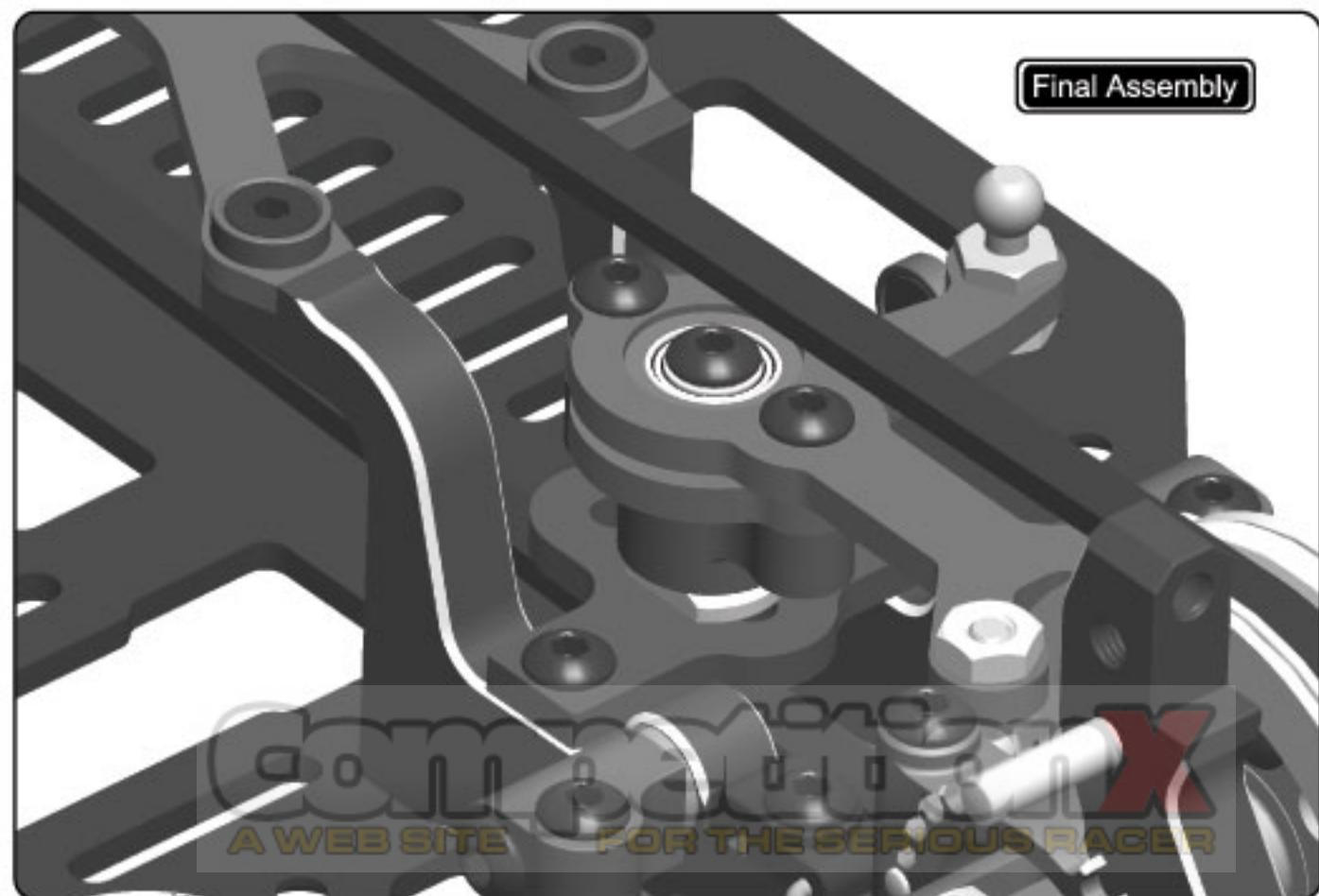

COMPTON RACING X  
A WEB SITE FOR THE SERIOUS RACER





**1**Violet Washer  
2mmViolet Washer  
0.50mm

Ball Stud

Use the Long  
Ball stud if  
using more  
washers**2**

15.00mm (Rear Link)

35mm Turnbuckle

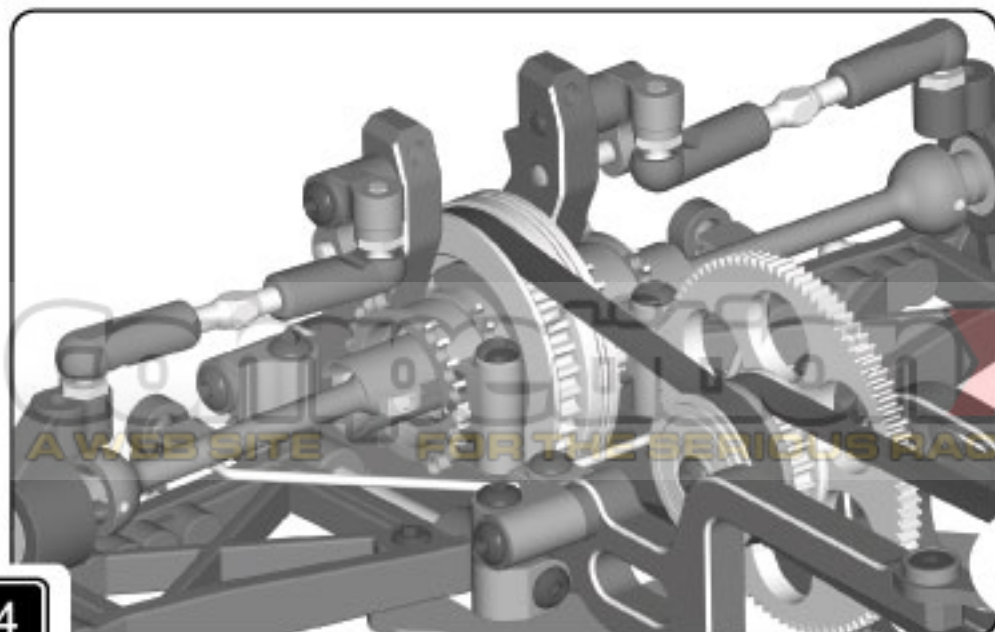
**Stage 9****3**X2  
Grey Washer 1mmX4  
Grey Washer 2mmX2  
M3 x 16X2  
Grey Washer 0.5mm

4

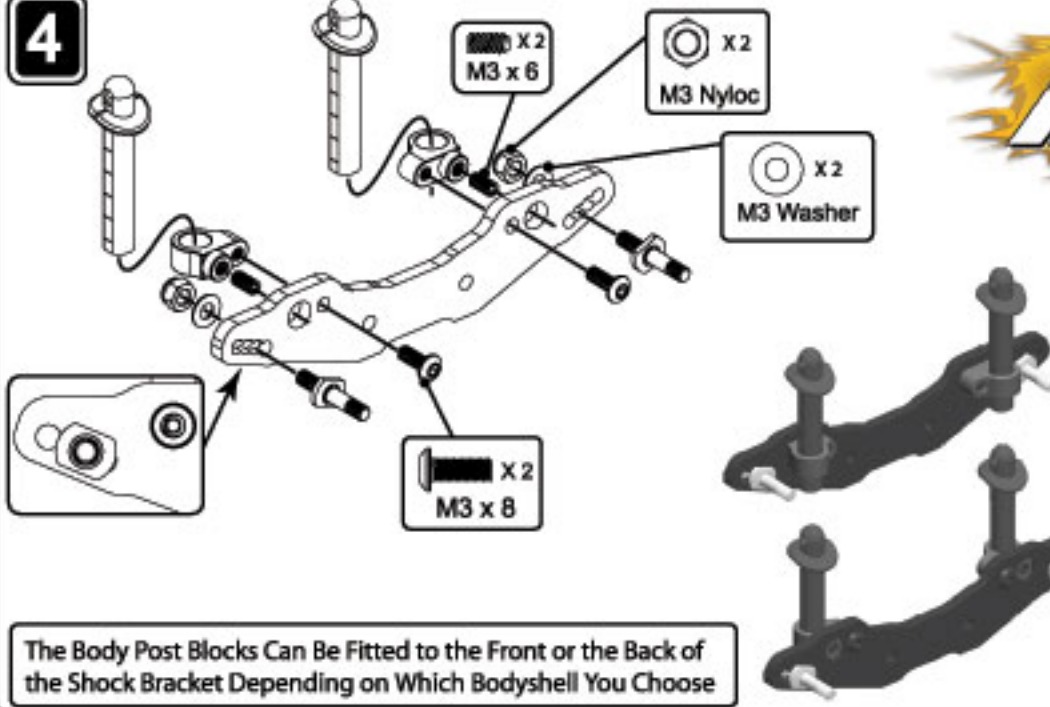

Stage 9 cont..  
+  
Bodymounting

The Body Post Blocks Can Be Fitted to the Front or the Back of the Shock Bracket Depending on Which Bodysell You Choose

5

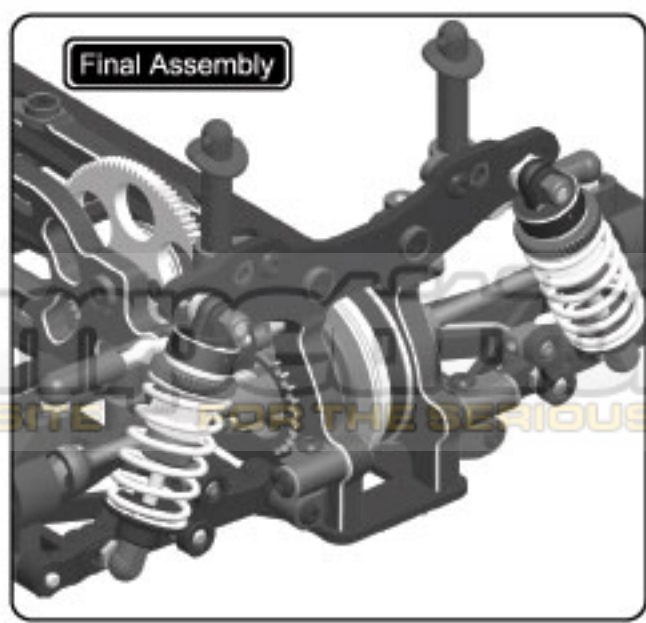
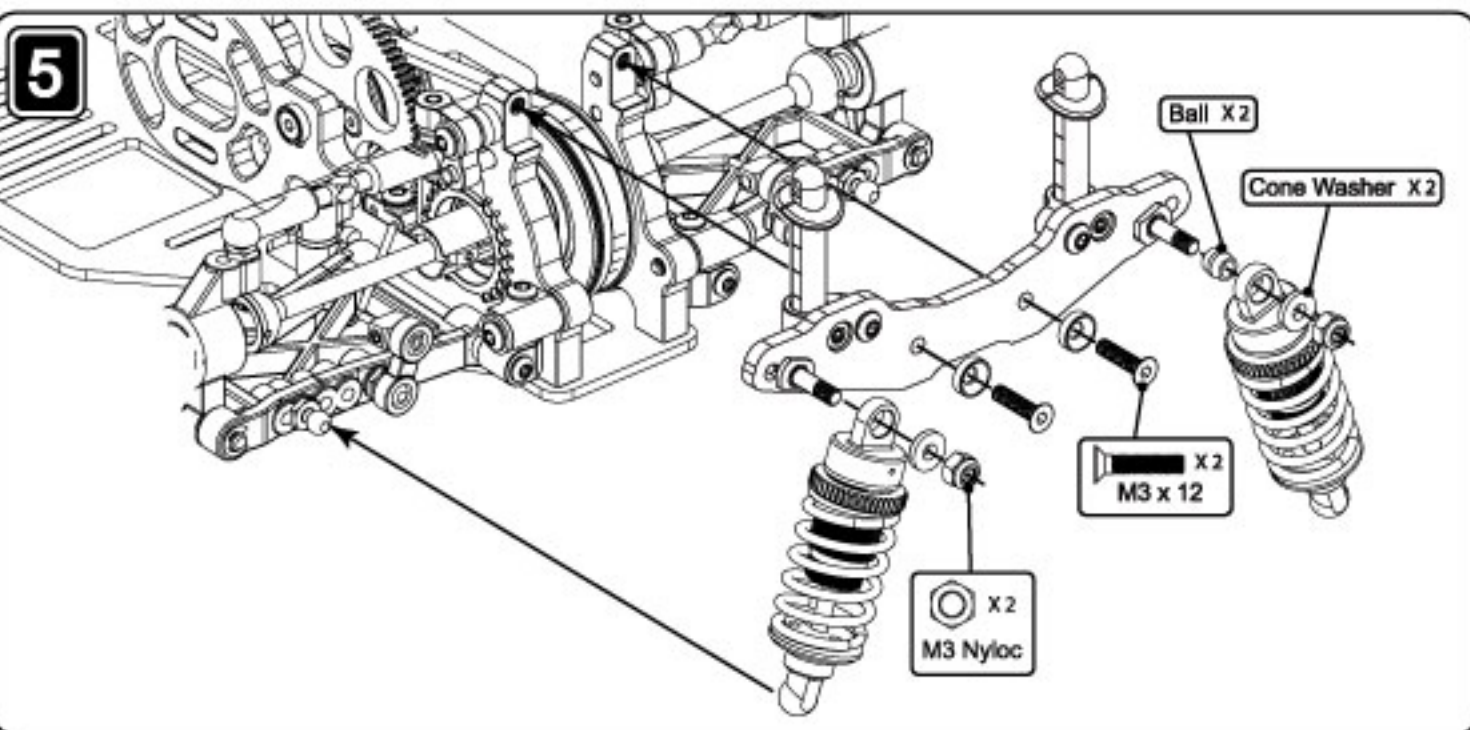

**1**

22.50mm (Front Track Rod)

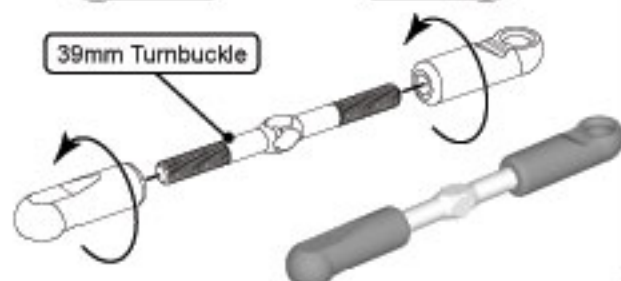

39mm Turnbuckle

**2**

14.50mm (Front Link)

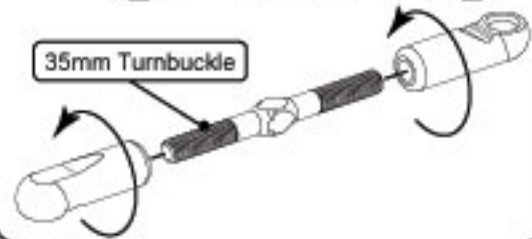

35mm Turnbuckle

**3**

Violet Washer  
1mm

Use the long  
ball studs if using  
more washers

Ball Stud

**Stage 10**

x 2

Grey Washer 0.5mm

x 2

Grey Washer 1mm

x 4

Grey Washer 2mm

**4**

x 2  
M3 x 16

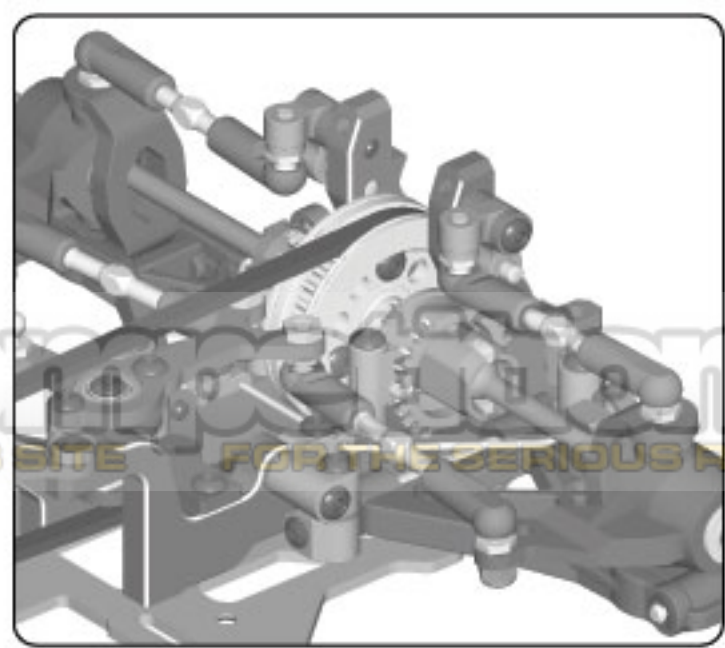
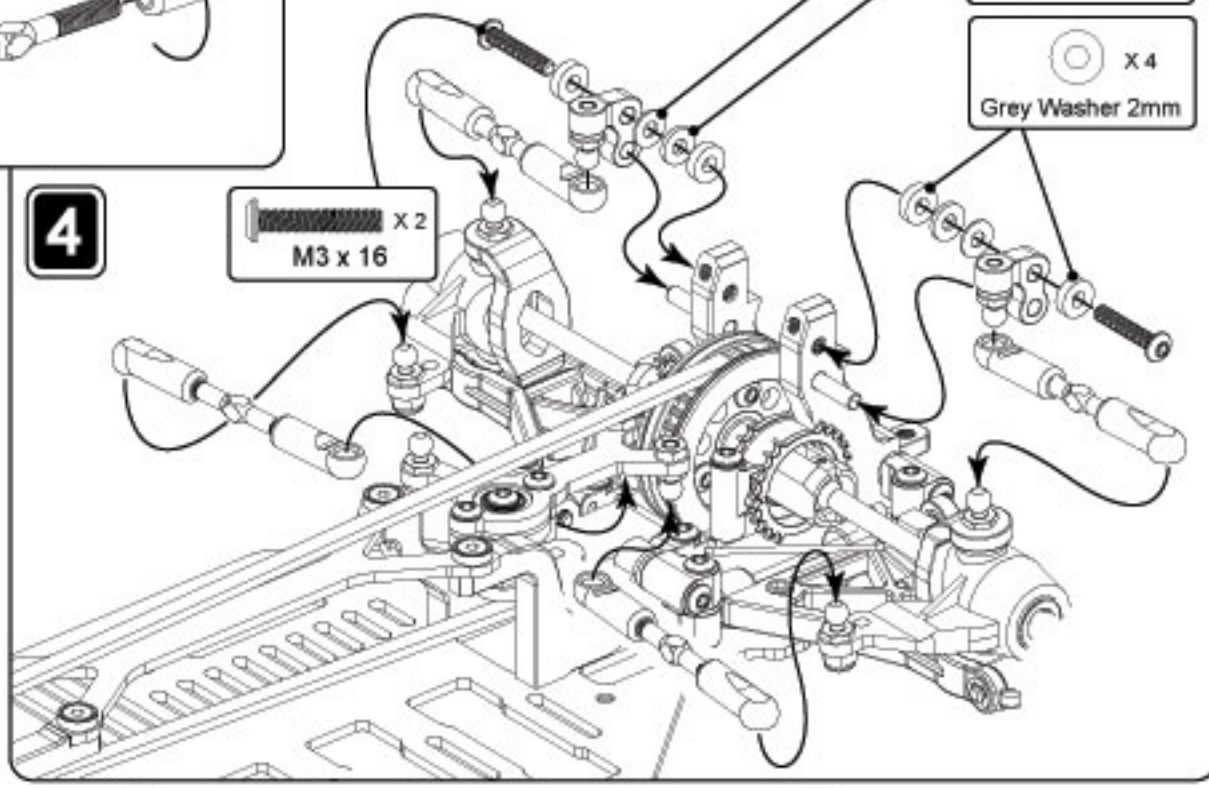

GO TO THE  
A WEB SITE FOR THE SERIOUS RACER

Page 26



www.racing-cars.com

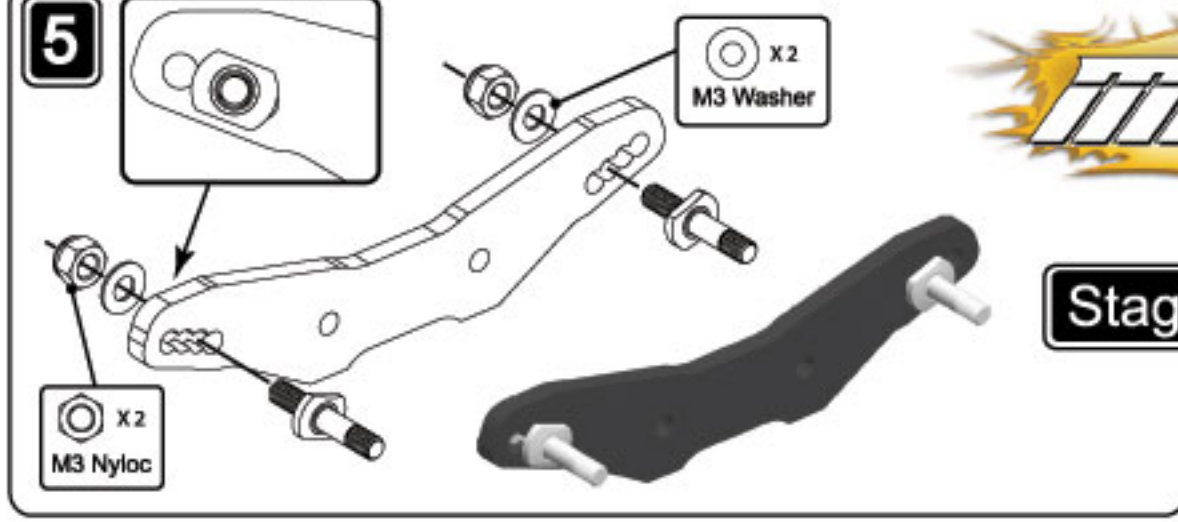

Stage 10 cont...

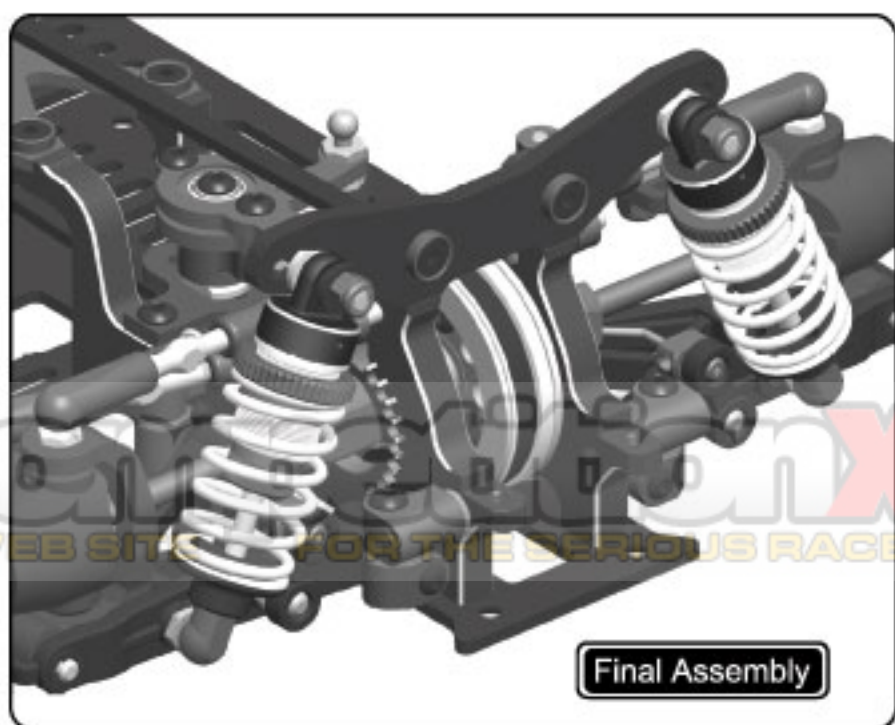
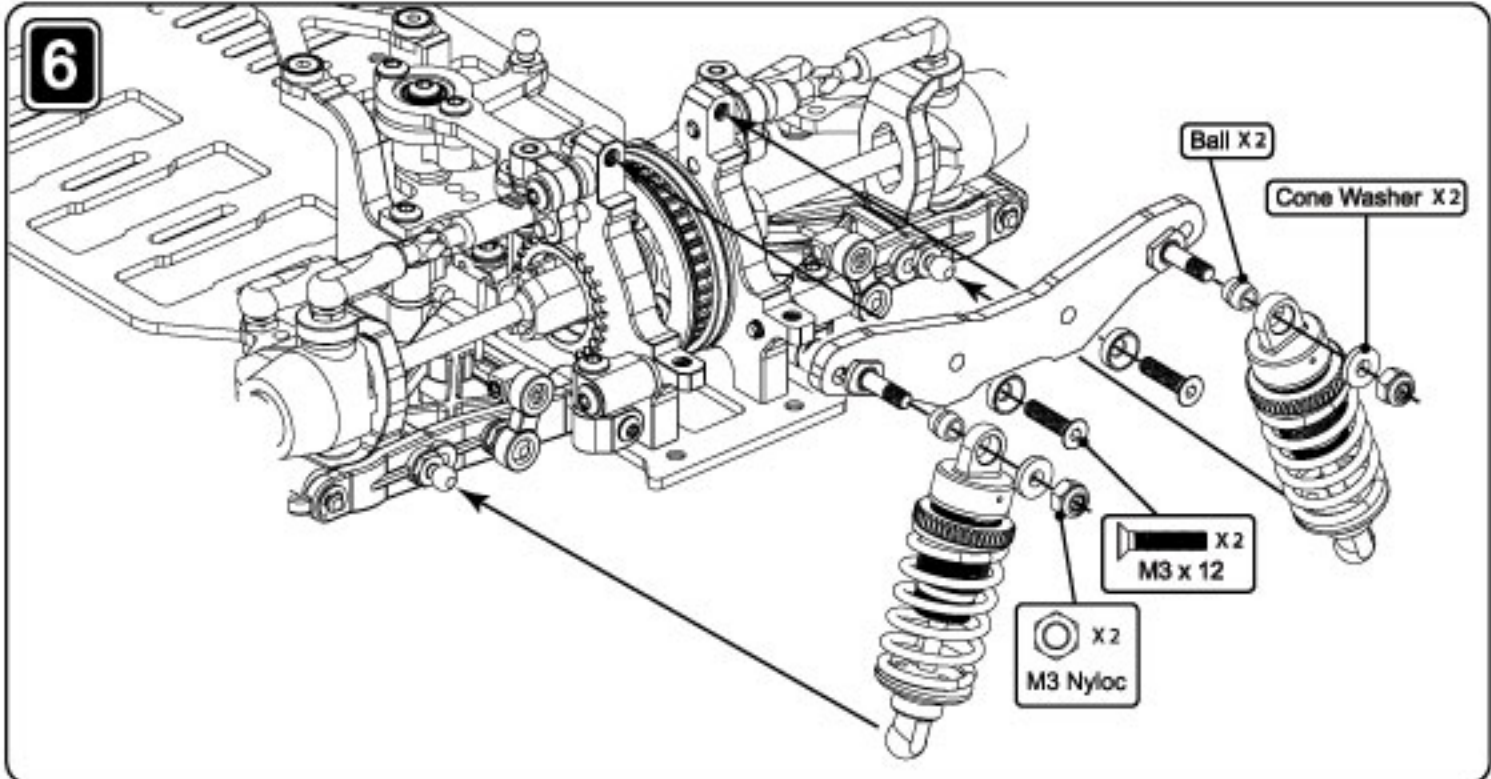

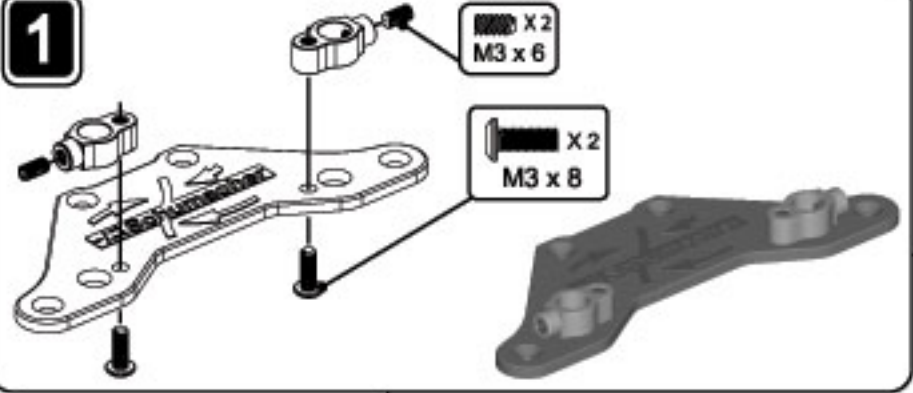

**Front Body Mounts and Bumper**

**2**

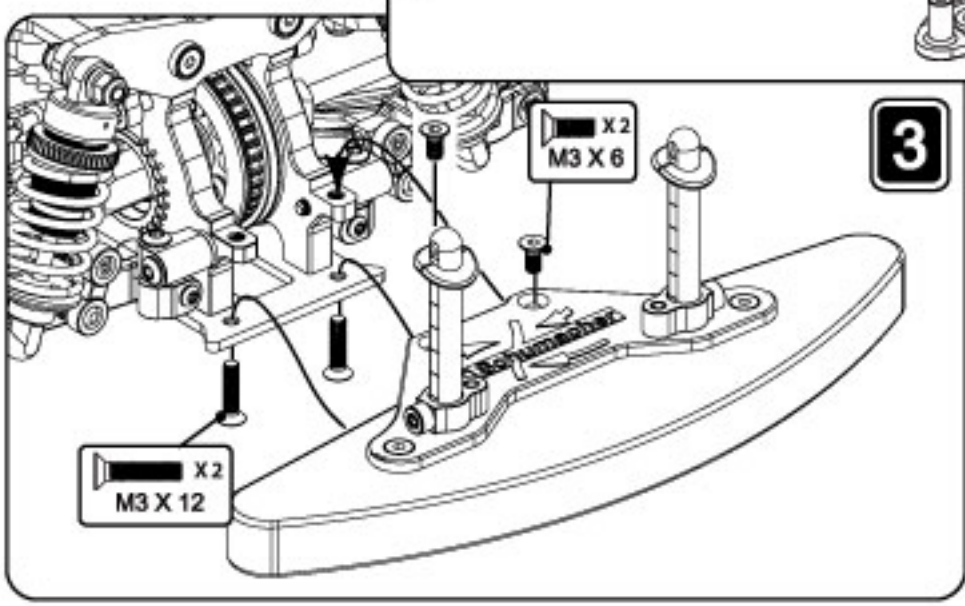
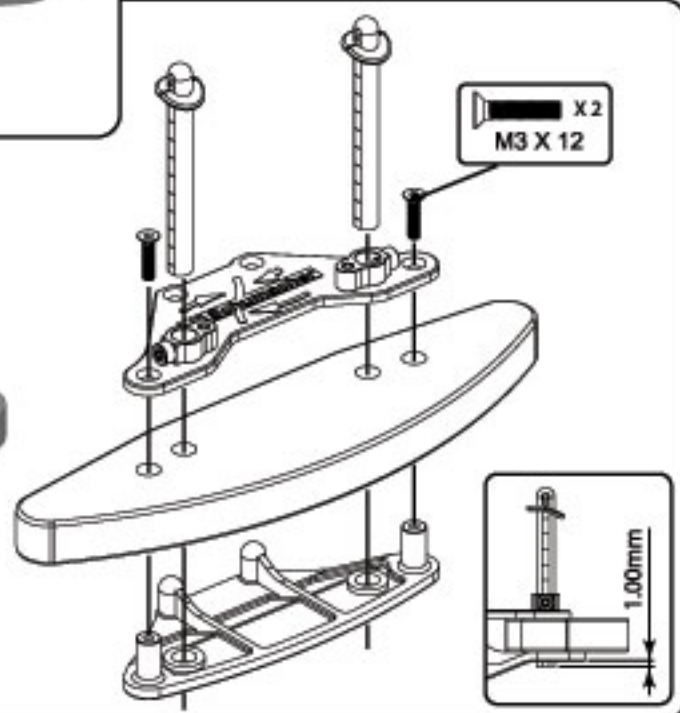

GO KARTS  
A WEBSITE FOR THE SERIOUS RACER



**1****SERVO SAVER OPTION**

CHOOSE THE CORRECT HORN FOR YOUR SERVO.  
 SA = SANWA/AIRTRONICS  
 FU = FUTABA  
 SH = SCHUMACHER/HITEC

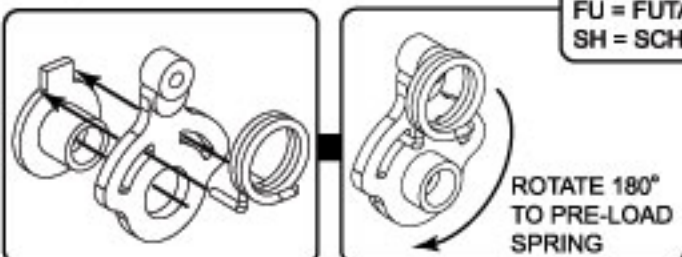
**Radio Installation**

ROTATE 180°  
TO PRE-LOAD  
SPRING

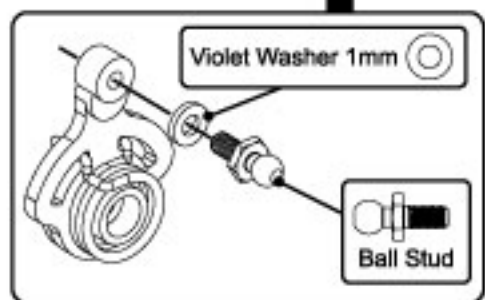

Violet Washer 1mm

Ball Stud

**1****NON SERVO SAVER OPTION**

X 2  
M3 Nyloc

Ball Stud

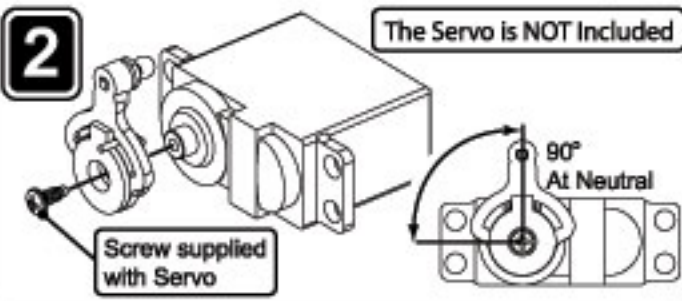

The Servo is NOT Included

90°  
At Neutral

Screw supplied  
with Servo

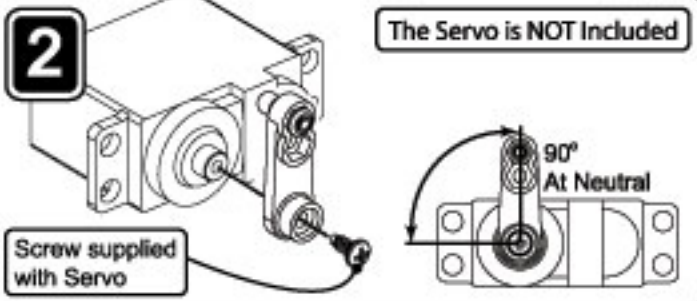

The Servo is NOT Included

90°  
At Neutral

Screw supplied  
with Servo

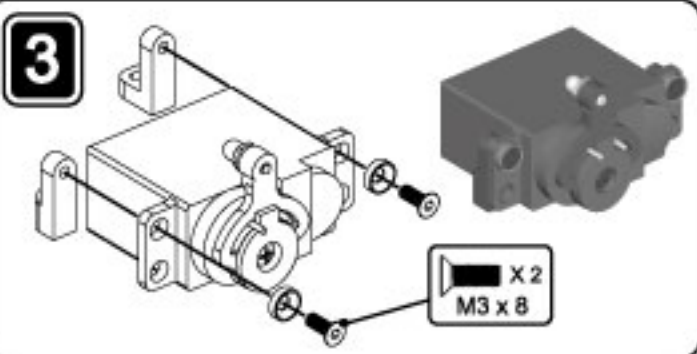

X 2  
M3 x 8

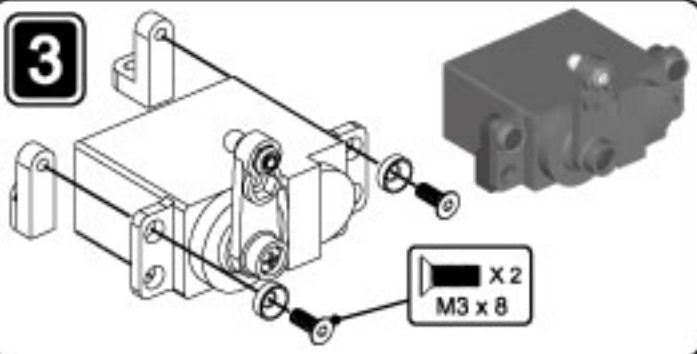

X 2  
M3 x 8

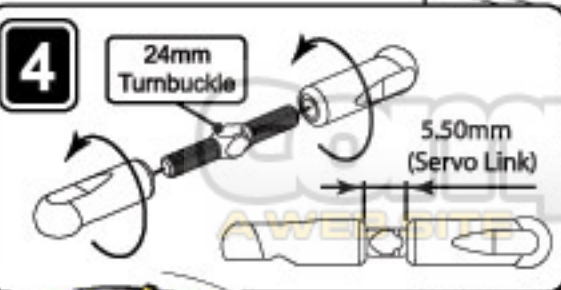

24mm  
Turnbuckle

5.50mm  
(Servo Link)

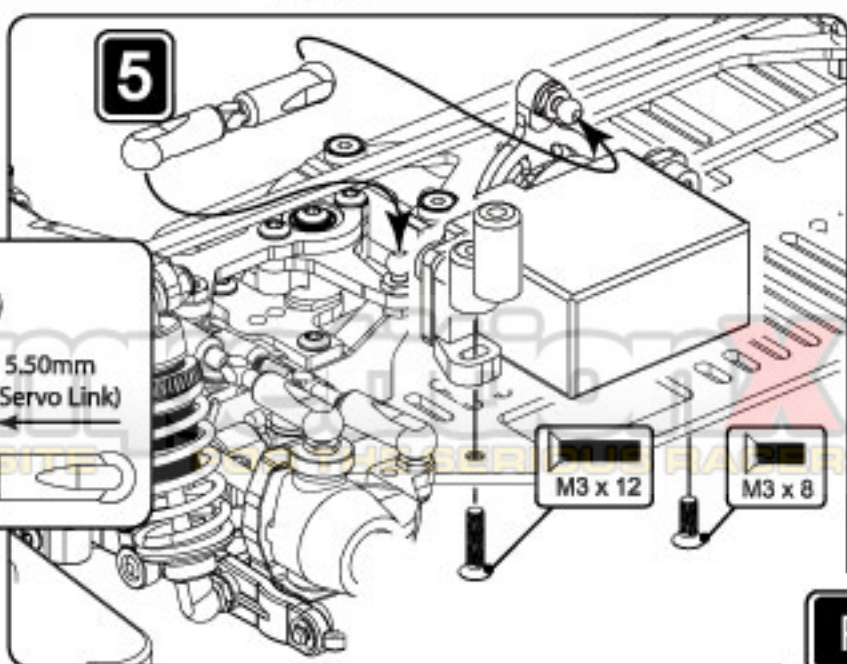

M3 x 12

M3 x 8



6

The Motor and Pinion are NOT Included

X2  
M3 Washer

X2  
M3 x 8



Radio Installation cont...

7

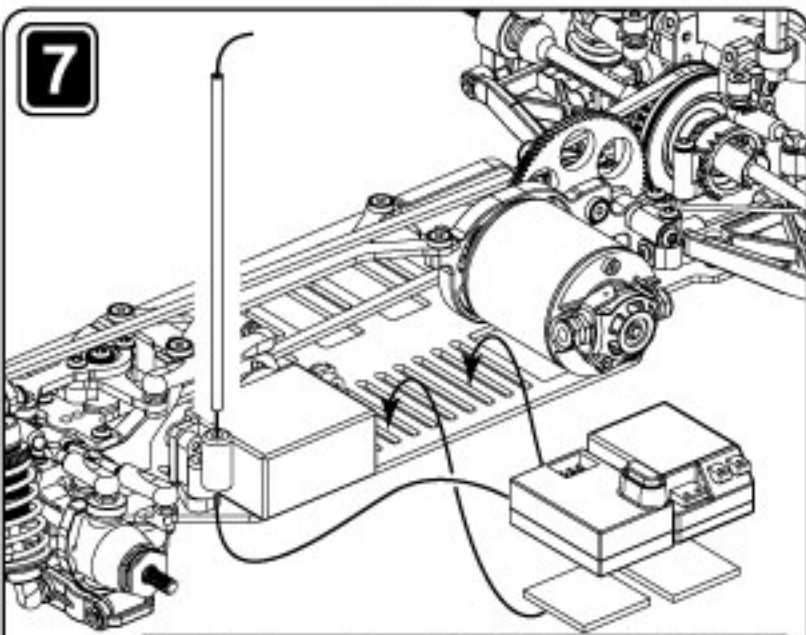

The Receiver and Speed Controller are NOT included

8



The Tyres and Inserts are NOT Included

When using the 5 Cell Chassis fit the Receiver behind the Cells.

9



X4  
Wheel Shim

X4  
M4 Nyloc

The Wheel Shims May not be Required with Some Wheels

Final Assembly

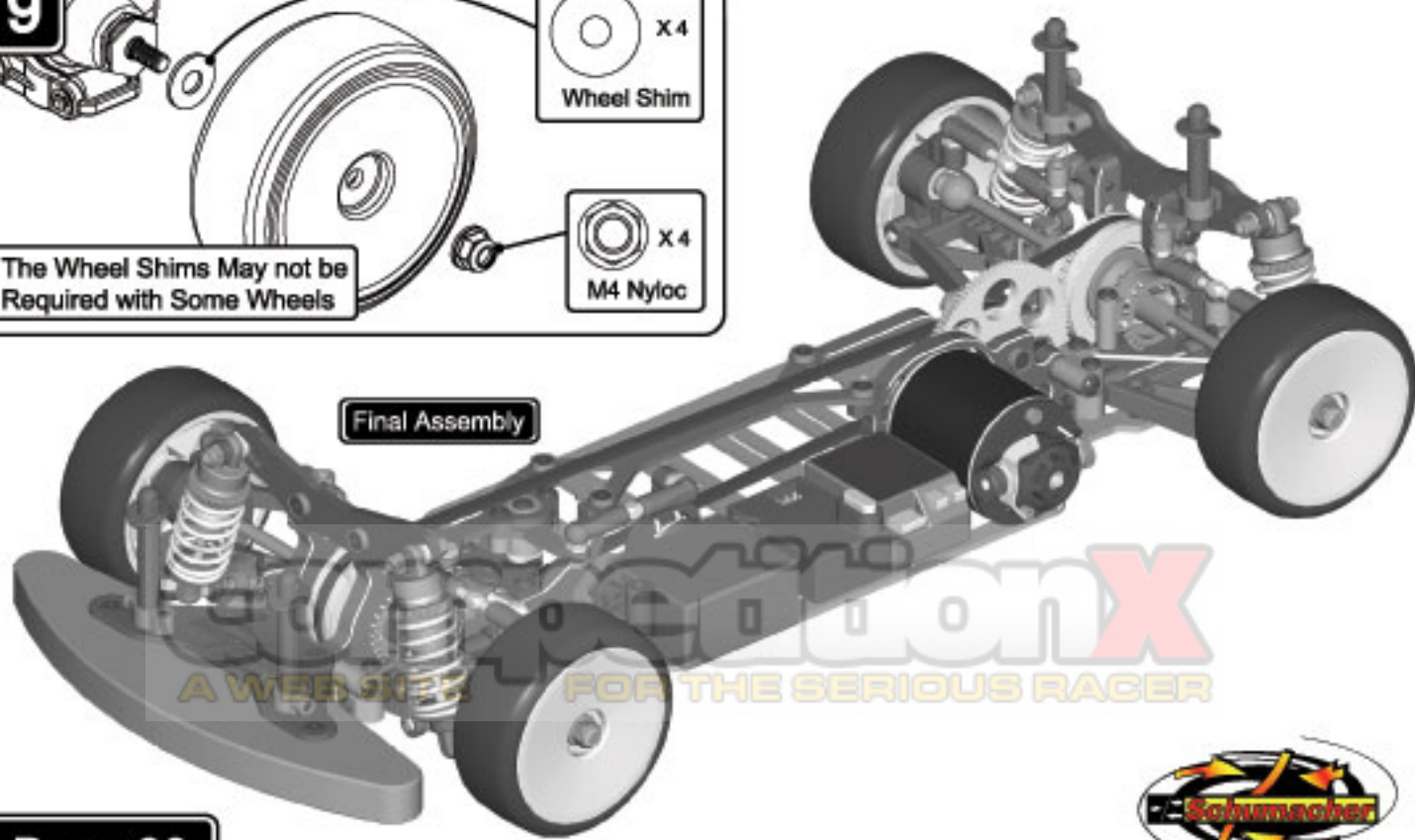

www.racing-cars.com  
A WEB SITE FOR THE SERIOUS RACER

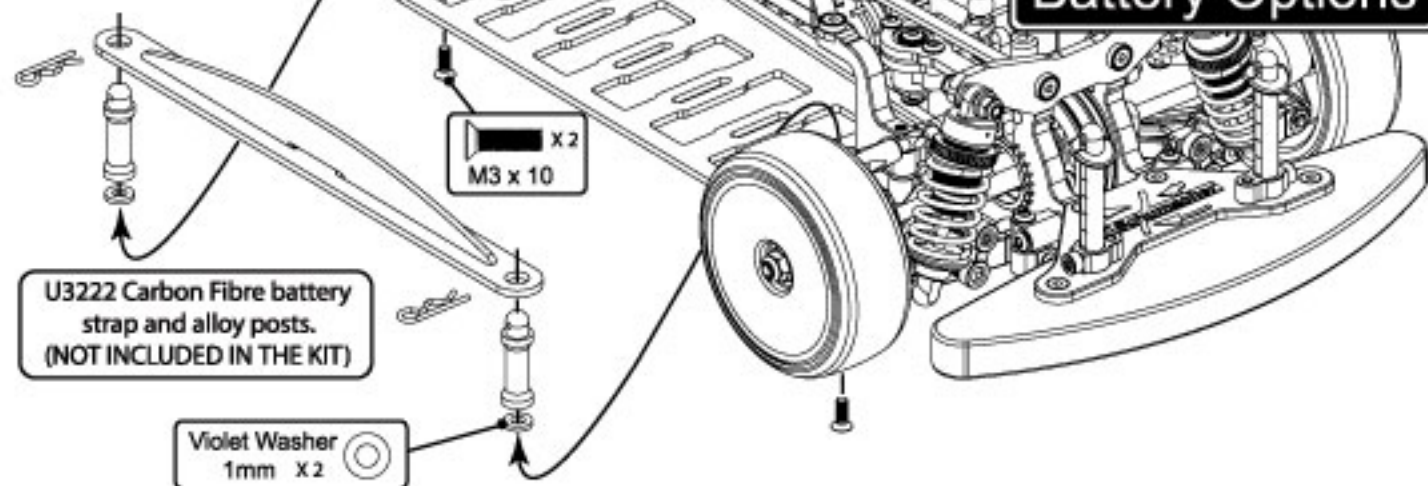
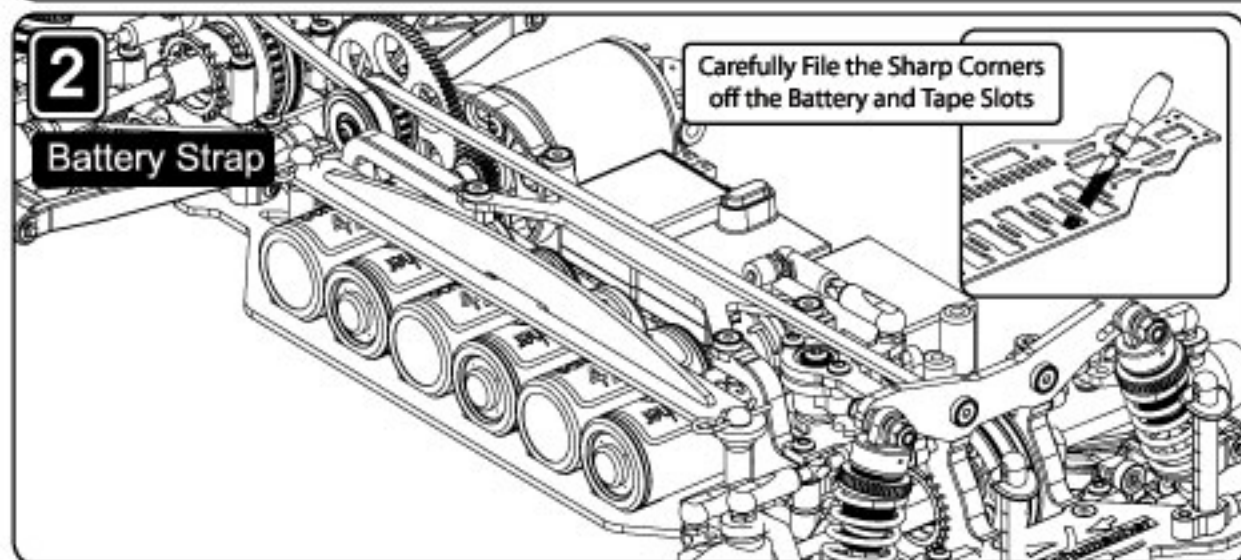

**1****Battery Strap****m3.5****Battery Options****2****Battery Strap**Carefully File the Sharp Corners  
off the Battery and Tape Slots**1****Battery Tape**

CR005 - Black Battery Tape  
 CR006 - Blue Battery Tape  
 CR007 - Purple Battery Tape  
 H1039 - Natural Battery Tape  
 (NOT INCLUDED IN THE KIT)

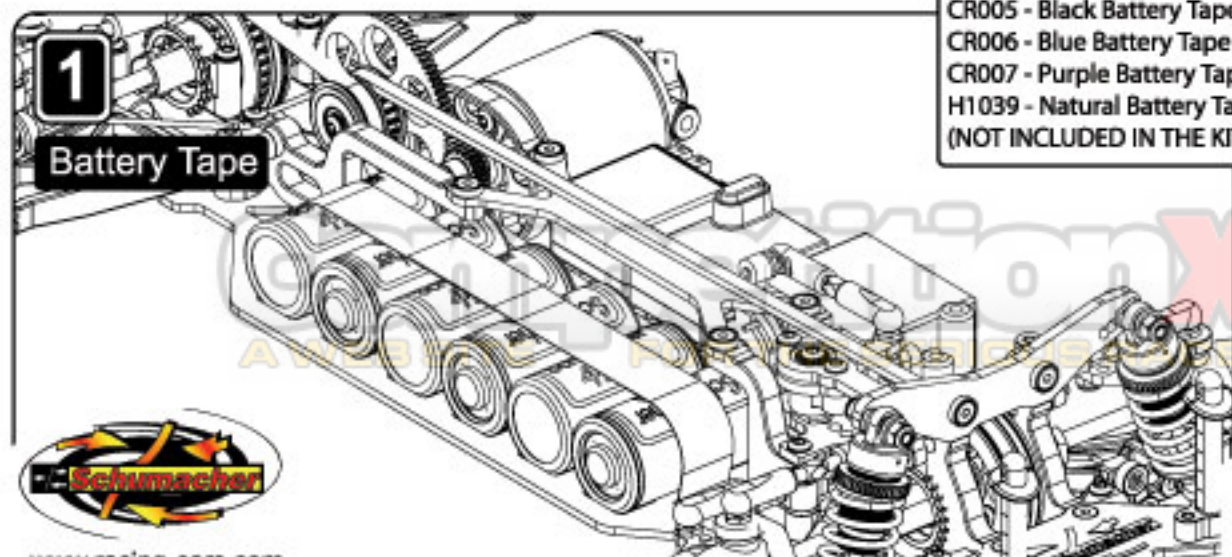



## SPRINGS

The spring rate controls the suspension stiffness. Spring adjusters only change the ride height. They DO NOT alter the suspension stiffness. On slippery or bumpy tracks use soft to medium rate springs, on flat or high grip tracks run medium to hard rate springs.

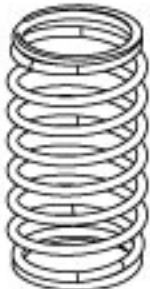

## STEERING

With the Ball centres Closer together you will get a more aggressive steering response, and further apart will give a less aggressive steering response. The options are available when you purchase, U3135 Steering Set

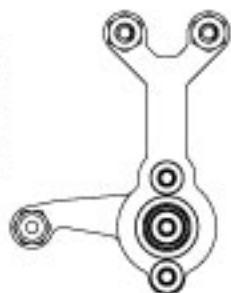

## Track Settings

### FRONT CASTOR

The front castor can be altered by changing the yoke. The car comes with 4° castor as standard. Less castor will give a quicker steering response, but could lead to power on understeer. More castor will give the opposite, slightly slower turn in, but more power on steering.

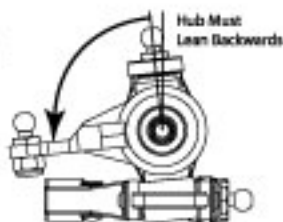

### SHOCK BRACKETS (Shock Mounting)

Vertical shock absorbers make the car react sharply to driver inputs.

A laydown shock offers a softer feel to the driver.

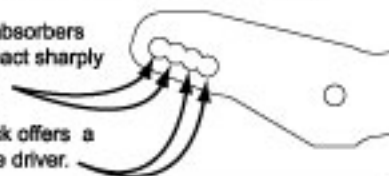

### RIDE HEIGHT

In general always run the car as low as possible, without the chassis grounding out, as it rolls into corners.

A good starting point with rubber tyres is 5.5mm at the front and 6.0mm at the rear.

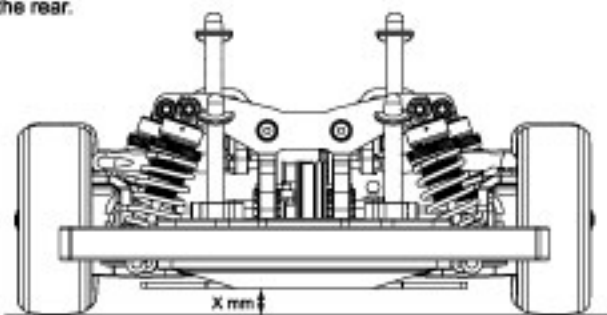

### FRONT & REAR CAMBER

With maximum negative camber the car will have high levels of grip, but there may be the possibility of sudden breakaway in corners. Reducing the camber gives a more progressive slide, but may give less grip.

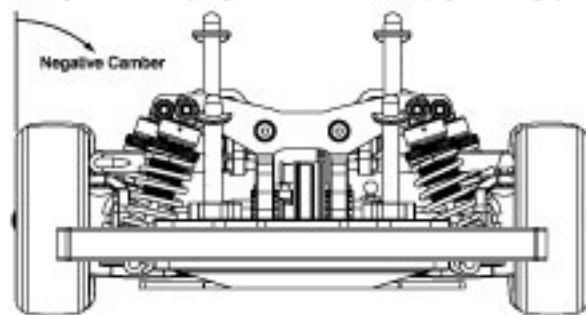

### FRONT TOE-IN (Out-board)

The front toe-in is set by adjusting the steering trackrod turnbuckles.

Toe-In = A less than B  
Toe-Out = A greater than B

Toe-in will give a more stable car, but will give less sharp turn in. Toe-out will give the opposite, less stability with sharper turn in to the corners. We recommend to start at about 0° or 1° toe-out.

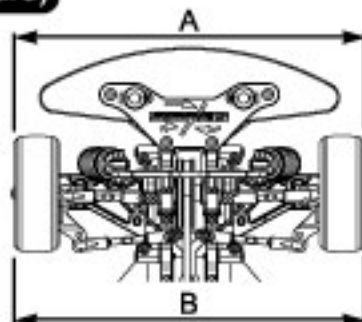

### FRONT AND REAR TRACK WIDTH

TRACK WIDTH ADJUSTMENT (In-board)

The track width of the car may be altered by adding or removing equal thickness grey suspension washers between the Screw blocks and the transmission housings. When changing the track width ensure the driveshafts are fully engaged in the Diff outputs. And the width does not exceed 190mm

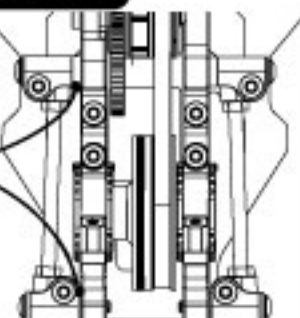

### FRONT AND REAR WHEELBASE

WHEELBASE ADJUSTMENT (In-board)

The wheelbase may be adjusted by moving the Qwik clips to either the front or the back of the wishbones. This alters the front to rear weight Balance of the car.

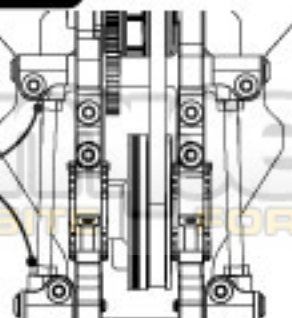

### FRONT AND REAR INBOARD TOE-IN

TOE IN (In-board)

The toe-in is set by adding or removing the grey suspension washers between the Screw blocks and the transmission housings, at the front or rear of the wishbones. Each 0.50mm washer will change the Toe in by Approx 0.6°

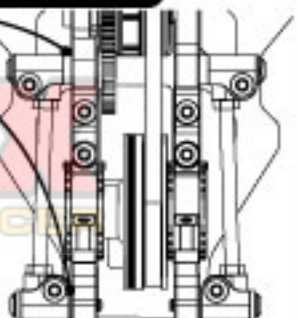

**BATTERY OPTIONS**

5 Cell (With Strap or Tape)

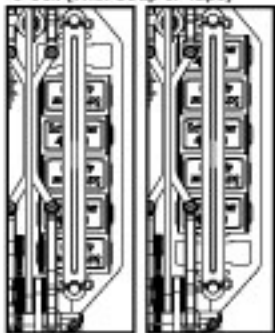
**BATTERY OPTIONS**

4 Cell (With Strap or Tape)

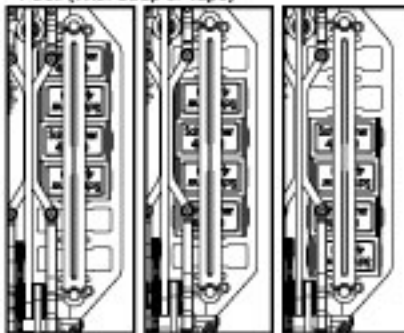
**Track Settings****GEAR CHART 48Dp**

Maximum Tooth Sum = 121.....Minimum Tooth Sum = 91.....Internal Ratio = 1.8:1

	14	15	16	17	18	19	20	21	22	23	24	25	26	27	28	29	30	31	32	33	34	35	36	37	38	
89	11.44	10.66	10.01	9.42	8.90	8.43	8.01	7.63	7.28	6.97	6.68	6.41	6.16	5.93	5.72	5.52	5.34	5.17	5.01							
87	11.18	10.44	9.79	9.21	8.70	8.24	7.83	7.46	7.12	6.81	6.53	6.26	6.02	5.80	5.59	5.40	5.22	5.05	4.89	4.75	4.61					
85	10.92	10.20	9.56	9.00	8.50	8.05	7.65	7.29	6.95	6.65	6.38	6.12	5.88	5.67	5.46	5.28	5.10	4.94	4.78	4.64	4.50	4.37	4.25			
70								6.00	5.73	5.48	5.25	5.04	4.85	4.67	4.50	4.34	4.20	4.06	3.94	3.82	3.71	3.60	3.50	3.41	3.32	
66												4.75	4.57	4.40	4.24	4.10	3.96	3.83	3.71	3.60	3.49	3.39	3.30	3.21	3.13	

**GEAR CHART 64Dp**

Maximum Tooth Sum = 161.....Minimum Tooth Sum = 121.....Internal Ratio = 1.8:1

	19	20	21	22	23	24	25	26	27	28	29	30	31	32	33	34	35	36	37	38	39	40	41	42	43	44	45	46	47	48	49	50
118	11.18	10.62	10.11	9.65	9.23	8.85	8.50	8.17	7.87	7.58	7.32	7.08	6.85	6.64	6.44	6.25	6.07	5.90	5.74	5.58	5.44	5.31	5.18	5.05	4.93							
116	10.99	10.44	9.94	9.49	9.08	8.70	8.35	8.03	7.73	7.46	7.20	6.96	6.74	6.53	6.33	6.14	5.97	5.80	5.64	5.49	5.35	5.22	5.09	4.97	4.85	4.75	4.64					
114	10.80	10.26	9.77	9.33	8.92	8.55	8.21	7.89	7.60	7.33	7.08	6.84	6.62	6.41	6.22	6.04	5.88	5.70	5.54	5.40	5.26	5.13	5.00	4.88	4.77	4.66	4.56	4.46	4.37			
108	10.04	9.54	9.08	8.67	8.30	7.95	7.63	7.34	7.07	6.81	6.58	6.36	6.15	5.96	5.78	5.61	5.45	5.30	5.16	5.02	4.89	4.77	4.65	4.54	4.44	4.34	4.24	4.15	4.06	3.98	3.89	3.82
96						6.91	6.65	6.40	6.17	5.96	5.76	5.57	5.40	5.24	5.08	4.94	4.80	4.67	4.55	4.43	4.32	4.21	4.11	4.02	3.93	3.84	3.76	3.68	3.60	3.53	3.46	
90												5.23	5.06	4.91	4.76	4.63	4.50	4.38	4.26	4.15	4.06	3.96	3.86	3.77	3.68	3.60	3.52	3.45	3.38	3.31	3.24	

**FRONT INBOARD PIN OPTIONS****ROLL CENTRE ADJUSTMENT**

By adding or removing the Grey Suspension washers between the pivot blocks you are able to change the height of the roll centre.

**KICK UP OR ANTI-DIVE**

By adding the Grey Suspension washer at the front of the wishbone you will get anti-dive. 0.5mm = 0.5°

By adding the Grey Suspension washer at the rear of the wishbone you will get kick-up. 0.5mm = 0.5°

**REAR INBOARD PIN OPTIONS****ROLL CENTRE ADJUSTMENT**

By adding or removing the Grey Suspension washers between the pivot blocks you are able to change the height of the roll centre.

**SQUAT OR ANTI-SQUAT**

By adding the Grey Suspension washer at the rear of the wishbone you will get Anti-Squat. 0.5mm Difference = 0.5°

By adding the Grey Suspension washer at the front of the wishbone you will get Pro-Squat. 0.5mm Difference = 0.5°

**DIFF HEIGHT (HIGH OR LOW)****DIFF HEIGHT**

Diff height adjustment is provided so that the car may run level driveshafts at ride height with different diameter tyres.



www.racing-cars.com

**FRONT AND REAR SUSPENSION LINK****(Roll Centre)****HEIGHT ADJUSTMENT**

The height of the inboard suspension link can be altered by adding or removing the violet spacer washers, between the link mount and the ball stud.

**WIDTH ADJUSTMENT**

The width of the inboard suspension link can be altered by adding or removing the Grey suspension washers, between the link mount and the Transmission housings.

**ELECTRIC - TOURING CARS**

K080	MI-3.5 Pro-CF - 1-10 4WD Trg 6 cell
K081	MI-3.5 Pro-CF - 1-10 4WD Trg 5 Cell
K082	MI-3.5 Race-S1 - 1-10 4WD Touring Car

**CHASSIS PARTS**

U1042	Aerial Mount - Universal
U119	Aerial Tube - Pack 4
U2244	Servo Mounts (pr)
U2280	SpeedFlex Rr Belt5mm - C3K
U2989	Ball Grippa Sockets - (pk 8)
U3145	CF Chassis - 2.0mm Kit - MI-3
U3150	CF Shock Bkt; Front - MI-3 Kit
U3151	CF Shock Bkt; Rear - MI-3 Kit
U3154	Foam Bumper - MI-3
U3155	Front Bumper Mouldings - MI-3
U3158	Alloy Body Post Block; Horizontal Mount - MI-3 (pr)
U3159	Alloy Body Post Block; Vertical Mount - MI-3 (pr)
U3271	CF LiPo Battery Locator (pr)
U3272	CF 2008 Euro Chassis - 5 cell - MI-3
U3273	CF 2008 Euro Top Deck - MI-3
U3274	CF 2008 Flex Top Deck - MI-3
U3278	Chassis; S1 6 cell - MI3.5
U3279	Top deck; S1 - MI3.5
U3280	Shock Bracket; Front S1 - MI3.5
U3281	Shock Bracket; Rear S1 - MI3.5
U3282	Steering Post Set - MI-3.5 S1
U3283	Instr Manual - MI-3.5

**BODYSHELLS & DECALS**

EC16283121	East Coast - Body; 1x250 190mm
EC16283122	East Coast - Body; Euro-R 190mm
EC16283123	East Coast - Body; 320x1 190mm
EC16283126	East Coast - Body; Speed 6 190mm
EC16283129	East Coast - Body; Evo9x 190mm
EC16283212	East Coast - Body; Euro-R 200mm
EC162832D6	East Coast - Body; 350x2 190mm
EC162832D8	East Coast - Body; RX7 190mm
EC162832D9	East Coast - Body; S15 190mm
EC38826B	East Coast - Half Paint; Blue; Speed 6 190mm
EC38826R	East Coast - Half Paint; Red; Speed 6 190mm
U3167	Decal Sheet - MI-3 (pk3)

**SUSPENSION**

U1430	Tumbuckle Adjuster - 39mm (pr)
U1440	Pro Pin; grooved 1/8x25mm (pr)
U2654	Steering Yoke Pivot Set - 2 pairs
U2718	Pro Pin; Grooved 1/8x18mm (pr)
U2722	Ball Grippa Joints - U/S Stud 4prs
U2736	Steering Yoke; 2 degree - MI-2 pr
U2737	Steering Yoke; Kit Std 4 degree - MI-2 pr
U2738	Steering Yoke; 6 degree - MI-2 pr
U2750	Droop Screw; M5x8mm pk4
U2882	Servo Saver Set; Light & Heavy Springs
U2990	Front Hub Carrier - MI2 E.C.
U2991	Purple Alloy Wheel Hex; Slim (pr)
U2992	Rear Hub Carrier - MI2 E.C./MI-3
U3127	Wishbones; Graphite Front - MI-3
U3128	Wishbones; Graphite Rear - MI-3
U3129	Alloy Block; Screw - MI-3 (pr)
U3130	Alloy Block; Pivot - MI-3 (pr)
U3133	Alloy Top Link Mount - MI-3 (pr)
U3134	Steering Post Set - MI-3 CF
U3135	Centre Track Rods; Set 7 - MI3
U3137	Shock Mounting Post - MI-3 (pr)
U3142	Pro Pivot Pin - 55mm - MI-3 (pr)
U3249	Wishbones; Med Flex Front - MI-3
U3250	Wishbones; Medium Flex Rear - MI-3
U3251	Wishbones; Extra Flex Front - MI-3
U3252	Wishbones; Extra Flex Rear - MI-3
U750	Ball Grippa Joints-Short Stud 8prs
U796	Tumbuckle Adjuster - 24mm (pr)
U797	Tumbuckle Adjuster - 35mm (pr)
U851	Ball Grippa Joints - Long Stud 8prs

**TRANSMISSION**

U1895	M3x8mm Button Screws & Washers pk4
U1918	Spare Blades
U2573	Pro-Diff Screw Set
U2721	Rear Belt; Black Narrow - MI-2
U2733	Diff Pulley Fences - MI-2 & 3
U2746	CNC Diff Pulley - 4mm
U2761	Diff Shims; 10 x 12
U2797	CNC Spool Assy; Lightweight - MI-2
U2798	CNC Spool Pulley - MI-2
U3011	Front Belt; 171t x 3.6mm
U3012	Front Belt; Grey Stock 171t x 3.6mm
U3013	Rear Belt; Grey Stock - MI-2 E.C.
U3026	Pivot; Pin & Screw; Alloy CV D/Shaft
U3123	Alloy Eccentric - MI-3 (pr)
U3124	Diff Retaining Post - MI-3 (pr)
U3125	Layshaft Post - MI-3
U3126	CNC Pulley & Fences; 20T - MI-3
U3138	Alloy Diff Output; Male - MI-3
U3139	Alloy Diff Output; Female - MI-3
U3140	Diff Washer; ProSpec - MI-3 (pr)
U3141	HD Spool Output - MI-3
U3160	85T 48DP CNC Spur Gear - MI-3
U3161	87T 48DP CNC Spur Gear - MI-3
U3162	89T 48DP CNC Spur Gear - MI-3
U3163	114T 64DP CNC Spur Gear - MI-3
U3164	116T 64dp CNC Spur Gear - MI-3
U3165	118T 64dp CNC Spur Gear - MI-3
U3170	Pins & Shims; Axle - MI-3 4pr
U3223	Diff; Fully Assembled Ceramic - MI3
U3225	CNC Spool Assembly HD - MI-3
U3234	Axle; Alloy CV Drive shaft 1pc
U3247	70T 48DP CNC Spur Gear - MI-3
U3248	96T 64dp CNC Spur Gear - MI-3
U3256	Alloy 7075 T6 Diff Mount; Front Left - MI-3
U3257	Alloy 7075 T6 Diff Mount; Front Right - MI-3
U3258	Alloy 7075 T6 Diff Mount; Rear Right - MI-3
U3259	Alloy 7075 T6 Diff & Motor Mount - MI-3
U3260	Ti Shock Post - MI-3 pr
U3261	Ti Droop Screw - MI-3 pk4
U3262	Ti Lay Post - MI-3
U3267	Driveshafts; Heavy Duty - MI3 (pr)
U3269	90T 64DP CNC Spur Gear - MI-3
U3270	106T 64DP CNC Spur Gear - MI-3
U3275	Bone; 7075 Alloy Driveshaft - MI3 1pc
U3276	Axle; HD Steel - MI3 1pc
U3400	66T 48DP CNC Spur Gear - MI-3

**SHOCK ABSORBERS**

U2993	Race Shock Body; Nickel Teflon (pr)
U2994	Race Shock Collar; threaded adjuster (pr)
U2995	Race Shock Piston - Trg 2 Hole (pr)
U2996	Race Shock Piston - Trg 3 Hole (kit std) pr
U2997	Race Shock Rod; Ti-Nitride - 30mm (pr)
U2998	Race Shock Seal Housing; On Road (pr)
U2999	Race Shock Seal Rebuild Pack (pr)
U3001	Race Shocks; fully assembled pair
U3284	Race Shock Top Cap (pr) - Black Unversed
U613	Spring Stop & Spacer Mouldings (pr)

**SHOCK OIL**

G030	Pure Silicone Shock Oil - 30w
G035	Pure Silicone Shock Oil - 35w
G040	Pure Silicone Shock Oil - 40w
G045	Pure Silicone Shock Oil - 45w
G050	Pure Silicone Shock Oil - 50w
G055	Pure Silicone Shock Oil - 55w
G060	Pure Silicone Shock Oil - 60w
G070	Pure Silicone Shock Oil - 70w
G080	Pure Silicone Shock Oil - 80w
G100	Pure Silicone Shock Oil - 100w

**SPRINGS**

U2822	Spring Tuning Set - Pro-Touring (6 prs)
U2823	Pro-Touring Springs - White 14 lbs
U2824	Pro-Touring Springs - Blue 16 lbs
U2825	Pro-Touring Springs - Green 18 lbs
U2826	Pro-Touring Springs - Red 20 lbs
U2827	Pro-Touring Springs - Yellow 23 lbs
U2828	Pro-Touring Springs - Violet 27 lbs

**BEARINGS & BALLS**

G200	ZX1 - Microlube
H1031	Bearing Blaster Aerosol 500ml
U1301	Silicone Diff Lube - Pot
U1439	Ball Bearing - 5 x 9 x 3 Non Fl. (pr)
U1954	Pro - Thrust Bearing
U1957	Moly Axle Grease - Pot
U2148	Ball Bearing - 5 x 10 x 4 Shielded (pr)
U2189	Wheel Bearings 8pcs 10x5x4 Shim Set
U2459	Diff Balls; T/C 2.5mm pk12
U2574	Ball Bearing - 5 x 9 x 2.5 (pr)
U2862	Ceramic Bearing - 5x10x4 Shielded (pr)
U3016	Ball Bearing - 10x15x4 (pr)
U3017	Ceramic Bearing - 10x15x4 (pr)
U3019	Ceramic Nitride Diff Balls 2.5mm (pk12)
U3136	Ball Bearing - 5 x 8 x 2.5 (pr)
U3171	Ceramic Bearing set - MI-3

**SPEED PACKS**

CR035	CORE RC - Serrated Alloy M4 Nuts; Blue pk 4
CR036	CORE RC - Serrated Alloy M4 Nuts; Purple pk 4
H1010	Body Clips - Fluorescent Yellow (pk10)
H1011	Body Clips - Fluorescent Green (pk10)
H1012	Body Clips - Fluorescent Red (pk10)
H1013	Body Clips - Metallic Red (pk10)
H1014	Body Clips - Metallic Blue (pk10)
H1015	Body Clips - Metallic Purple (pk10)
U1547	SPEED PACK - M3 Nuts
U1548	SPEED PACK - M3 Washers
U1549	SPEED PACK - M4 Nuts & Washers
U1550	SPEED PACK - Socket Wrenches (pk3)
U1551	SPEED PACK - E Clips 2x8pcs
U1552	SPEED PACK - R Clips
U1606	SPEED PACK - Servo Tape
U1633	SPEED PACK - Small Pins (pk)
U1960	SPEED PACK - O Rings; Various
U2128	SPEED PACK - Grub-Set Screws M3 M4
U2631	SPEED PACK - Circlips Various 12 pcs
U2760	SPEED PACK - M3 Button Hd; 4 to 20
U2858	Alloy M3x6 Spacer Set; 0.5; 1; 2; 3mm - 16pcs
U2988	M3 Csk Washers - Purple Alloy (pk10)
U3002	Wheel Spacer Washers (pk10)
U3021	SPEED PACK - M3x6 Csk Allen Hi-T
U3022	SPEED PACK - M3x8 Csk Allen Hi-T
U3023	SPEED PACK - M3x10 Csk Allen Hi-T
U3024	SPEED PACK - M3x12 Csk Allen Hi-T
U3131	Alloy Spacers M3x7mm 0.5; 1; 2mm (pk18)
U3168	SPEED PACK - M2.5 Screws pk 10

**TOOLS**

AT1142	ATS Set Up Gauges - 1/10th Touring
H1009	Lexan Scissors; curved
H1032	Alloy Camber Gauge - 1/10th
SPCF-MP001	Carbon Fibre Pit Mat; Black 58x76cm
SPCF-SB001	C/F Set Up Board; Silver 33x43cm
U2789	Schumacher Hex Driver - 1.5mm
U2790	Schumacher Hex Driver - 2.0mm
U2791	Schumacher Hex Driver - 2.5mm
U2792	Schumacher Hex Driver - 3.0mm
U2795	Schumacher M3 Nut Driver
U2796	Schumacher M4 Nut Driver
U2818	Schumacher Body Reamer

**ELECTRONICS**

G837	Mini Temp Gun - 420F 230C
G848	Tyre Warmers 1/10 Trg 7.2-12v

**SPEEDCONTROLS**

SPEXTR98801	Speed Passion - BL ESC; GT 2.5T
SPEXTR98801LPF	Speed Passion - BL ESC; LFP 5.5T

A WEB SITE FOR THE SERIOUS RACER

