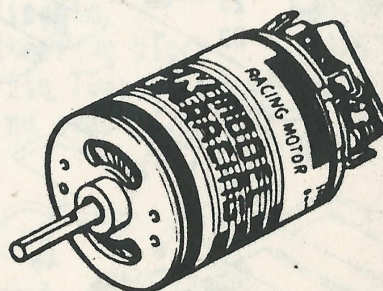
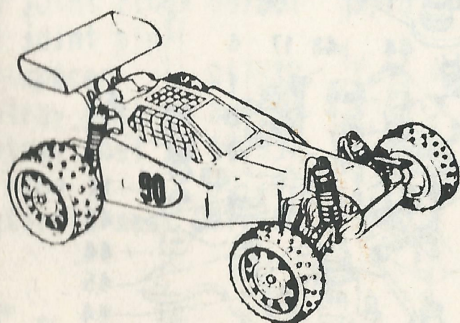
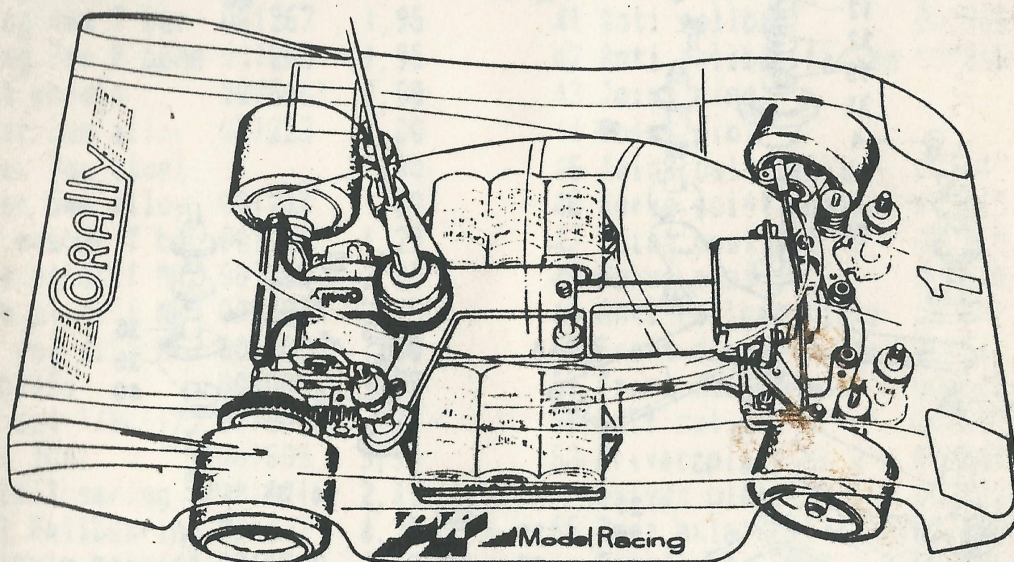
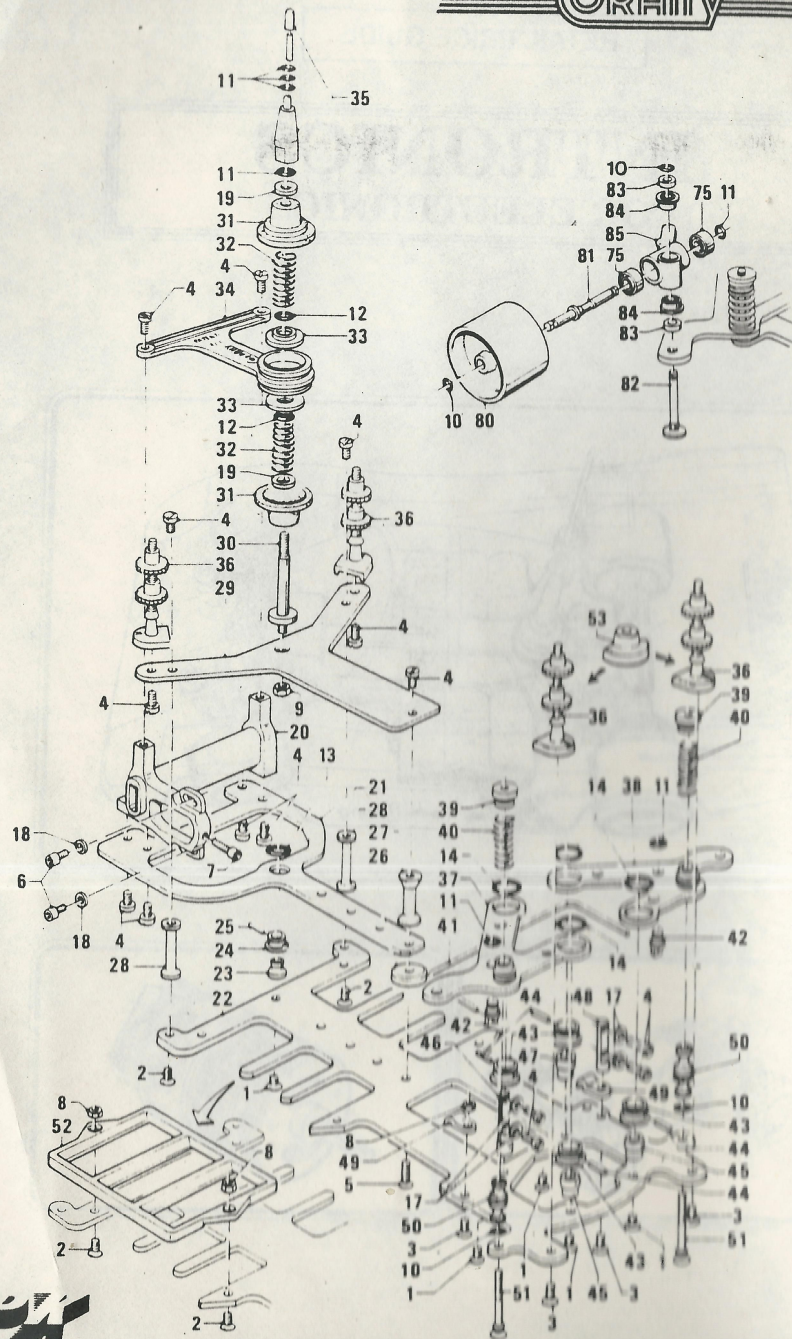


RETAIL PRICE GUIDE

INTRONICS FOR ELECTRONICS



SEPTEMBER 1990

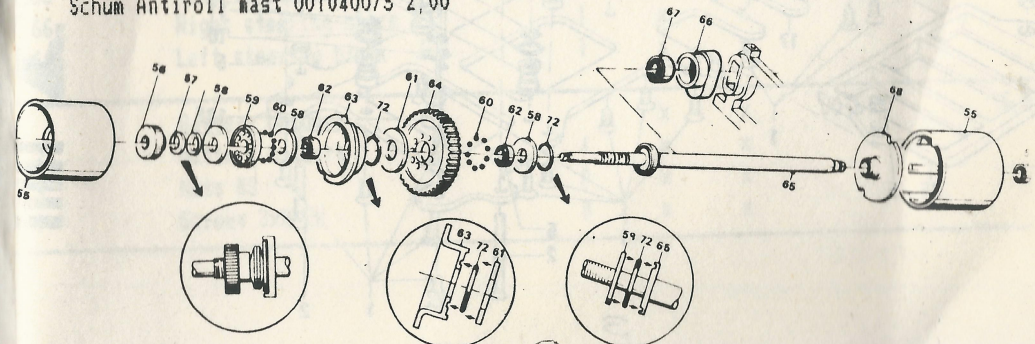


CORALLY SP11 SPARE PARTS.

1	Screw 3x5v	001232	.80
2	Screw 3x6v	001234	.80
3	Screw 3x8v	001233	.80
4	Screw 3x6	001235	.80
	Screw 3x16	001238	.80
5	Screw 3x10v	001231	1.95
6	Screw 3x6a	001242	.80
7	Screw 3x12a	001241	.80
8	Nut 3mm	001256	.90
	Stop nut 3mm	001255	.95
	Nut 4mm	001257	.80
9	Nut 5mm	001258	.95
10	O ring 2mm	001260	1.95
11	O ring 3mm	001261	1.95
12	O ring 5mm	001262	1.95
	O ring 3x3	001263	.95
	O ring 17mm	001265	1.95
72	O ring 12mm	001266	.95
13	O ring 4mm T bar	001267	1.95
14	O ring 7mm W bone	001268	1.95
	Clip set wheels	0076061	2.50
17	Washer 3mm alloy	001223	.80
18	Washer 3mm steel		.00
19	Washer 5mm alloy	001224	.80
	Cone washer T bar	001225	1.29
	Spare pt diff Mk2	001003	2.95
	Spare pt diff Mk1	001004	2.75
	Ball set diff Mk3	001008	1.50
	3mm balls	001009	.55
	Ball set 1/8 (12)	0010091	.75
	Trick Tool	001609	9.95
75	5x9 Ballbearing	001121	2.45
84	4x7f1 Ballbearing	001122	4.95
	7x11 axle bearing	0011260	2.60
20	Motorpod	007515	24.95
21	T-bar SP11	007520	14.95
22	Chassis SP11	007500	23.95
23	T-bar joint post>		
24	T-bar joint ring>	007601	3.75
25	T-bar joint pin>		
26	T-bar spacer	007528	1.95
27	Radiotray post sh	007530	2.00
28	Radiotray post lo	007531	5.95
	Ball cage	007591	1.95
	Schum Antiroll mast	0010400/S	2.00

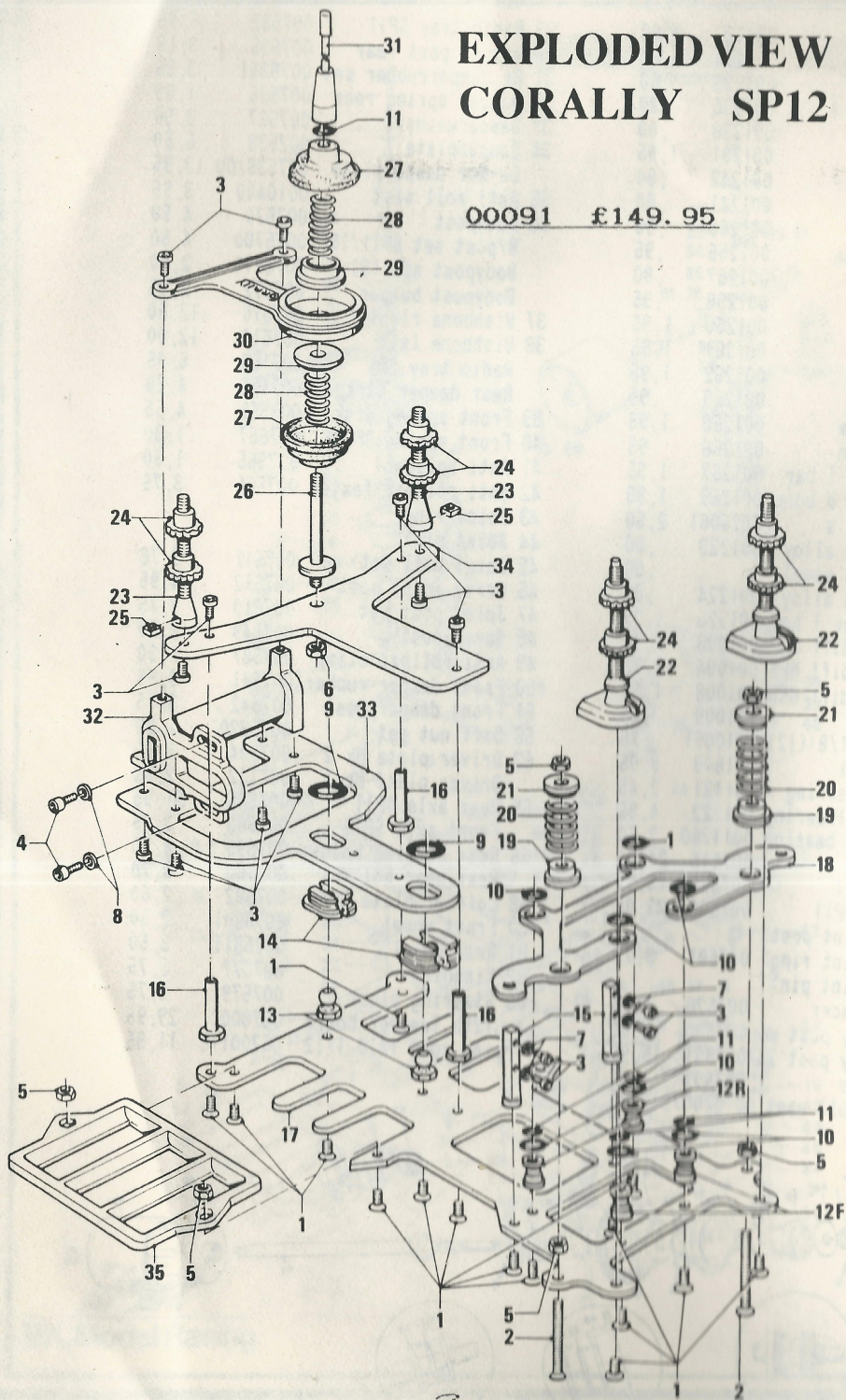
CORALLY SP11 SPARE PARTS.

29	Radio tray SP11	007532	6.95
30	Damper post rear	007535	3.15
31	Rr damperrubber set	0075351	3.95
32	Damper spring rear	007536	1.09
33	Damperwasher	007537	3.50
34	Damperplate	007538	6.50
	Du-Mor damperplate	007538/DU	13.95
35	Anti roll mast	0010400	3.95
36	Bodypost	007570	4.50
	B/post set SP11/12	0075700	4.50
	Bodypost nut (8)	0075710	2.50
	Bodypost bumper	007572	2.95
37	Wishbone right	007510	12.50
38	Wishbone left	007512	12.50
	Radio tray SP1	007169	6.95
	Rear damper strap	007170	4.70
39	Front spring disk	007555	4.55
40	Front spring SP11	007557	1.30
41	Anti rollbar	007565	1.30
42	Anti rollbar fasten	007566	3.75
43	Joint ring>		
44	Joint pin>		
45	Joint ball set>	007611	3.75
46	Servo joint post	007612	4.95
47	Joint post set	007610	3.75
48	Servo post	007549	2.60
49	Anti rollbar clamp	007567	1.30
50	Front damper rubber	007541	3.95
51	Front damper post	007542	3.75
56	Diff nut set	0075920	1.50
63	Driver plate Mk 2	007584	2.95
	Driver plate Mk 1	007122	2.85
65	Rear axle SP11	007586	21.95
	Front axle SP11	007585	3.95
66	Rear bearing holder	007593	4.70
	Rear bear hol Mk1	007160	4.70
68	Left w/ plate SP11	007582	2.60
80	Front wheel	0075801	2.50
81	Rear wheel	0075811	3.50
82	Kingpin	007577	3.75
85	Steering block	0075791	3.75
	12th Tweaker board	067000C	29.95
	Truing adap 1/10 1/12	0670011C	11.95



EXPLODED VIEW CORALLY SP12

00091 £149.95



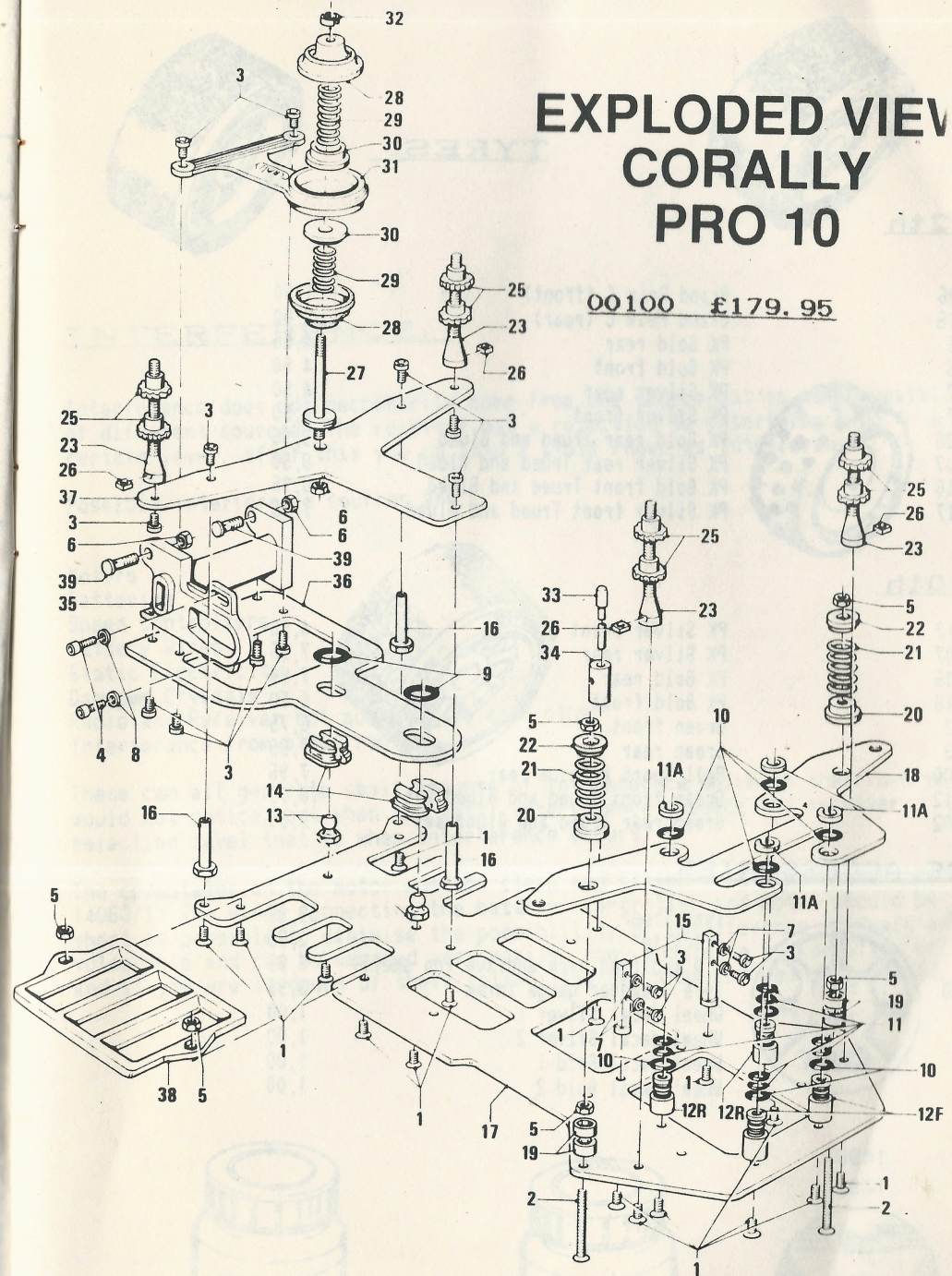
Item No	Description	Qty	SP12	SP10	Part No	Price
	<u>Damper set</u>		x	x	0075351	3,95
7	Damper rubbers	2	x	x		
8	Damper springs	2	x	x		
9	Damper washers	2	x	x		
10	<u>Damper plate</u>	1	x	x	0075380	6,50
11	<u>Anti roll mast</u>	1	x		0010400	3,89
12	<u>Motor pod</u>	1	x		0075151	26,95
13	<u>T-bar</u>	1	x		0075201	12,95
14	<u>Radio tray</u>	1	x		0075321	7,95
	<u>Pivot set front beam</u>		x		0075061	2,95
11a	Front pivot clips	2		x	0175065	2,95
12f	Front beam pivot long	1	x			
12r	Front beam pivot short	1	x			
10	O rings 5mm	4	x	x		
11	O rings 3mm	4	x	x		
1	Screws 3x8 FH	2	x	x		
60	Front wheels	2	x		0075801	2,50
60	Front wheels	2		x	0175805	3,95
61	Front wheel axle	1	x		0075851	3,95
63	King pin	1	x	x	0075770	3,75
64	King pin shims				see spare screw set	
65	Clips 2mm				see clip set	
66	<u>Steering blocks</u>		x	x	0075791	3,75
66r	Right steering block	1	x	x		
66l	Left steering block	1	x	x		
	<u>Battery holders</u>		x	x	001617	6,50
35	Battery holders	4	x	x		
5	Nuts M3	8	x	x		
1	Screws 3x8 FH	8	x	x		

View No	Description	Qty	SP12	SP10	Part No	Price
	<u>Body post front</u>		x		0075700	4,50
22	Body post front	2	x			
24	Body post nuts	4	x			
1	Screws 3x8 FH	2	x			
	<u>Body post 50mm</u>		x	x	0075701	4,50
23	Body post 50mm	2	x	x		
24	Body post nuts	4	x	x		
25	Body post inserts	2	x	x		
1	Screws 3x8 FH	2	x	x		
3	Screws 3x6 RH	2	x	x		
	<u>Body post 65mm</u>		x	x	0075702	4,50
	Body posts 65mm	2	x	x		
24	Body post nuts	4	x	x		
25	Body post inserts	2	x	x		
1	Screws 3x8 FH	2	x	x		
3	Screws 3x6 RH	3	x	x		
	<u>Body post 80mm</u>		x	x	0075703	4,50
	Body post 80mm	2	x	x		
24	Body post nuts	4	x	x		
25	Body post inserts	2	x	x		
1	Screws 3x8 FH	2	x	x		
3	Screws 3x6 RH	2	x	x		
24	<u>Body post nuts</u>	8	x	x	0075710	2,50
26	<u>Damper post</u>	8	x	x	0075350	3,50
	<u>Servo post set</u>		x	x	0075491	2,95
15	Servo post	2	x	x		
1	Screws 3x8 FH	2	x	x		
3	Screws 3x6 RH	4	x	x		
7	Washers 3mm alloy	4	x	x		
	<u>Diff nut set</u>		x	x	0075920	1,50
43	Diff nut	1	x	x		
44	Cone washer	1	x	x		

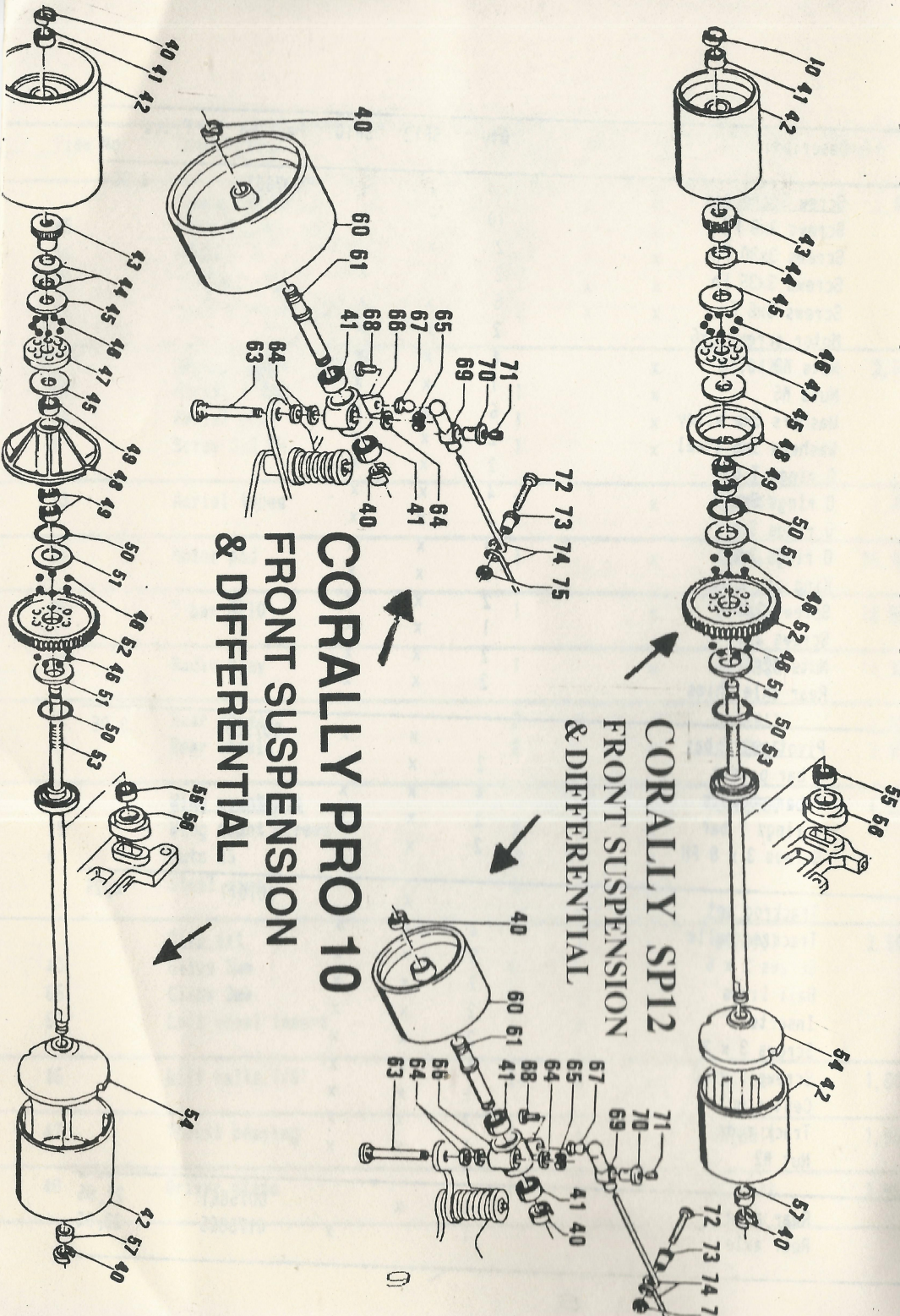
View No	Description	Qty	SP12	SP10	Part No	Price
	<u>Radio tray post set</u>		x	x	0075301	4,95
16	Radio tray posts	3	x	x		
1	Screws 3x8 FH	3	x	x		
3	Screws 3x6 RH	3	x	x		
17	Chassis SP12	1	x		0075001	22,50
18	Front Beam SP12	1	x		0075051	12,50
17	Chassis SP10	1		x	0175005	29,95
18	Front Beam SP10	1		x	0175055	14,95
	<u>Spring set</u>		x	x	0075570	3,75
	Front beam spacers	4	2	4		
19	Spring stop (bottoms)	2	x	x		
20	Springs	2	x	x		
21	Springs stops (top)	2	x	x		
2	Screws 3x25 FH	2	x			
2	Screws 3x30 FH	2		x		
5	Nuts M3	4	x	x		
57	Left wheel insert		x	x	see clip set	
54	Left hand wheel plate	1	x		0075821	2,60
54	Left hand wheel plate	1		x	0175825	2,95
55	Ball bearing 7 x 11	2	x	x	0011260	
56	Bearing holders	6	x	x	0075930	4,50
41	Ball bearing 5 x 9	2	x	x	001121	2,45
49	Ball bearing 1/4 x 3/8	2	x	x	001124	
	<u>Trackrod set</u>			x	011018	4,50
67	Trackrod balls	2		x		
68	Screws 2 x 6	2		x		
69	Ball links	2		x		
70	Inserts	2		x		
71	Screws 3 x 3	2		x		
72	Screws 2 x 10	1		x		
73	Centre nut	1		x		
74	Trackrods	2		x		
75	Nut M2	1		x		

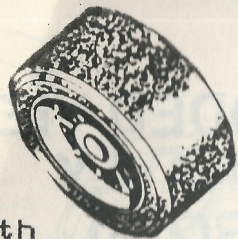
EXPLODED VIEW CORALLY PRO 10

00100 £179.95

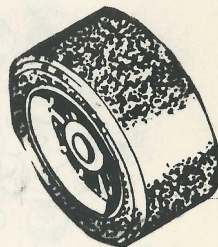


CORALLY PRO 10 FRONT SUSPENSION & DIFFERENTIAL





TYRES.



1/12th

0911406	Grand Prix C (front)	1.50
0911416	Grand Prix C (rear)	2.00
091406	PK Gold rear	4.50
091416	PK Gold front	4.50
091407	PK Silver rear	4.50
091417	PK Silver front	4.50
0914506	PK Gold rear Trued and Glued	9.95
0914507	PK Silver rear Trued and Glued	8.50
0914516	PK Gold front Trued and Glued	8.95
0914517	PK Silver front Trued and Glued	7.95



1/10th

0914217	PK Silver front	4.95
0914207	PK Silver rear	7.95
0914206	PK Gold rear	7.95
0914216	PK Gold front	5.50
095912	Green front.	6.75
095913	Green rear	7.95
0914800	Bell Sport Premium rear	7.95
0914612	Green front Trued and Glued set	10.75
0914602	Green rear Trued and Glued set	9.95

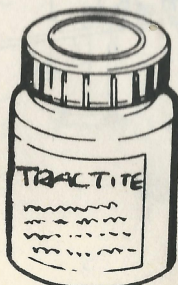


TYRE ACCESSORIES.

093000	Tyre Truer	59.95
15021	Tractite	2.95
15023	T.Q modified tyre additive (no smell)	5.95
096000	Tyre diameter gauge in/mm	3.95
1490	Wheel decal Silver 1	1.00
1491	Wheel decal Silver 2	1.00
1492	Wheel decal Gold 1	1.00
1493	Wheel decal Gold 2	1.00



1490
1492



INTERFERENCE.

Interference does not necessarily come from one source but is an accumulation of different sources. The receiver has a rejection to interference up to a certain level, after this you go into a state known as interference.

Possible interference sources are:-

- Motors
- Batteries
- Speed Controllers
- Battery Wires
- Static Electricity
- Damaged Crystals
- Radio and Receiver not adjusted to each other
- Interference from other radios

These can all generate small amounts of interference which on their own you would not notice, but when the total interference exceeds the receiver rejection level that is when interference occurs.

The commutator on the motor must be clean and fitted with capacitors (part 14063/I). The wires connecting the battery, controller and motor should be short as possible to minimise the possibility of interference. Crystals are vulnerable and can be damaged very easily, they should be looked after well and if you are in doubt of their reliability get them checked or replaced.

MOTORS AND ACCESSORIES.

14010	Intronics 35 turn motor	13.50
14011	Intronics 27 turn motor	14.50
14011/P	Parma Cyclone 27 turn single motor	15.00
14012/	Intronics Modified 1/10/12	39.95
14013	Demon Modified motor	29.95
14014/6	LRP motor green SCE	55.00
14014/Y	LRP motor yellow SCE	55.00
14014/R	LRP motor red SCE	55.00
14015/15D	PK Modified motor	39.95
14015/19D	PK Modified motor	39.95
14015/23D	PK Modified motor	39.95
14016/26D	Twister motor	39.95
14016/27D	Twister motor	39.95
14016/27Q	Twister motor	39.95
14020/16D	Armature	15.00
14020/17D	Armature	15.00
14020/18Q	Armature	15.00
14020/19D	Armature	15.00
14020/19S	Armature	15.00
14020/20Q	Armature	15.00
14020/20TR	Armature	15.00
14020/21D	Armature	15.00
14020/21TR	Armature	15.00
14020/22D	Armature	15.00
14020/23Q	Armature	15.00
14020/26D	Armature	15.00
14025	Modified motor can	15.00
14026	Mod motor can wet	20.00
14040	Shinwa rolling road	99.95
14041	Shinwa motor dresser	59.95
14041/M	Shinwa motor dresser magnet	4.95
14042	Shinwa torque tester	49.95
14044	Motor endbell retaining plate	0.50
14045	Mod endbells slot gear	12.95
14046	Mod endbells Demon	12.95
14047	Slot brushes	2.95
14048	Slot springs	1.50
14049	Motor brushes std (med)	1.95
14050	Motor brushes hard	1.95
14050/LRP	LRP motor brushes	3.25
14051	Motor springs	0.75
14051/LRP	LRP motor springs	1.75
14052	Motor cooling plates	2.95
14053	Double shunt brushes soft	2.50
14054	Double shunt brushes hard	2.50
14056	Motor tubs Parma	1.45
14057	Armature tubs	0.30
14061	Motor Case	14.95
14063	Motor capacitors	1.00
14063/T	Capacitor kit Trinity	1.95
14064	Heavy current wire	2.50
14065	Aerosol cleaner	3.50
14067	Motor additive (Rev Tech)	2.95
101600	Commutator tool kit	



THE PROFESSIONAL WAY TO RUN A RACE MEETING

RACE CONTROL is a PC/XT/AT (or compatible) based program designed to provide complete facilities for the administration and efficient running of model car race meetings.

The race organiser starts by inputting details of all the competitors entered for a meeting. It is possible to generate any number of entrants files from club membership lists or the entrants file from a previous meeting and then to use one of these as the basis for this operation. Heats are organised according to BRCA, OPEN or EFRA rules as required and then racing can commence. The manual version of **RACE CONTROL** needs a key press for each car as it crosses the line so that **RACE CONTROL** can log the lap time. The automatic version takes its signals from the AMB Lap Scoring System although a key press can still be used should it be found that a car is not being recorded for some reason. Results of each heat are stored to disc automatically at the end of each race. This can be followed by an automatic print-out of results and/or lap times if required. At any time through the running of the heats, corrections to existing results can be made or a 'best-times-to-date' list can be generated. Once the heats are completed the finals can be automatically sorted after which the finals themselves can be run. Results of all races are available on disc at any time for inspection on screen or for a print out if required.

The Automatic version of RACE CONTROL

We have used the AMB system including its own PC interface card for the automatic version of RACE CONTROL. The AMB system is a well tried and tested system, proven to be efficient and reliable over the years. It is our policy not to attempt to re-invent the wheel - if such a system exists, then we stick with it!

Just some of the facilities offered by RACE CONTROL

Operates under BRCA, OPEN or EFRA rules.

BRCA rules: Formulae 1,2,3 and 4 are catered for. Each formula can race with either of two different race duration times if required. Heats are organised according to the formula and rating of each entrant. Finals are sorted according to the entrant's best result obtained in any number of rounds but still segregating the four formulae.

OPEN rules: Heat organisation is performed according to the entrant's Expert, Intermediate or Novice rating. Finals are sorted purely on the basis of each entrant's best result obtained during the Heats.

EFRA rules: As entrants do not have a rating which can be used as the criteria for heat organisation, the heats are constructed manually at the keyboard by picking an entrant from the list displayed on screen and placing him/her in a heat. If required the entrant can be removed from a heat and returned to the list. As with OPEN meetings, finals are sorted automatically according to the best results obtained during the heats.

Automatic input from AMB system and/or manual keyboard input

Normal or staggered starts.

Race start signal from keyboard or external lights (external lights option available with automatic version of RACE CONTROL only).

Wide range of print out information available.

Entrants list.

Entrants in Heat/Final - either any individual group or all of them.

Heat/Final results - again, either any individual race or all of them.

Individual lap times for Heats/Finals.

List of 'best-times-to-date' for all entrants.

Race screen gives full range of information for use by a commentator including race laps, times and position for each entrant, race time elapsed, fastest competitor and lap time for the current race as well as the overall lap record holder and their time for meeting as a whole etc. etc.

Answers to a few commonly asked questions

We don't have an AMB system, can we still use RACE CONTROL? - Yes. You need the manual version. If you decide to buy an AMB system at a later date, an upgrade will cost you the difference between the manual and automatic versions of RACE CONTROL current at the time.

How easy is it to use? - RACE CONTROL has been developed over a period of nine months by a team of professional programmers before being released for sale. We think the program is foolproof. At every stage the user is guided through what needs to be done by either a menu system or a prompt line along the bottom of the screen. There is no need to remember any fancy key press combinations - full use of colour (or highlights if you are using a monochrome monitor) indicate which keys are valid at any particular time and - importantly - all other keys are locked out! One of the main requirements in the original specification was to ensure that even a non-computer-literate operator could use the program after going through the various procedures once or twice. Even if potentially catastrophic operations like deleting files are selected, confirmation is needed before the operation proceeds. RACE CONTROL's ease of use has been the most common comment passed by any one who has used RACE CONTROL during its development phase!

What if we find a bug? - We think we have found most of them - RACE CONTROL has been extensively tested both on the bench and at meetings during the pre-release development stage. If you do find an obscure bug which we have missed, please let us know - not only will you be eligible for a free upgrade but so will all other users just as soon as the bug is fixed.

What if it crashes? - We would prefer to answer that as a 'What if there's a power cut?' question! The worst possible scenario would be to crash whilst a race is under way. Nothing is stored to disc until the race is finished so the results of that race would be lost. Once the power comes back and RACE CONTROL loaded it is possible to continue racing without losing the results of any preceding race. This means only one race would need to be re-run.

What do I need to be able to run RACE CONTROL? - RACE CONTROL works on any PC/XT/AT or compatible running MS-DOS v2.0 or later. 512k RAM and a standard CENTRONICS parallel printer port is also needed. Colour monitor and hard disc are supported but RACE CONTROL works just as well, although a little slower, with a mono monitor and single floppy disc drive. The automatic version of RACE CONTROL requires the AMB 8800 Autocount system so a spare expansion slot is needed for the interface card. RACE CONTROL will even run on portables for outside meetings provided they possess the above facilities!

What sort of back-up is provided? - If you have any questions or comments ring either the suppliers or the programmers. You can then speak directly to the team who wrote **RACE CONTROL** and were involved with its production right from the start.

What if it doesn't quite do things the way I would like? - If you have any criticisms or suggestions for improvements then please let us know. Our policy is one of continual improvement and so we shall certainly consider any comments from end users for inclusion in future upgrades.

How can I find out more about **RACE CONTROL**? - Send for the **RACE CONTROL DEMO PACK**. This includes the full manual and documentation together with a demonstration disc containing a restricted manual input version of **RACE CONTROL**. The restrictions mean that a race can last a maximum of three minutes and there is a maximum of four cars per race. All other facilities of **RACE CONTROL** are there for you to try out. A small fee is made for the **RACE CONTROL DEMO PACK** but this is 100% refundable when you decide to place an order.

For initial enquiries and purchases, contact **RACE CONTROL** suppliers:

INTRONICS Control Systems
Unit 4 Bay Works
Marine Road
Pevensey Bay
East Sussex BN24 6EG
ENGLAND
Tel Int.+ 0323 763688

PRICE LIST

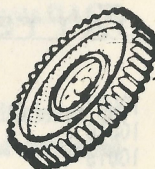
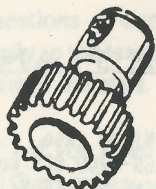
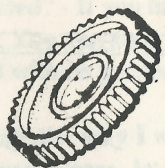
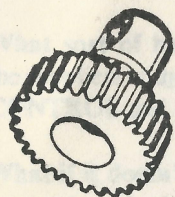
RACE CONTROL DEMO PACK	£10.00
RACE CONTROL (Manual input version)	£225.00
RACE CONTROL (Automatic version)	£275.00

Prices include carriage
U.K. Sales - please add VAT

RACE CONTROL software and all associated documentation (C) 1990
SM ENGINEERING Tel Int + 0323 766262
Specialists in Microprocessor Control and Data Logging Applications

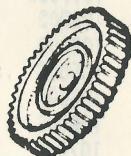
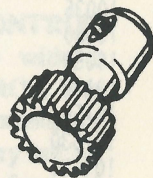
BATTERIES AND ACCESSORIES.

10009	Nicad case	7.99
10010	6N-1200 SCR Red cells	19.95
10015	6N-1200 SC Yellow cells	18.95
10020	N-1200 SCR single cell	2.95
10030	AA pcell	1.00
10030/R	Nicad pcell(rechargeable)	1.10
10035	SCR selected computer matched	15.00
10040	SC selected computer matched	15.00
10050	Soldering tags (20)	1.25
10100	RS gold plated conns 2m 2f	1.00
10150	Plug sets 7.2v	1.00
101630	Corally connector set 2m 10f	4.50
101631	Corally female batt conn 10f	2.00
101632	Corally fem wire conn+2m	4.50
101633	Corally fem wire conn 6f	2.25
101634	Corally male conn 3m	3.95
101708	SCE 1700 computer matched	37.50
1017065	SCR 1400 computer matched	39.95
10400D	Clear/blue double heatshrink	1.40
10500D	Black double heatshrink	1.40
10500S	Black double heatshrink	0.70
10600D	Red double heatshrink	1.40
10600S	Red single heatshrink	0.70
10700D	Yellow double heatshrink	1.40
10800D	Clear double heatshrink	1.40
10800S	Clear single heatshrink	0.70
10900D	White double heatshrink	1.40
10900	Small heatshrink	1.00
10900/R	Receiver heatshrink	1.00
101603	Torx 10 wrench	3.25
101245	Torx screw Cheesehead	1.95
101246	Torx screw Countersunk	1.95



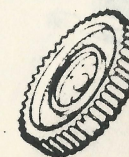
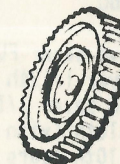
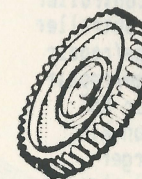
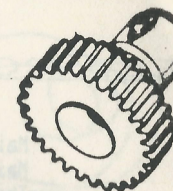
DU-MOR GEARS AND PINIONS.

06013	13th 48 DP Pinion Dumor	2.95
06014	14th 48 DP Pinion Dumor	2.95
06015	15th 48 DP Pinion Dumor	2.95
06016	16th 48 DP Pinion Dumor	2.95
06017	17th 48 DP Pinion Dumor	2.95
06018	18th 48 DP Pinion Dumor	2.95
06019	19th 48 DP Pinion Dumor	2.95
06020	20th 48 DP Pinion Dumor	2.95
06021	21th 48 DP Pinion Dumor	2.95
06023	23th 48 DP Pinion Dumor	2.95
06024	24th 48 DP Pinion Dumor	2.95
06025	25th 48 DP Pinion Dumor	2.95
06026	26th 48 DP Pinion Dumor	2.95
06078	78th 48 DP spur gear Dumor	3.50
06081	81th 48 DP spur gear Dumor	3.50
06086	86th 48 DP spur gear Dumor	3.50
06086/OPT	86th 48DP + gear adaptor	4.25
06090	90th 48 DP spur gear Dumor	3.50



CORALLY GEARS AND PINIONS.

007144	44th 32DP Gear PK	3,10
007146	46th 32DP Gear PK	3,10
007148	48th 32DP Gear PK	3,10
007150	50th 32DP Gear PK	3,10
007152	52th 32DP Gear PK	3,10
007153	53th 64DP 97 Gear PK	4,95
007154	54th 64DP 98 Gear PK	4,95
007155	55th 64DP 99 Gear PK	4,95
062201C	Pinion set mod ,5m PK	27,75
062202C	Pinion set standard ,5m PK	27,75
062203C	Pinion set complete ,5m PK	39,95
062214C	Pinion 0,5m 14th PK	3,95
062215C	Pinion 0,5m 15th PK	3,95
062216C	Pinion 0,5m 16th PK	3,95
062217C	Pinion 0,5m 17th PK	3,95
062218C	Pinion 0,5m 18th PK	3,95
062219C	Pinion 0,5m 19th PK	3,95
062220C	Pinion 0,5m 20th PK	3,95
062221C	Pinion 0,5m 21th PK	3,95
062222C	Pinion 0,5m 22th PK	3,95
062223C	Pinion 0,5m 23th PK	3,95
062224C	Pinion 0,5m 24th PK	3,95
062225C	Pinion 0,5m 25th PK	3,95
062226C	Pinion 0,5m 26th PK	3,95
062227C	Pinion 0,5m 27th PK	3,95
062228C	Pinion 0,5m 28th PK	3,95
062277C	77th 0,5m gear PK	3,95
062278C	78th 0,5m gear PK	3,95
062279C	79th 0,5m gear PK	3,95
062280C	80th 0,5m gear PK	3,95
062281C	81th 0,5m gear PK	3,95
062282C	82th 0,5m gear PK	3,95
062283C	83th 0,5m gear PK	3,95
062284C	84th 0,5m gear PK	3,95
062285C	85th 0,5m gear PK	3,95
062286C	86th 0,5m gear PK	3,95
062287C	87th 0,5m gear PK	3,95
062288C	88th 0,5m gear PK	3,95
062289C	89th 0,5m gear PK	3,95
062290C	90th 0,5m gear PK	3,95
062291C	91th 0,5m gear PK	3,95
062292C	92th 0,5m gear PK	3,95

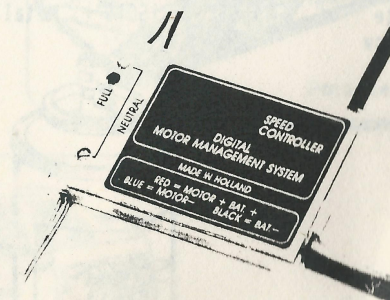
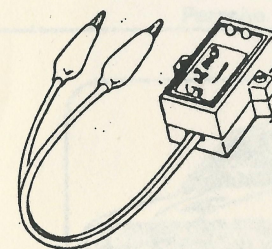
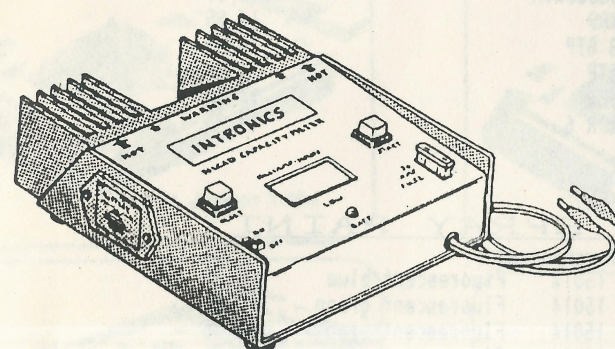
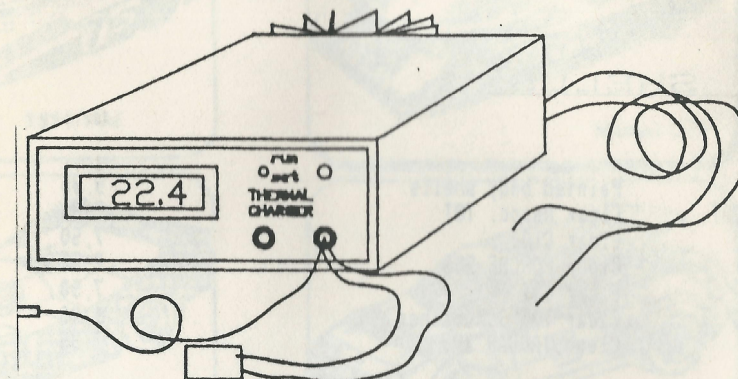


SPEED CONTROLLERS AND CHARGERS.

11000	Mains/12 volt power supply	29,95
11010	Mains/12v Thermal charger	89,95
11020	Thermal charger	44,95
11030	Basic Thermal charger	35,50
11040	Peak Detect charger + dvm	49,95
11050	Basic Peak Detect charger	29,95
12010	L,C,D,Digital Volt meter	23,95
12020	L,C,D,Digital Amp meter	27,50
12030	Nicad Capacity meter	74,95
13011	Firefly International + sw	52,45
13012	Firefly International Plus + sw	69,95
13040	Firefly Gizmo	4,95
1318012	PK 8 min speed controller	124,99
1318022	PK 4 min speed controller	124,99
1318012/R	PK 8 min exchange/repair	35,00
1318022/R	PK 4 min exchange/repair	35,00
131825	Cooling plate for MMS	4,95
133057	Glitch suppression kit	1,50
14100	2 hour fast charger	6,95
14100/P	Auto-cut pencil charger	6,95
14100/U	Universal fast charger	9,95

SERVO'S and ACCESSORIES.

13500	JR Apex Car Combo	173,00
13501	Crystals	6,95
14071/K	1/12 Kimbro servo saver FUTABA	
14072/K	Kimbro servo saver 1/12th	4,25
14072/S	Schumacher servo saver 1/10th 1/12th	2,30
14073/10	KO fet servo 1/10th (with steel gears)	75,00
14073/GEARS	KO fet servo 1/10th gears	
14073/12	KO fet servo 1/12th	69,95
14073/F	Futaba 128 servo	15,00
14075/12	132 High speed servo	35,00
14075/6	132 servo gears	1,25
14076	Tekin micro AM receiver	49,95
14077	40 Meg Futaba mini receiver	35,00



BODY SHELLS.

12th

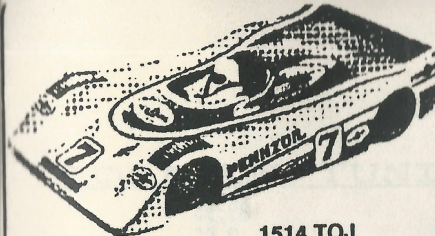
15010	Painted body shells	9,95
15011/ASS TOJ	Clear Assoc, TOJ	7,50
15011/C100	Clear C100	7,50
15011/P956	Clear PORCHE 956	7,50
15011/TOJ	Clear TOJ	7,50
15011/TOJ/S	Clear TOJ Schumacher	6,95
15011/JAG	Clear JAGUAR XR9	7,95

10TH

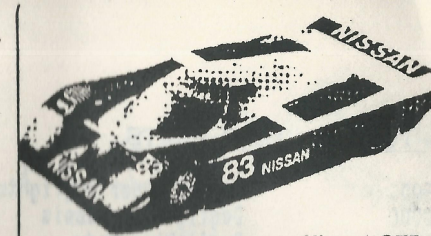
15012/BMW	Clear BMW	14,95
15012/S/C	Clear SIERRA COSWORTH	14,95
15012/JAG	Clear JAGUAR XR9	14,95
15012/MERC	Clear MERCEDES GTP	14,95
15012/NIS	Clear NISSAN GTP	14,95
15012/P962	Clear PORCHE 962	14,95
15012/JXJR	Clear JAGUAR XJR 6	14,95

CUSTOM COLUR SPRAY PAINT

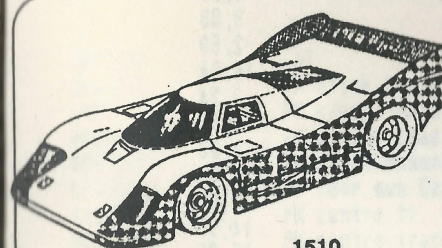
15013	Black	1,95	15014	Fluorescent blue	2,25
15013	Dark Blue	1,95	15014	Fluorescent green	2,25
15013	Green	1,95	15014	Fluorescent orange	2,25
15013	Light Blue	1,95	15014	Fluorescent pink	2,25
15013	Orange	1,95	15014	Fluorescent yellow	2,25
15013	Red	1,95	15015	Metallic blue	2,15
15013	Silver	1,95	15015	Metallic purple	2,15
15013	White	1,95	15015	Metallic red	2,15
15013	Yellow	1,95			



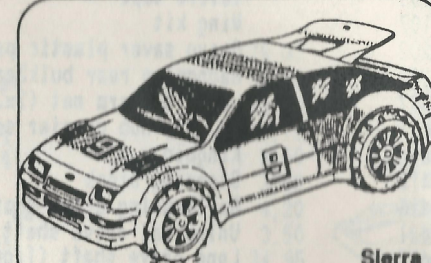
1514 TOJ



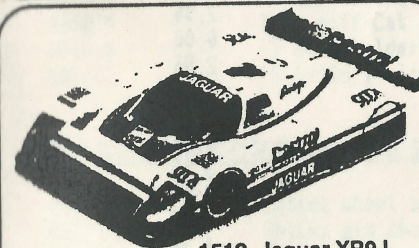
Nissan GTP



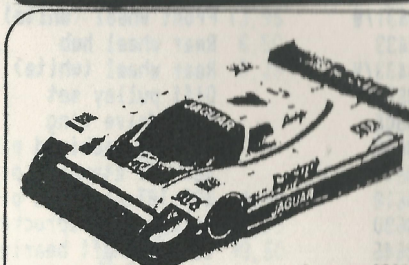
1510
Ford C100



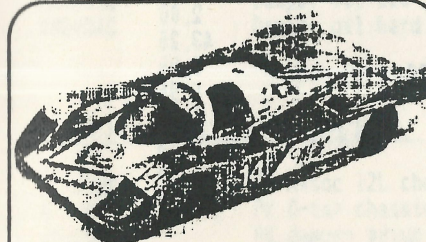
Sierra



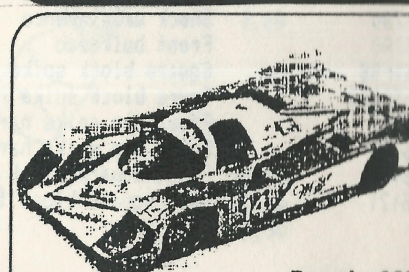
1512 Jaguar XR9J



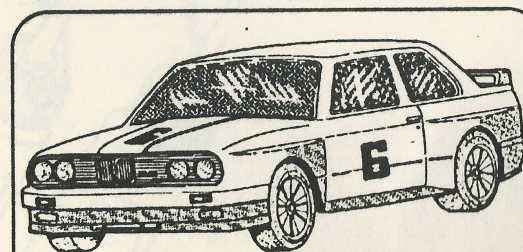
Jaguar XJ9



1511
Porsche 956



Porsche 962



1523 BMW M3

DOGFIGHTER SPARE PARTS.

0842900C	Yokomo Super Dogfighter	195,00
0843000C	Dogfighter chassis	39,95
0843101	Dogfighter body	7,95
0843102	Dogfighter undertray	7,95
0843105	Velcro tape	1,23
0843107	Wing kit	3,83
0843202	Servo saver plastic parts	2,50
0843302	Magnesium rear bulkhead	16,04
0843407	Lower sus-arm set (2x2)	3,24
0843413	Fr. St. hub carrier set	2,83
0843414	Kingpin x 4	1,23
0843415	Steering block	4,95
0843416	Ballbearing drive shaft	0,00
0843421	Universal drive shaft	14,95
0843422	Long drive shaft (front)	15,95
0843431	Front wheel hub	0,00
0843431/W	Front wheel (white)	2,95
0843433	Rear wheel hub	0,00
0843433/W	Rear wheel (white)	2,95
0843503	Diff pulley set	3,16
0843506	Diff drive ring	1,61
0843616	48P 16T machined pinion	3,16
0843617	48P 17T standard pinion	3,16
0843618	48P 18T machined pinion	3,16
0843630	Main gear & sprocket set	2,78
0843645	Centre shaft bearings	4,54
0843651	Front drive belt	3,89
0843656	Rear drive belt	2,78
0843730	Shock maintenance	2,00
0844100	Front bulkhead	43,25
0846TF9S	Square block spike front tyre	5,95
0846TR10S	Square block spike rear tyre	5,95
0846101	Front pin spike narrow	5,95
0846102	Front pin spike hard	5,95
0846105	Front square block tyre	5,95
0846121	Rear square block tyre med	5,95

CORALLY TUNING PARTS.

CAT TUNING PARTS.

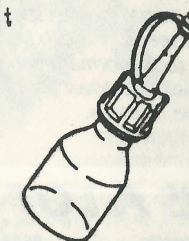
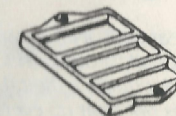
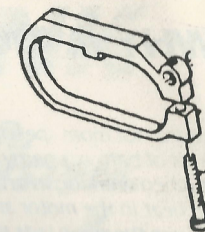
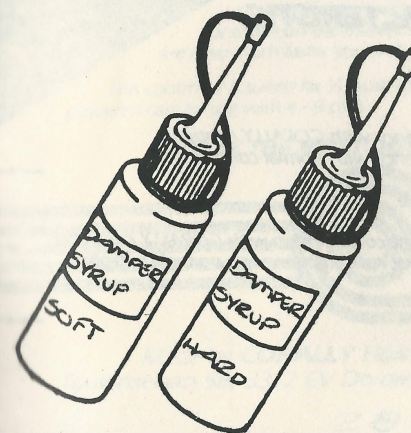
0842901	CAT	175,00
085001C	PK stick chassis kit Cat	39,95
0850011C	PK s/pack chas kit Cat	43,50
0850021C	PK s/pack chas, only Cat	28,75
085004C	PK shock absorb mnt Cat	3,50
0850051C	PK rear sus Cat wide	3,50
0850081C	PK centre tr, rod wide Cat	4,20
085008C	PK centre track rod Cat	3,50
085017	Cat drum/top axle kit	34,95
085018	PK top axle Cat	21,50
085019	Drum diff Cat	13,95
001618	PK batt holders set of 5	6,50
001616	PK battery clamps	3,25

BUGGY ACCESSORIES.

081001	Optima wheel adaptors	4,95
081992C	Optima mid chassis kit	29,95
067002C	1/10th Tweaker board	33,50
088002C	Damper oil soft	2,50
088003C	Damper oil med	2,50
088004C	Damper oil hard	2,50

12TH ACCESSORIES.

071990C	PK Assoc 12L chassis set	33,95
072002C	PK C-car chassis set	29,95
089000C	PK damper syrup	2,50



WHY A MOTOR MANAGING SYSTEM?

In the search for more speed, we realised that there are a lot of shortcomings in the conventional controllers. A lot of battery energy is wasted in the motor, because of the fact that the motor draws a lot of current when working in an area where the efficiency is very low, resulting in an enormous building up of heat in the motor and early dumping of the batteries.

Our first aim therefore was to solve this problem. To do so we developed a chip which allowed the controller to adjust the maximum current flowing through the motor, enough to give maximum torque, but not more, to save energy for the last minutes of the race.

The second point was to return the energy, the motor generates during braking, back to the battery. During braking the motor charges the battery at a pulse rate of 5000 Hz. It's not just the amount of energy that is important, but by doing so the efficiency of the battery is increased, resulting in more energy for the race itself.

A great deal of effort went into making the controller more efficient, not only at full throttle, but certainly at half throttle. This again was made possible by our own custom designed chip, which lets the controller utilize a digital system instead of the normal analogue mode. The result is a controller which does not heat up even under the most difficult circumstances.

The hybrid technology of the controller results in a very rigid and reliable controller, where failure is almost impossible providing the unit is connected to the battery correctly.

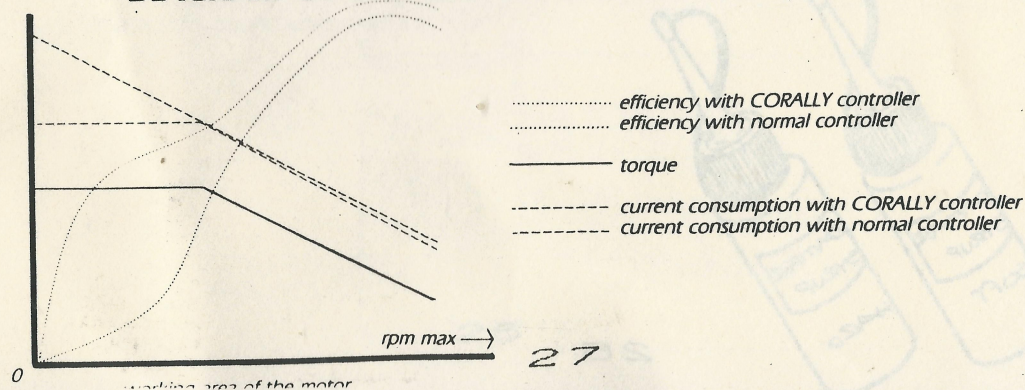
In using digital technology, connecting the controller to your radio equipment is simplified, as you only have to adjust the neutral position of the controller, the rest is always correct.

There are so many more functions built in in this device, that it does not deserve the name speed controller, but indeed really is a MOTOR MANAGING SYSTEM. There is also no need to trouble you with other technical specifications usually associated with speed controllers, as they have no bearing on this system. Just mount it into your car, and see how much faster you are. Not only in the first minute, but look at your lap times at the end of the race. Normally your lap times increase after approx. half a race. You will find now that if you are a consistent driver your lap times in the latter part of the race are only some tenth of a second slower than the first laps.

AND THAT MAKES A LOT OF DIFFERENCE!

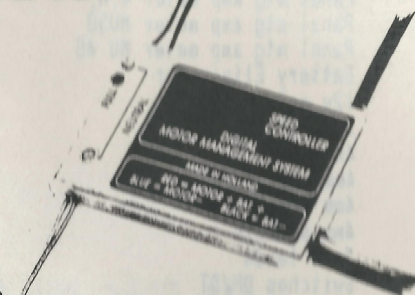


DIAGRAM OF THE MOTOR CHARACTERISTIC



THE MISSING LINK

CORALLY SPEED CONTROLLER. DIGITAL MOTOR MANAGEMENT SYSTEM.



ULTRA HIGH FREQUENCY OPERATION

- maximum efficiency of the motor
- keeps motor temperature down
- less sparking of the brushes
- less burning-in of the commutator
- less voltage drop between commutator and brushes

AUTOMATIC TORQUE OPTIMISER

- for maximum power at minimum current flow
- increases the efficiency of the motor
- no wasted peak-current of the battery results in longer running time and faster laps, especially in the last minute of the race.

FULL DIGITAL TECHNOLOGY

- extremely fast response and reliable operation

All these benefits are possible by the use of our own custom designed chip as heart of the controller. This gives a completely new dimension to the word "speed-controller".

The energy during braking is fed back to the battery, to enable the battery to give more power to the motor.
Extreme low volume and weight (13 grams for the controller only)

The operation of this controller is so unique, there is no use to compare the technical specifications with any other controller on the market. Just mount it in your car and see how much faster you are!

This controller is suited for $\frac{1}{16}$ scale as well as $\frac{1}{10}$ scale electric powered cars for use with 4 - 8 cells.

SQUEEZE THE MOST OUT OF YOUR MOTOR AND BATTERY



Made by **CORALLY** Holland. Distributed by
Toulonselaan 58, 3312 EV Dordrecht Holland, phone

INTRONICS

UNIT 4
BAY WORKS
MARINE ROAD
PEVENSEY BA1
EAST SUSSEX
BN24 6EQ

Tel (0323) 763688

GENERAL ACCESSORIES.

14096	Panel mtg amp meter s.h.	3,95
14097	Panel mtg amp meter MU38	5,95
14098	Panel mtg amp meter MU 45	6,50
14081	Battery Eliminator	2,50
14082	12v soldering iron	4,95
14083	240v soldering iron	4,95
14084/B	4mm plugs	0,35
14084/R	4mm plugs	0,35
14085/B	4mm sockets	0,30
14085/R	4mm sockets	0,30
14086	Test leads	1,50
14087	Switches DP/DT	1,45
14088	Switches SP/DT	1,15
14089	Switches kits for DVM	3,95
14090	Croc clips (small)	0,30
14091	Croc clips (large)	0,80
14094	50w Allyclad discharge res 1R	1,80
14094/2R	50w Allyclad discharge res 2R	1,95
14095	2,5w Discharge resistors 47R	0,70
15020	Superglue	0,95
15025	Allenscrew drivers 1,5m	1,95
15026	Allenscrew drivers 2,0m	1,95
15027	Allenscrew drivers 2,5m	1,95
15028	Allenscrew drivers 3/32	2,25
15030	Caliper gauge	2,95
15040/L	Cable ties 275mm	1,00
15040/S	Cable ties 90mm	1,20
15050	Body washers	0,50
15051	Elastic bands (6 per pkt)	0,50
15060	Snappy knives (pkt 3)	1,65
15061	Pozi drivers No. 0	2,95
15062	12 volt fans	9,95
15070	Balance weights (120g per pkt)	0,90
15102/M/L/XL	Corally T-shirt (medium, large, extra large)	7,95
159007	PK Corally sticker sheet	0,30
16000	Polybutler Pit Box	47,50
14066	Aerosol dust remover	3,25
14069	Fibre glass tape	2,50
14101	Digital tach	24,95
14102	Digital multimeter	35,00
14104	Digital stopwatch (individual lap times)	9,95
SER/C	Comm truing service	1,50

Intronics repair service,	Chargers	10,00
	Buggy + Fourfet speed controllers	10,00
	Internationals	12,50
	Internationals plus	15,00

The repair charge is subject to alteration if extensive damage occurs, you will then be notified by letter.

*** TERMS OF BUSINESS ***

PRICES ARE CURRENT AT TIME OF GOING TO PRESS AND ARE SUBJECT TO ALTERATION WITHOUT NOTICE. POSTAGE AND PACKING WILL BE CHARGED AT COST WITH A MINIMUM CHARGE OF £1,00.

*** SPECIFIC CONDITIONS OF SALE ***

ALL GOODS REMAIN THE PROPERTY OF INTRONICS UNTIL PAYMENT IS RECEIVED IN FULL,
INTRONICS, UNIT 4 BAY WORKS, MARINE ROAD, PEVENSEY BAY, EAST SUSSEX, BN24 6EG,
Tel (0323) 763688 Fax (0323) 763688.